

Plat of Survey

of

Lot 26 of the subdivision of Block 6 of Indian Hills,

located in the Southeast 1/4 of Section 14, Town 1 North, Range 16 East,
Village of Fontana-on-Geneva Lake, Walworth County, Wisconsin.

Surveyed for: **Tom & Laura Day**
731 Aweogon Road
Fontana, Wisconsin. 53125

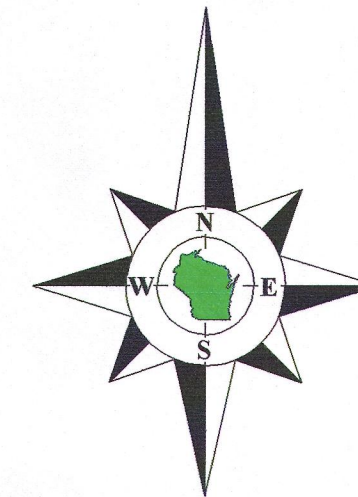

Bearings reference to the North line
of Lot 27, recorded as N87°30'E on
previous surveys of record.

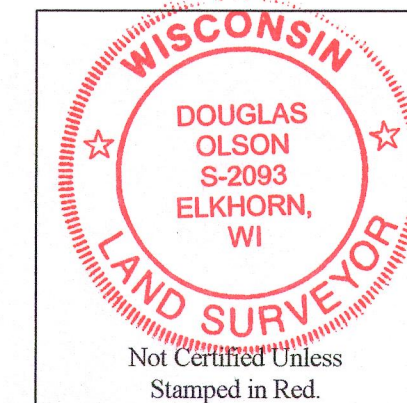

Notes:

- 1) This survey plat is not certified unless signed and sealed in red ink.
- 2) This survey is subject to Wisconsin lien laws. This Plat of Survey is the notice of intent to file lien. Lien waiver required.

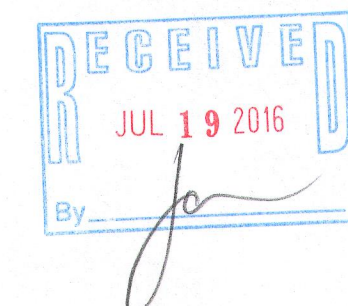

Copyright 2016 by Olson Land Surveying, LLC.

All rights reserved. No part of this survey plat may be reproduced or transmitted in any form by any means - graphic, electronic, or mechanical, including photocopying, tracing, or information storage and retrieval systems - without permission in writing from Douglas G. Olson, Olson Land Surveying, LLC.

I hereby certify that I have surveyed the above described property and the map hereon is correct to the best of my professional knowledge and belief and shows the size and location of the property, its exterior boundaries, the location and dimensions of all visible structures thereon, boundary fences, apparent easements and roadways and visible encroachments, if any.

This survey is made for the exclusive use of the present owners of the property, and also those who purchase, mortgage or guarantee title thereto, within one year from the date hereof.

Douglas G. Olson
Wisconsin Professional Land Surveyor - 2093

Survey Date: March 4, 2016.
Revisions:

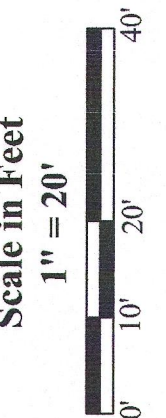

Olson Land Surveying, LLC



45 South Wisconsin Street * P.O. Box 322 * Elkhorn, Wisconsin. 53121
Telephone: (262) 723-3434 * Facsimile: (262) 723-8044
Email: doug@olsonsurveying.com

Legend
Found Iron Pipe
Found Iron Rod
Found Railroad Spike
Found Iron Rod
Found Information
Manhole
Utility Pole
Fire Hydrant
Asphalt Surface
Control Box
Pavers
Concrete

Sheet 1 of 1 Sheets

Job Reference Number
2016-010

2016.010

SIHB-18 005-3243