

PREPARED FOR
MARY BRENNAN
@ PROPERTIES
LAKE GENEVA, WI.

PLAT OF SURVEY

- OF -

LOT 2 BEAR TRAP RIDGE SUBDIVISION, LOCATED IN THE NW 1/4 AND THE SW 1/4 OF THE SE 1/4 OF SECTION 15, TOWN 1 NORTH, RANGE 16 EAST, VILLAGE OF FONTANA-ON-GENEVA LAKE, WALWORTH COUNTY, WISCONSIN.

PATHFINDER SURVEYING INC.
(formerly)
J.K. SURVEYING INC.
P.O. BOX 322
LAKE GENEVA, WI. 53147
WWW.PATHFINDERSURVEYING.NET
262-248-8303

THIS IRON WAS PREVIOUSLY
LOCATED, WATER WAS TO
DEEP TO ACCESS ON THE
DATE OF THIS SURVEY.

MAIN STREET

N 01°30'21" W 145.05'
N 01°30'21" W 201.78'
(N 01°30'59" W 201.76')
NO ACCESS
S 01°30'21" W 145.05'

S 05°10'41" W 166.54'

ZONING LINE

Lot 2
3.60 acres
156631.53 sq ft

N 75°14'47" E 829.29'
(N 75°15'29" E 829.08')

N 74°16'28" E 488.16'

300.00'

153.77'

63.00'

N 82°00'13" E 284.96'
(N 82°01'26" E 284.80')

133.80'

228.99'

25' SET BACK

50' SET BACK

BEAR TRAP LANE
OUTLOT 1, OWNED BY THE HOMEOWNERS
ASSOCIATION, IS AN ACCESS AND PRIVATE PARK
UTILITY EASEMENT AREA AND PRIVATE PARK

N 18°53'4" W 171.58'

50'

S 83°27'12" W 153.28'

S 28°15'01" W 141.20'

- () = recorded as
- = found iron bar
- = found iron pipe
- = set iron pipe
- = set iron bar

SCALE 1" = 50'

JOB # 15-285

TAX ID # SBTR 00002

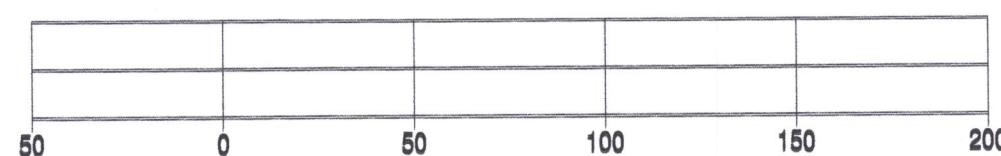
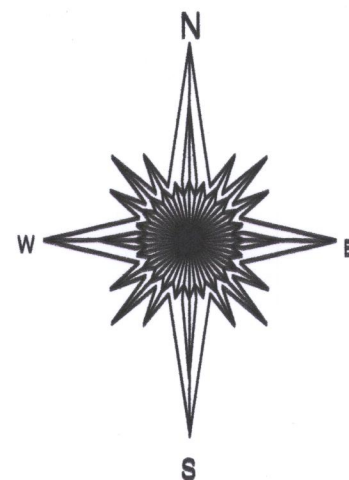

BASIS OF BEARING OF THIS PLAT: THE WISCONSIN STATE PLANE COORDINATE
SYSTEM SOUTH ZONE GRID NORTH, NAD 83 (2011). WISCORS.

"I hereby certify that I have surveyed the above described property and that the
above map is a true representation of its exterior boundaries and shows the size and
location of all visible structures, apparent easements and encroachments if any."
This survey is made for the present owners of the property, and those who
purchase, mortgage, or guarantee the title thereto, within one year from
the date hereof.

DATED THIS 8TH DAY OF JULY, 2015.

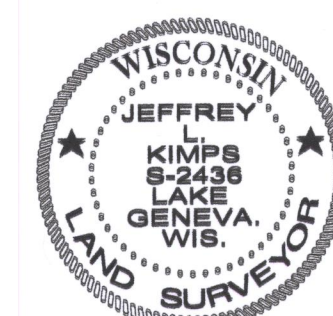
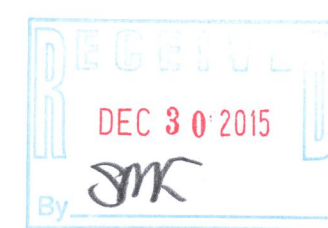

JEFFREY L. KIMPS - S - 2436
Wisconsin Registered Land Surveyor
(original if signed in red)

005-3185