

PREPARED FOR  
LUCAS FUKSA

PATHFINDER SURVEYING INC.  
(formerly)  
J.K. SURVEYING INC.  
P.O BOX 322  
LAKE GENEVA, WI. 53147  
WWW.PATHFINDERSURVEYING.NET  
262-248-8303

## AS BUILT SURVEY

- OF -

LOT 2 OF CERTIFIED SURVEY MAP No. 4505, BEING A REDIVISION OF LOT 18 COUNTRY CLUB ESTATES UNIT No. 1 AND PART OF A PRIVATE DRIVE , SAID LANDS BEING IN THE NE 1/4 OF THE SW 1/4 OF SECTION 14, TOWN 1 NORTH, RANGE 16 EAST, VILLAGE OF FONTANA - ON - GENEVA - LAKE, WALWORTH COUNTY, WISCONSIN.

LOT 19

SCALE 1" = 10'

JOB # 14-70ph

TAX ID #  
sa450500002

DATED THIS 1ST DAY OF JULY, 2015.

"I hereby certify that I have surveyed the above described property and that the above map is a true representation thereof and shows the size and location of all visible structures, apparent easements and encroachments if any."

This survey is made for the present owners of the property, and those who purchase, mortgage, or guarantee the title thereto, within one year from the date hereof.

DATED THIS 12TH DAY OF MAY, 2015.

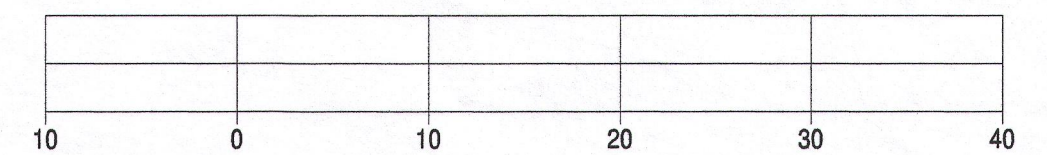
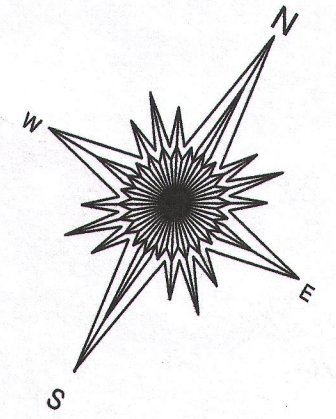

### BASIS OF BEARING OF THIS PLAT: THE CSM OF RECORD

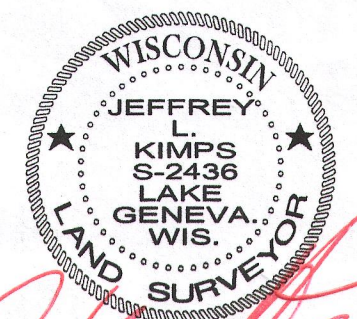
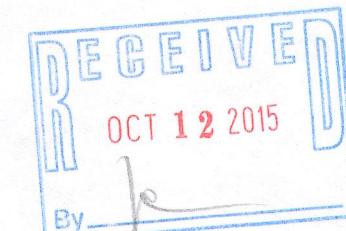

JEFFREY L KIMPS S - 2436  
Wisconsin Registered Land Surveyor  
( original if signed in red )

8A4505-2

605-3158