

RECEIVED  
SEP 24 2014  
By *[Signature]*

- LEGEND—
- = 1" X 18" IRON PIPE SET
  - = 6" NAIL SET
  - ⊙ = COUNTY MONUMENT FOUND
  - ⊠ = ELECTRIC TRANSFORMER
  - ⊞ = ELECTRIC METER
  - ⊡ = FIBER OPTIC VAULT
  - ⊕ = GAS METER
  - ⊛ = LIGHT POLE
  - ⊙ = FIRE HYDRANT
  - ⊞ = WELL HEAD
  - ⊡ = METAL POST
  - ⊕ = DOOR
  - G- = BURIED GAS
  - T/E- = BURIED ELEC. & TELE.
  - T- = BURIED TELEPHONE
  - E- = BURIED ELECTRIC
  - - - = PROPERTY LINE
  - ☼ = EXISTING ARBORVITAE TREE
  - ☺ = EXISTING TREE

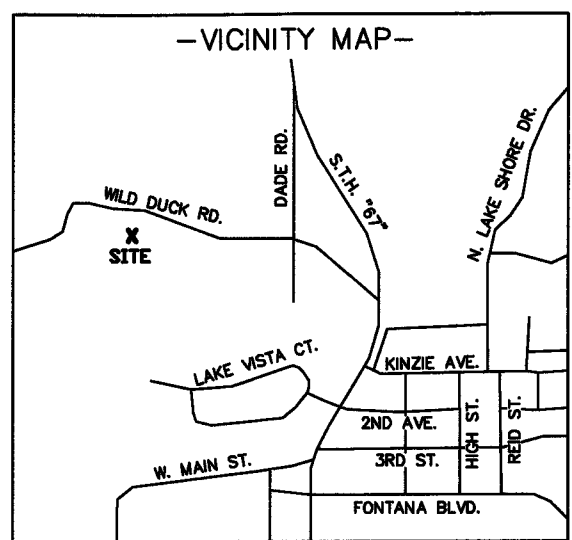

**EXISTING TOWER BASE**  
LATITUDE: 42°-33'-11.41"  
LONGITUDE: 88°-35'-02.70"  
(Per North American Datum of 83/91)  
Top of Antenna Elevation: 1298.7'  
(Highest Point)  
Top of Tower Elevation: 1296.0'  
Ground Elevation: 1042.2'  
(Per North American Vertical Datum of 1988)

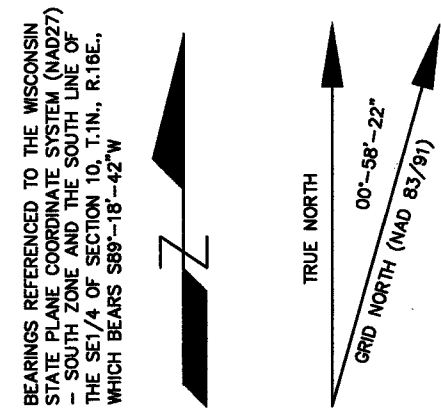

SURVEYED FOR:

**TERRA**  
CONSULTING GROUP, LTD.

600 Busse Highway  
Park Ridge, IL 60068  
OFFICE: (847) 698-8400  
FAX: (878) 444-4472

SURVEYED FOR:

**verizon**wireless

1515 WOODFIELD ROAD  
SUITE 1400  
SCHAUMBURG, IL 60173

**MERIDIAN**  
SURVEYING, LLC

NB774 Firelane 1 Menasha, WI 54952  
Office: 920-993-0881  
Fax: 920-273-8037

SITE NAME: **FONTANA MACRO**

SITE NUMBER: **211056**

SITE ADDRESS: **300 WILD DUCK RD. FONTANA, WI 53125**

PROPERTY/TOWER OWNER:  
VILLAGE OF FONTANA  
ON GENEVA LAKE  
175 VALLEY VIEW DR.  
FONTANA, WI 53125

PARCEL NO.:  
SUP 00006A

ZONED: MUNICIPAL

DEED: DOCUMENT NO. 795282

**LEASE EXHIBIT**  
FOR  
VERIZON WIRELESS PERSONAL  
COMMUNICATIONS LP d/b/a VERIZON WIRELESS  
BEING A PART OF THE SE1/4 OF THE SE1/4,  
SECTION 10, T.1N., R.16E., VILLAGE OF  
FONTANA ON GENEVA LAKE,  
WALWORTH COUNTY, WISCONSIN

NO.	DATE	DESCRIPTION	BY
4	7/10/14	Added Lease Parcel	J.D.
3	4/22/14	Expanded Survey	J.B.
2	4/11/14	Added Title Report	J.B.
1	4/4/13	Preliminary Survey	J.B.

DRAWN BY: **J.B.** FIELD WORK DATE: **4-2-13**

CHECKED BY: **S.C.D.** FIELD BOOK: **M-26, PG. 42**

JOB NO.: **7152-B1345** SHEET **1** OF **5**

I, Steven C. DeJong, hereby certify that none of the property described hereon is within a flood plain as defined by FEMA.

**SURVEYOR'S CERTIFICATE**

I, Steven C. DeJong, Professional Land Surveyor of Meridian Surveying, LLC., certify that I have surveyed the described property and that the map shown is a true and accurate representation thereof to the best of my knowledge and belief.

Dated this **2ND** day of **SEPTEMBER** 2014.

*[Signature]*

WISCONSIN PROFESSIONAL LAND SURVEYOR  
Steven C. DeJong, S-2791

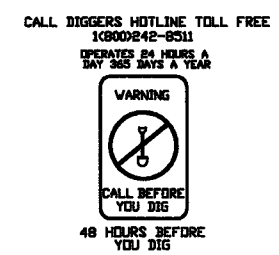
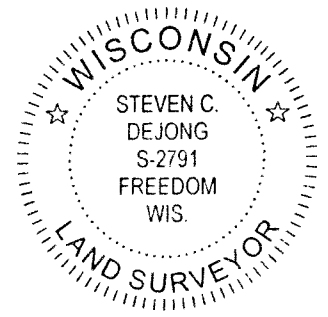

**SURVEY NOTES:**

—THE LOCATION OF THE EXISTING UTILITIES, AS SHOWN ON THIS PLAN, ARE APPROXIMATE ONLY. IT SHALL BE THE RESPONSIBILITY OF THE CONTRACTOR TO VERIFY ACTUAL LOCATION AND DEPTH OF ALL EXISTING UTILITIES. THE OWNER AND THE SURVEYOR SHALL NOT BE RESPONSIBLE FOR ANY OMISSION OR VARIATION FROM THE LOCATION SHOWN.

—THIS IS NOT A BOUNDARY SURVEY OF THE PARENT PARCEL. THIS SURVEY REPRESENTS THE LEASE AREA AND EASEMENTS ONLY.

SUP-6A

005-3067