

**BOUNDARY & TOPOGRAPHIC MAPPING
SITE GRADING, DRAINAGE, &
EROSION CONTROL PLAN**

UNIT 3 OF WESTGATE CONDOMINIUM
LOCATED IN THE SW 1/4 OF THE NE 1/4 SECTION 13
TOWN 1 NORTH, RANGE 16 EAST
VILLAGE OF FONTANA-ON-GENEVA LAKE
WALWORTH COUNTY, WI.



- LEGEND**
- = FOUND IRON PIPE STAKE
 - = FOUND IRON REBAR STAKE
 - ⊙ = LIGHT POLE
 - (XXX) = RECORDED AS

NOTE: COPIES OF THIS MAP TO WHICH THE FOLLOWING CERTIFICATE WILL APPLY SHOW THE SURVEYOR'S ORIGINAL SEAL AND SIGNATURE IN RED INK. COPIES BY ANY OTHER MEANS MAY HAVE ALTERATIONS WHICH DO NOT REPRESENT THE SURVEYOR'S WORK PRODUCT.

I HEREBY CERTIFY THAT THE ABOVE DESCRIBED PROPERTY HAS BEEN SURVEYED UNDER MY DIRECTION AND THAT THE ABOVE MAP IS A TRUE REPRESENTATION THEREOF AND SHOWS THE SIZE AND LOCATION OF THE PROPERTY AND ITS EXTERIOR BOUNDARIES. THIS SURVEY IS MADE FOR THE USE OF THE PRESENT OWNERS OF THE PROPERTY, AND ALSO THOSE WHO PURCHASE, MORTGAGE, OR GUARANTEE THE TITLE THERETO WITHIN ONE YEAR FROM THE DATE HEREOF.

DATED: MARCH 20, 2013

REVISED 7/31/2013-KB
TO SHOW SIZE & LOCATION
OF AS-BUILT FOUNDATION

Peter S. Gordon
PETER S. GORDON R.L.S. 2101

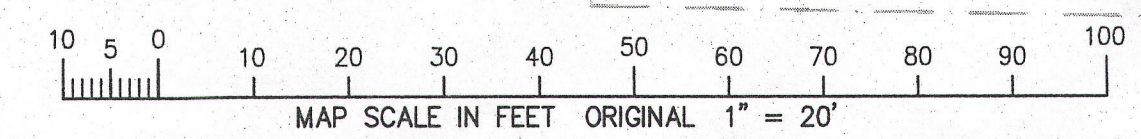
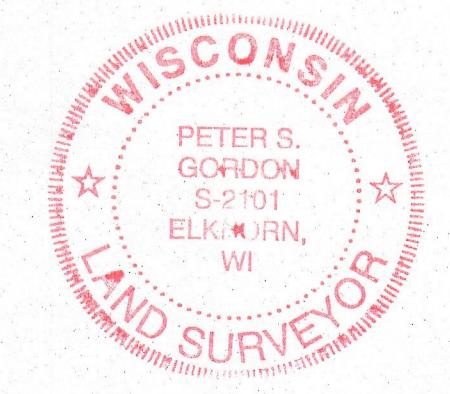
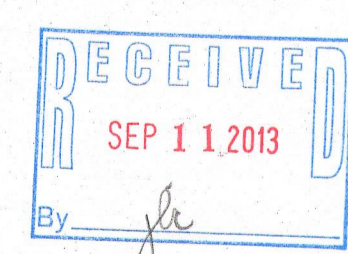

SOUTH LAKESHORE DRIVE

66' WDE

FARRIS, HANSEN & ASSOCIATES, INC.
ENGINEERING - ARCHITECTURE - SURVEYING
7 RIDGWAY COURT P.O. BOX 437
ELKHORN, WISCONSIN 53121
OFFICE: (262) 723-2098 FAX: (262) 723-5886

REVISIONS
5/22/2013-KB
ADD ADDITIONAL
TOPOGRAPHIC
INFORMATION BY
UNIT 2

PROJECT NO.
8757
DATE
3/13/2013
SHEET NO.
1 OF 1

SWES -3

005-2996

JUL 31 2013

7/31/2013 K:\Projects\8957\000\AS-BUILT_20130731