

**BOUNDARY & TOPOGRAPHIC MAPPING  
SITE GRADING, DRAINAGE, &  
EROSION CONTROL PLAN**

**UNIT 3 OF WESTGATE CONDOMINIUM**

LOCATED IN THE SW 1/4 OF THE NE 1/4 SECTION 13  
TOWN 1 NORTH, RANGE 16 EAST  
VILLAGE OF FONTANA-ON-GENEVA LAKE  
WALWORTH COUNTY, WI.

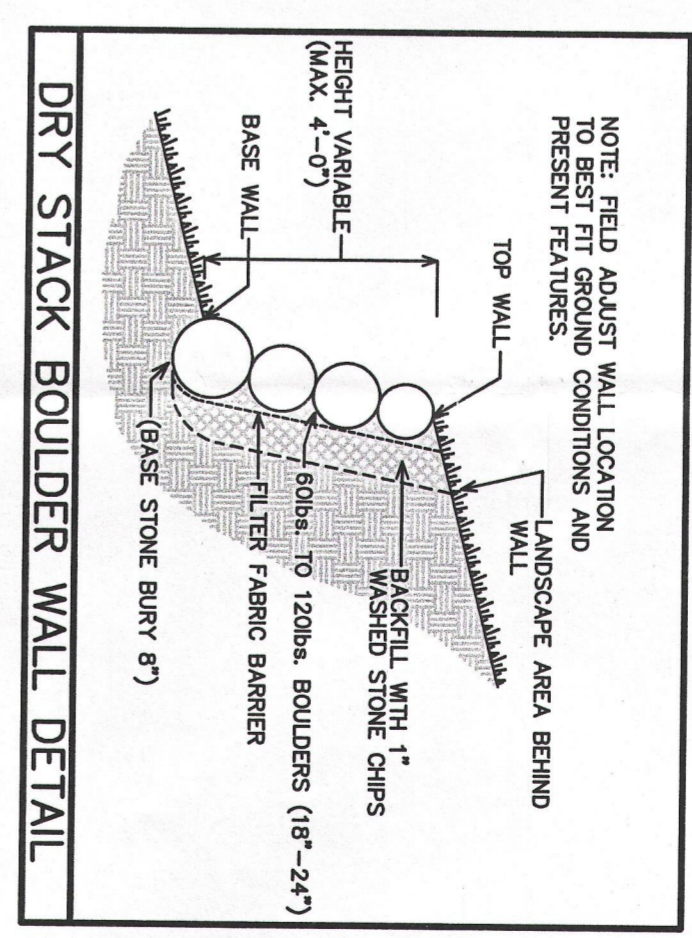

**CONSTRUCTION SEQUENCE**

- 1) SILT FENCING INSTALLED
- 2) TOPSOIL STRIPPED
- 3) FOUNDATIONS DIG & POURED
- 4) FRAMING & ROOF CONSTRUCTION COMPLETED
- 5) DRIVE CONSTRUCTION & LANDSCAPING COMPLETED
- 6) AREA TO BE RESTORED WITH TOPSOIL AS SOON AFTER FOUNDATION AND FRAMING AS POSSIBLE FOLLOWED WITH GRASS SEEDING AND MULCH.
- 7) AREA WITHIN AND AROUND UNIT TO BE CELEBRATED OR UNDERGROWN WITH ONLY NECESSARY DAMAGE TREES REMOVED.

NOTE: ALL SILT FENCING SHALL BE MAINTAINED IN A STABLE CONDITION FULLY BRACKETED AND STAKED TO PREVENT MOVEMENT BY RUNOFF UNTIL A STORM EVENT OCCURS. THE STAKES SHALL BE CHECKED AFTER EVERY STORM. THEY SHALL BE CHECKED AND ANY OTHER CONSTRUCTION DEBRIS SHALL BE ROUTINELY REMOVED.

**TOTAL LAND DISTURBANCE = 30,000 S.F.**

- LEGEND**
- = FOUND IRON PIPE STAKE
  - = FOUND IRON REBAR STAKE
  - ⊕ = LIGHT POLE
  - (XXX) = RECORDED AS
  - = EXISTING LAND CONTOURS
  - = PROPOSED FINISHED GROUND GRADE
  - = PROPOSED FINISHED PAVEMENT GRADE

NOTE: COPIES OF THIS MAP TO WHICH THE FOLLOWING CERTIFICATE IN RED INK COMES BY ANY OTHER MEANS MAY HAVE ALTERATIONS WHICH DO NOT REPRESENT THE SURVEYOR'S WORK PRODUCT.

I HEREBY CERTIFY THAT THE ABOVE DESCRIBED PROPERTY HAS BEEN SURVEYED UNDER MY DIRECTION AND THAT THE ABOVE MAP IS A TRUE AND CORRECT REPRESENTATION OF THE PROPERTY AND ITS EXTENT AND LOCATION OF THE PROPERTY AND ITS EXISTING BOUNDARIES AND ADJACENT PROPERTY AS SHOWN BY RECORDS, MEASUREMENTS, OR OTHERWISE THE TITLE THEREOF WITHIN ONE (1) YEAR FROM THE DATE HEREOF.

DATED: MARCH 20, 2013

PETER S. GORDON, F.L.S., S.D.

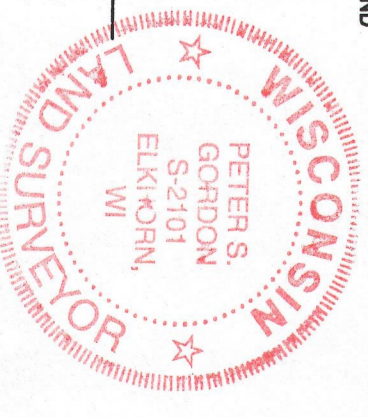

RECEIVED  
APR 2 2 2013

	<p><b>FARRIS, HANSEN &amp; ASSOCIATES, INC.</b> ENGINEERING - ARCHITECTURE - SURVEYING 7 RIDGWAY COURT P.O. BOX 437 ELKHORN, WISCONSIN 53121 OFFICE: (262) 723-2098 FAX: (262) 723-5886</p>	<p>REVISIONS</p>	<p>DATE: 3/13/2013 PROJECT NO. 8757 SHEET NO. 1 OF 1</p>
--	---	------------------	--