

PREPARED FOR
MATUSTIK BUILDERS
2413 ALGONQUIN RD
SUITE 515
ALGONQUIN IL. 60102

PLAT OF SURVEY

-OF-

KROTT SURVEYING INC.

N3705 WILLOW BEND LANE
LAKE GENEVA WI. 53147
PHONE # (262)248-3697
FAX # (262)249-0639

LOTS 65 AND 66 IN BUENA VISTA SUBDIVISION A SUBDIVISION OF PART OF THE
SOUTHWEST 1/4 OF SECTION 11 AND PART OF THE NORTHWEST 1/4 OF SECTION 14,
TOWN 1 NORTH, RANGE 16 EAST, VILLAGE OF FONTANA, WALWORTH COUNTY, WISCONSIN.

HIGHEST POINT ADJACENT TO
STRUCTURE = 200.9

LOWEST POINT ADJACENT TO
STRUCTURE = 196.6

AVERAGE GRADE = 198.75

MIDPOINT OF EXISTING
STRUCTURE = 227.0

NORTH LAKE SHORE DRIVE

(WIDTH VARIES)

$R=30.00'$ $L=21.01'$
 $LC=20.58'$ $LCB=N 47^{\circ}16'43'' E$
($LC=21'$ $LCB=N 45^{\circ} E$)

SPRING STREET

(50' WIDE)

CONCRETE AND STONE WALL

$S 86^{\circ}00'00'' E$

($S 86^{\circ} E 85.00'$)

84.88'

189.86'

HIGHEST ADJACENT
GRADE ELV.=200.9

ELV. OF
EAVE =220.9

ELV. OF
PEAK = 233.1

EXISTING
HOUSE UNDER
CONSTRUCTION

ASPHALT DRIVE

EXISTING HOUSE

LOT 67

LOT 65

LOT 66

EXISTING
SHED

$N 85^{\circ}57'55'' W$

(100')

99.82'

49.92' (50')

STEEL FENCE

TENNIS COURT

LEGEND

○ FOUND IRON PIPE

⊙ GAS METER

⊙ GAS MARKER

⊙ ELECTRIC METER

⊘ UTILITY POLE

— OVERHEAD WIRES

⊙ DECIDUOUS TREE

⊙ FIRE HYDRANT

(XX) RECORDED AS

TAX ID # SBV00045

JOB # 12-133AB

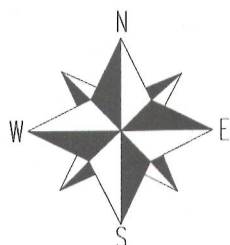

SCALE 1" = 20'



NOTE: BEARINGS ARE REFERENCED TO THE RECORD PLAT
NOTE: ELEVATIONS ARE ASSUMED.

I have surveyed the above-described property and the above map is
a true representation thereof and shows the size and location of the
property, its exterior boundaries, the location and dimensions of all
structures thereon, fences apparent easements and roadways and
visible encroachments, if any.

This survey is made for the exclusive use of the present owners of
the property, and also those who purchase, mortgage, or insure the
title thereto within one (1) year from date hereof; and as to them I
warrant the accuracy of said survey map.

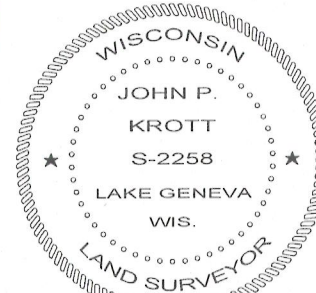
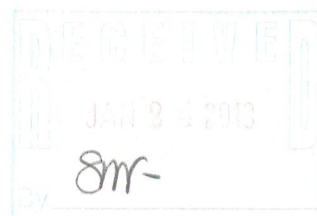

DATED THIS 4th DAY OF OCTOBER 2012
DATE OF LAST REVISION: 01/07/2012
REVISED 12/04/2012

John P. Krott

JOHN KROTT S - 2258
Wisconsin Registered Land Surveyor
(original if signed in red)

005-2959