

# Plat of Survey

of

## Lot 26 of the subdivision of Block 6 of Indian Hills,

located in the Southeast 1/4 of Section 14, Town 1 North, Range 16 East,  
Village of Fontana-on-Geneva Lake, Walworth County, Wisconsin.

Surveyed for: **Tom & Laura Day**  
442 Harvard Avenue  
Fontana, Wisconsin. 53125

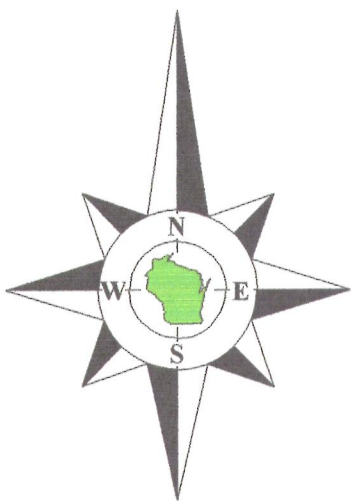

Bearings reference to the North line  
of Lot 27, recorded as N87°30'E on  
previous surveys of record.

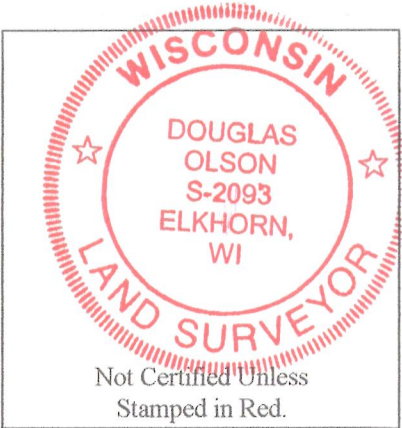

### Notes:

- 1) This survey plat is not certified unless signed and sealed in red ink.
- 2) This survey is subject to Wisconsin lien laws. This Plat of Survey is the notice of intent to file lien. Lien waiver required.

Copyright 2010 by Jensen & Olson Land Surveying, LLC.

All rights reserved. No part of this survey plat may be reproduced or transmitted in any form by any means - graphic, electronic, or mechanical, including photocopying, tracing, or information storage and retrieval systems - without permission in writing from Douglas G. Olson, Jensen & Olson Land Surveying, LLC.

I hereby certify that I have surveyed the above described property and the map hereon is correct to the best of my professional knowledge and belief and shows the size and location of the property, its exterior boundaries, the location and dimensions of all visible structures thereon, boundary fences, apparent easements and roadways and visible encroachments, if any.

This survey is made for the exclusive use of the present owners of the property, and also those who purchase, mortgage or guarantee title thereto, within one year from the date hereof.

Douglas G. Olson  
Wisconsin Registered Land Surveyor - 2093



Survey Date: May 18, 2010.  
Revisions: No. 1 - Proposed house, entry porch, deck & stairs  
No. 2 - Concrete Foundation  
No. 3 - Building Height

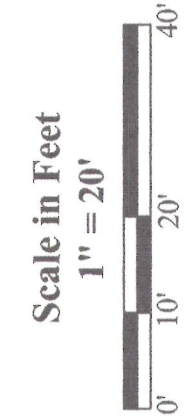

**Jensen & Olson Land Surveying, LLC**  
45 South Wisconsin Street \* P.O. Box 322 \* Elkhorn, Wisconsin. 53121  
Telephone: (262) 723-3434 \* Facsimile: (262) 723-8044  
Email: jensen.olson@elknet.net

Legend	
Found Iron Pipe	Spot Elevation
Found Iron Rod	Found Railroad Spike
Found Railroad Spike	Found Information
Found Information	Utility Pole
Utility Pole	Fire Hydrant
Fire Hydrant	Asphalt Surface
Asphalt Surface	Control Box
Control Box	PVC Pipe
PVC Pipe	Concrete
Concrete	

Sheet 1 of 1 Sheets  
Job Reference Number  
**2011.064**

2011.064

SIHB-18

005-2931