

Tarrant Drive
(50' Wide)

(N84°21'48"E)
49.98'
(50.00')

(N5°33'W 138.00')
138.05'
97.23'

44.86'
85.11'
S5°41'02"E 129.97'
(S5°33'E 130.00')

Tax Parcel
STFV 00154

Tax Parcel
STFV 00155

(S79°30'E 171.71')
S79°43'32"E 171.51'
95.60'

(N75°11'27"E 50.71')
N75°11'27"E 50.71'

59.35'
78.47'
S12°40'00"E 168.20'
(S12°40'E 168.18')

Tax Parcel
STFV 00150D

Tax Parcel
STFV 00151

Tax Parcel
STFV 00150C

Lot 1

Lot 145

Lot 144

Lot 143

Property Exhibit

of
Points set along the property lines

of
Tax Parcel STFV 00150C,

being part of Outlot 101 of the Assessor's Plat of the Village of Fontana-on-Geneva Lake, located in the Southwest 1/4 of Section 14, Town 1 North, Range 16 East, Village of Fontana-on-Geneva Lake, Walworth County, Wisconsin.

Prepared for: **Jess Lobdell**
839 Tarrant Drive
Fontana, Wisconsin. 53125

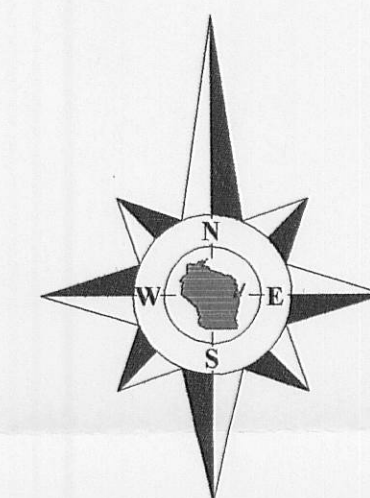

Bearings referenced to previous surveys of record.

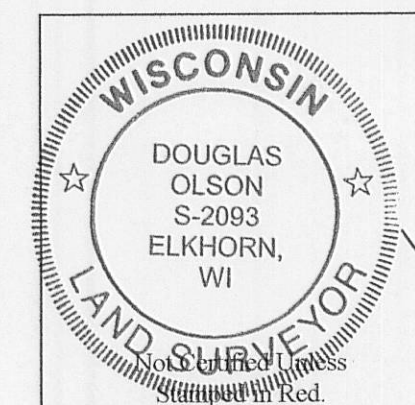

Notes:

- 1) This survey plat is not certified unless signed and sealed in red ink.
- 2) This survey is subject to Wisconsin lien laws. This Plat of Survey is the notice of intent to file lien. Lien waiver required.

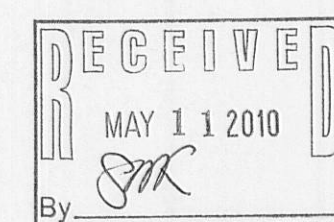

Copyright 2010 by Jensen & Olson Land Surveying, LLC.

All rights reserved. No part of this survey plat may be reproduced or transmitted in any form by any means - graphic, electronic, or mechanical, including photocopying, tracing, or information storage and retrieval systems - without permission in writing from Douglas G. Olson, Jensen & Olson Land Surveying, LLC.

Survey Date: March 31, 2010.
Revisions:

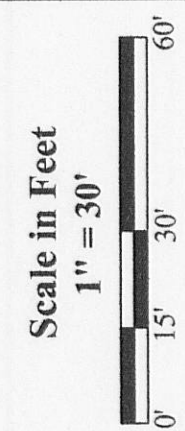

Jensen & Olson Land Surveying, LLC
45 South Wisconsin Street * P.O. Box 322 * Elkhorn, Wisconsin. 53121
Telephone: (262) 723-3434 * Facsimile: (262) 723-8044
Email: jensen.olson@elknet.net

Legend
Found Iron Pipe
Found Iron Rod
Found P.K. Nail
Set Iron Rod, 3/4" dia.
Recorded Information

Sheet 1 of 1 Sheets
Drawing Name: tarr[6c-2009]14-2009114-exhibit.aug
Job Reference Number
2009.114

2009.114