

WORK ORDERED BY:
FRONTIER FLOWERS
RENEE CERNY
104 W. MAIN STREET
FONTANA, WI. 53125

FARRIS, HANSEN & ASSOCIATES, INC.
ENGINEERING - ARCHITECTURE - SURVEYING
7 RIDGWAY COURT P.O. BOX 437
ELKHORN, WISCONSIN 53121
OFFICE: (262) 723-2098 FAX: (262) 723-5866

REVISIONS

PROJECT NO.
8053

DATE
12/18/2009

SHEET NO.
1 OF 1

PLAT OF SURVEY

LOT 5 OF BLOCK 3, ASSESSOR'S PLAT NO. 1
EXCEPTING THEREFROM THE NORTH 20 FEET OF LOT 5
C.L. DOUGLASS ADDITION TO THE VILLAGE OF FONTANA
LOCATED IN THE SE 1/4 OF THE NE 1/4 SECTION 15
TOWN 1 NORTH, RANGE 16 EAST
VILLAGE OF FONTANA-ON-GENEVA LAKE
WALWORTH COUNTY, WI.

CATCH BASIN/MANHOLE

ASSIGNED SOUTH LINE LOT 5
S 89°40'46" W

MILL STREET
48.5' WIDE

STORM INLET

SANITARY MANHOLE

LEGEND
○ = FOUND IRON PIPE STAKE
● = FOUND IRON REBAR STAKE
▲ = FOUND PK NAIL
(xxx) = RECORDED AS

LEGAL DESCRIPTION

Lot Five (5), Block Three (3) all in the Assessor's Plat No. 1, C.L. Douglass Addition to the Village of Fontana, Walworth County, Wisconsin as recorded in Volume 11 of Plats on Pages 1, 2 and 3, recorded October 19, 1962. EXCEPTING THEREFROM the North Twenty (20) feet thereof.

Tax Key No. STFV 00199A

NOTE: ACCESS EASEMENT RECORDED IN VOL. 509, ON PAGE 395 AS DOC. 488959
BENEFITS BOTH ABUTTING PARCELS.

NOTE: COPIES OF THIS MAP TO WHICH THE FOLLOWING CERTIFICATE WILL APPLY SHOW SURVEYOR'S ORIGINAL
SEAL AND SIGNATURE IN RED INK. COPIES BY ANY OTHER MEANS MAY HAVE ALTERATIONS WHICH DO NOT
REPRESENT THE SURVEYOR'S WORK PRODUCT.

I HEREBY CERTIFY THAT THE ABOVE DESCRIBED PROPERTY HAS BEEN SURVEYED UNDER MY DIRECTION AND THAT
THE ABOVE MAP IS A TRUE REPRESENTATION THEREOF AND SHOWS THE SIZE AND LOCATION OF THE PROPERTY, ITS
EXTERIOR BOUNDARIES, THE LOCATION OF ALL VISIBLE STRUCTURES, AND DIMENSIONS OF ALL PRINCIPLE
BUILDINGS THEREON, BOUNDARY FENCES, APPARENT EASEMENTS, ROADWAYS, AND VISIBLE ENCROACHMENTS, IF
ANY. THIS SURVEY IS MADE FOR THE USE OF THE PRESENT OWNERS OF THE PROPERTY, AND ALSO THOSE WHO
PURCHASE, MORTGAGE, OR GUARANTEE THE TITLE THERETO WITHIN ONE YEAR FROM THE DATE HEREOF.

DATED: JANUARY 19, 2010

PETER S. GORDON R.L.S. 2101

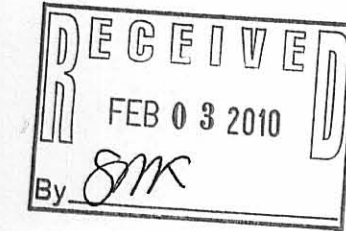
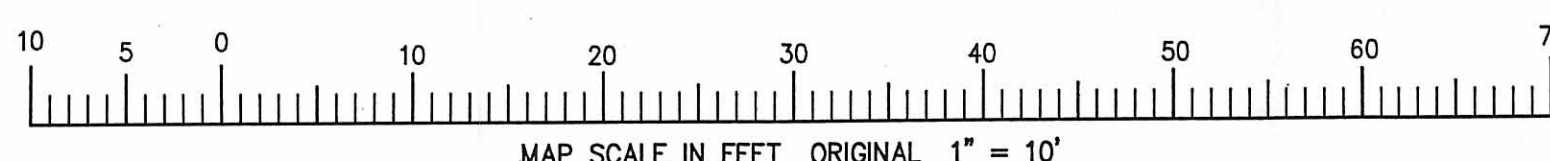
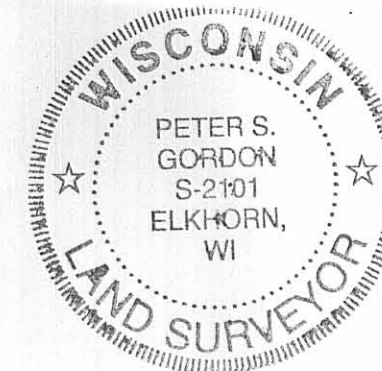

1/19/2010 X:\Projects\6033\docs\Survey

STFV - 199A

005-2712