



WORK ORDERED BY -
CRAIG WORKMAN
FONTANA HOLDING CO.
FONTANA, WI 53125

FARRIS, HANSEN & ASSOCIATES, INC.
ENGINEERING - ARCHITECTURE - SURVEYING
7 RIDGWAY COURT P.O. BOX 437
ELKHORN, WISCONSIN 53121
OFFICE: (262) 723-2098 FAX: (262) 723-5886

REVISIONS
10/13/2006 -
TO SHOW SIZE
AND LOCATION
OF AS-BUILT
FOUNDATION

PROJECT NO.
5269.05
DATE:
05/23/06
SHEET NO.
1 OF 1

PLAT OF SURVEY

LOT 2 OF CERTIFIED SURVEY MAP 3902
RECORDED IN VOL. 24 OF C.S.M.'S ON PG. 1 AS DOC. NO. 668628
LOCATED IN PART OF THE SW 1/4 OF THE NW 1/4 OF SECTION 11,
TOWN 1 NORTH, RANGE 16 EAST, TOWN OF WALWORTH, WALWORTH COUNTY, WISCONSIN

GRID NORTH
WISCONSIN STATE PLANE COORDINATE SYSTEM - SOUTH ZONE
ASSIGNED W. LINE OF THE NW 1/4
SECTION 11-1-16
S 01°55'30" E

| LINE | BEARING | DISTANCE |
|------|---------------|----------|
| L1 | N 01°11'50" E | 43.69' |

LOT 1 - C.S.M. 3460

LOT 3 - C.S.M. 3902

PARCEL A - C.S.M. 963

FONTANA ON GENEVA
LAKE ASSESSORS PLAT

LOT 2
186,617 S.F.
4.28 AC.

PRIMARY ENVIRONMENT
CORRIDOR LINE

WILLOW BEND ROAD

40' WIDE R.O.W. RESERVATION

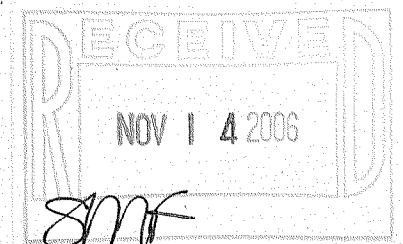

LEGEND
○ = FOUND IRON PIPE STAKE
● = FOUND IRON REBAR STAKE
(XXX) = RECORDED AS

100 90 80 70 60 50 40 30 20 10 0 50 100
MAP SCALE IN FEET ORIGINAL 1" = 50'

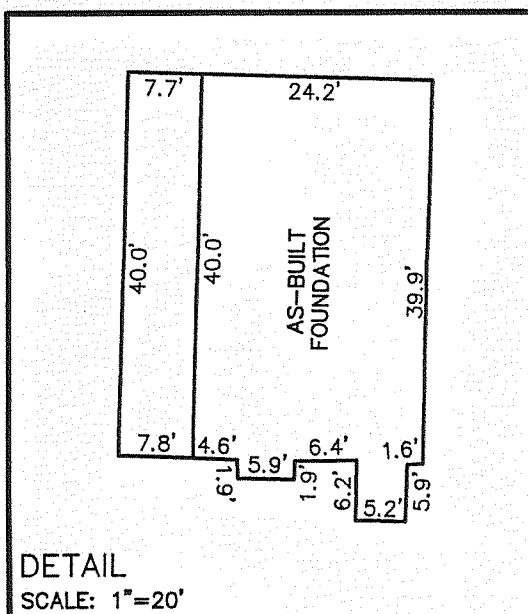

NOTE: COPIES OF THIS MAP TO WHICH THE FOLLOWING CERTIFICATE
WILL APPLY SHOW THE SURVEYOR'S ORIGINAL SEAL AND SIGNATURE
IN RED INK. COPIES BY ANY OTHER MEANS MAY HAVE ALTERATIONS
WHICH DO NOT REPRESENT THE SURVEYOR'S WORK PRODUCT.

I HEREBY CERTIFY THAT THE ABOVE DESCRIBED PROPERTY HAS BEEN
SURVEYED UNDER MY DIRECTION AND THAT THE ABOVE MAP IS A TRUE
REPRESENTATION THEREOF AND SHOWS THE SIZE AND LOCATION OF
THE PROPERTY AND ITS EXTERIOR BOUNDARIES. THIS SURVEY IS
MADE FOR THE USE OF THE PRESENT OWNERS OF THE PROPERTY, AND
ALSO THOSE WHO PURCHASE, MORTGAGE, OR GUARANTEE THE TITLE
THERE TO WITHIN ONE YEAR FROM THE DATE HEREOF.

DATED: MAY 23, 2006

PETER S. GORDON R.L.S. 2101

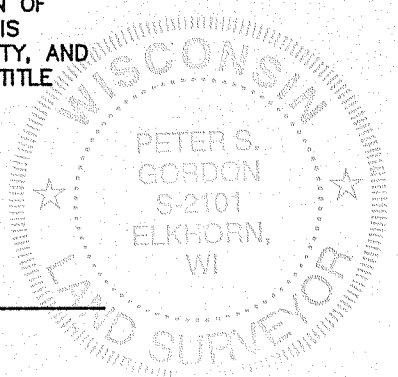

005-2425