

ABERNATHY and ASSOCIATES

Kenneth B. Abernathy Jr.

Wisconsin Registered Land Surveyor S-1594

W4056 BRAY RD.

ELKHORN, WI. 53121

PHONE: (262) 783-4280 (OFFICE)

(262) 723-7209 (FAX)

Email: abernathy@elknet.net

PLAT OF SURVEY

LOT 16 OF BLOCK 1 OF INDIAN HILLS, LOCATED IN THE VILLAGE OF FONTANA-ON-GENEVA LAKE, WALWORTH COUNTY, WISCONSIN.

OWNER: THOMAS TRUST

CHRISTINA THOMAS, TRUSTEE
5731 N. KOSTNER AVE.
CHICAGO, IL. 60646

ORDERED BY: RE/MAX GENEVA REALTY, LTD.

101 BROAD ST., SUITE 1023
LAKE GENEVA, WI. 53147
ATTN: JOHN LAW

LOT 15

PARK

LOT 16
9397 SQ. FT.
0.22 AC.

LOT 17

Area of Questionable Ownership

211 sq. ft.

Found P.K. nails and a pipe on Lot 15 would indicate the 6' wide walkway is West of its true location based on the record dimension of 37.9 feet along the arc for Lot 16. In light of this discrepancy we have labeled this triangle as "Area of Questionable Ownership."

LEGEND

- FOUND IRON PIPE
- FOUND IRON ROD
- ⊗ FOUND BRASS CAPPED MONUMENT
- ⊗ FOUND CONCRETE MONUMENT
- + CHISEL CUT IN CONCRETE
- SET IRON ROD, 24" LONG, WEIGHING 1.5 LBS./LINEAL FT., 3/4" DIA.
- SET IRON ROD, 30" LONG, WEIGHING 4.5 LBS./LINEAL FT., 1-11/16" DIA.
- (x x x) RECORDED AS DIMENSION
- - - - - EXISTING FENCE

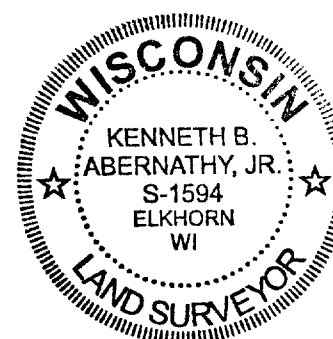
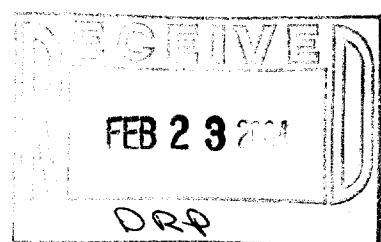

SCALE: 1" = 20 FEET

"I hereby certify that the above described property has been surveyed by me or under my direction and that the above map is a true representation thereof and shows the size and location of the property, its exterior boundaries, the location of all visible structures and dimensions of all principal buildings thereon, boundary fences, apparent easements, roadways and visible encroachments, if any."

"This survey is made for the use of the present owners of the property, and also those who purchase, mortgage, or guarantee the title thereto within one year from the date hereof."

Kenneth B. Abernathy, Jr.
KENNETH B. ABERNATHY, JR. S-1594
WISCONSIN REGISTERED LAND SURVEYOR

DATED Sept. 5, 2003

Job No. 03.901

SIH-17

005-2157