

FARRIS, HANSEN & ASSOCIATES, INC.

ENGINEERING — ARCHITECTURE — SURVEYING
7 RIDGWAY COURT — P.O. BOX 437 — ELKHORN, WISCONSIN 53121
PHONE: (262) 723-2098 FAX: (262) 723-5886

PLAT OF SURVEY

UNIT 1 OF TIMBER RIDGE CONDOMINIUM

LOCATED IN PART OF THE SW 1/4 OF SECTION 13, TOWN 1
NORTH, RANGE 16 EAST, VILLAGE OF FONTANA-ON-GENEVA
LAKE, WALWORTH COUNTY, WISCONSIN

— WORK ORDERED BY —
RAULAND AGENCY
P.O. BOX 159
WALWORTH, WI. 53184

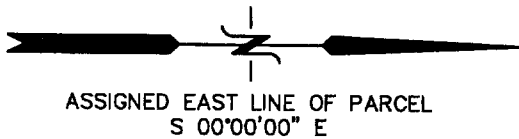

NOTE: "RIGHT-OF-WAY AND EASEMENT" RECORDED IN
VOL. 339 OF RECORDS ON PAGE 782 AS
DOCUMENT NO. 112590 DOES NOT CROSS
THE PARCEL SURVEYED.

UNIT 14

COMMON ELEMENT ROADWAY

TRANSFORMER

ELECTRIC
METER POST

DESIGNATED BUILDING
AREA AS SHOWN ON
CONDOMINIUM PLAT

UNIT 1

22,263 SQ. FT.

UNIT 2

LANDSCAPED
BERM

PAVED DRIVE

BRICK WALK
PORCH

EXISTING
RESIDENCE

ROADWAY EASEMENT OF
RECORD AS SHOWN ON
CONDOMINIUM PLAT

SOUTH SHORE DRIVE
66' WIDE R.O.W.

EDGE OF PAVEMENT

96.02' {96.00'}

PAVEMENT

FOUND IRON PIPE STAKE
N 34°32' W, 0.3' FROM
RECORD CORNER

S 00°00'00" E 132.04'
{132.02'}

LEGEND

- = FOUND IRON PIPE STAKE
- = FOUND IRON REBAR STAKE
- = UTILITY BOX LOCATED
- {XXX} = RECORDED AS

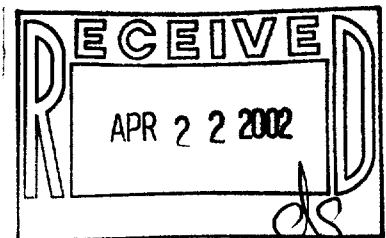

PROJECT: 2210.01.02
SHEET 1 OF 1

NOTE: COPIES OF THIS MAP TO WHICH THE FOLLOWING CERTIFICATE WILL APPLY SHOW
THE SURVEYOR'S ORIGINAL SEAL AND SIGNATURE IN RED INK. COPIES BY ANY OTHER
MEANS MAY HAVE ALTERATIONS WHICH DO NOT REPRESENT THE SURVEYOR'S WORK
PRODUCT.

I HEREBY CERTIFY THAT THE ABOVE DESCRIBED PROPERTY HAS BEEN SURVEYED UNDER
MY DIRECTION AND THAT THE ABOVE MAP IS A TRUE REPRESENTATION THEREOF AND
SHOWS THE SIZE AND LOCATION OF THE PROPERTY, ITS EXTERIOR BOUNDARIES, THE
LOCATION OF ALL VISIBLE STRUCTURES, AND DIMENSIONS OF ALL PRINCIPLE
BUILDINGS THEREON, BOUNDARY FENCES, APPARENT EASEMENTS, ROADWAYS, AND
VISIBLE ENCROACHMENTS, IF ANY. THIS SURVEY IS MADE FOR THE USE OF THE
PRESENT OWNERS OF THE PROPERTY, AND ALSO THOSE WHO PURCHASE, MORTGAGE, OR
GUARANTEE THE TITLE THERETO WITHIN ONE YEAR FROM THE DATE HEREOF.

DATED: 4-16-2002

PETER S. GORDON

X:\PROJECTS\2210_01_02\DCAD\UNIT_1.DCS 04/16/2002

ST-1 005-1972