

ABERNATHY and ASSOCIATES

Kenneth B. Abernathy Jr.

Wisconsin Registered Land Surveyor S-1594

Rt. 3, Box 273
Elkhorn, Wisconsin 53121
Phone: (414) 723 4260 (office)
(414) 723 7209 (FAX)

PLAT OF SURVEY

LOT 5 OF BLOCK 2 OF GLENWOOD
SPRINGS SUBDIVISION, VILLAGE OF
FONTANA - ON - GENEVA LAKE,
WALWORTH COUNTY, WISCONSIN.

OWNER: DOUG WYNNE
1425 W. SCHOOL
CHICAGO, IL. 60057

ORDERED BY: TOM KINKAID
ARCHITECT A.I.A.
N 1645 LINN RD.
LAKE GENEVA, WI. 53147

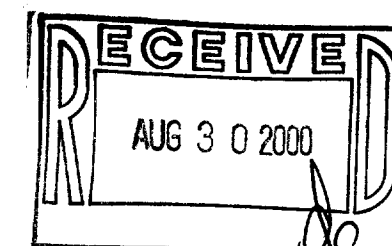
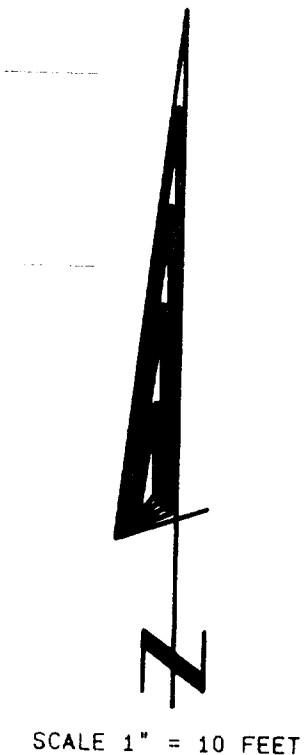
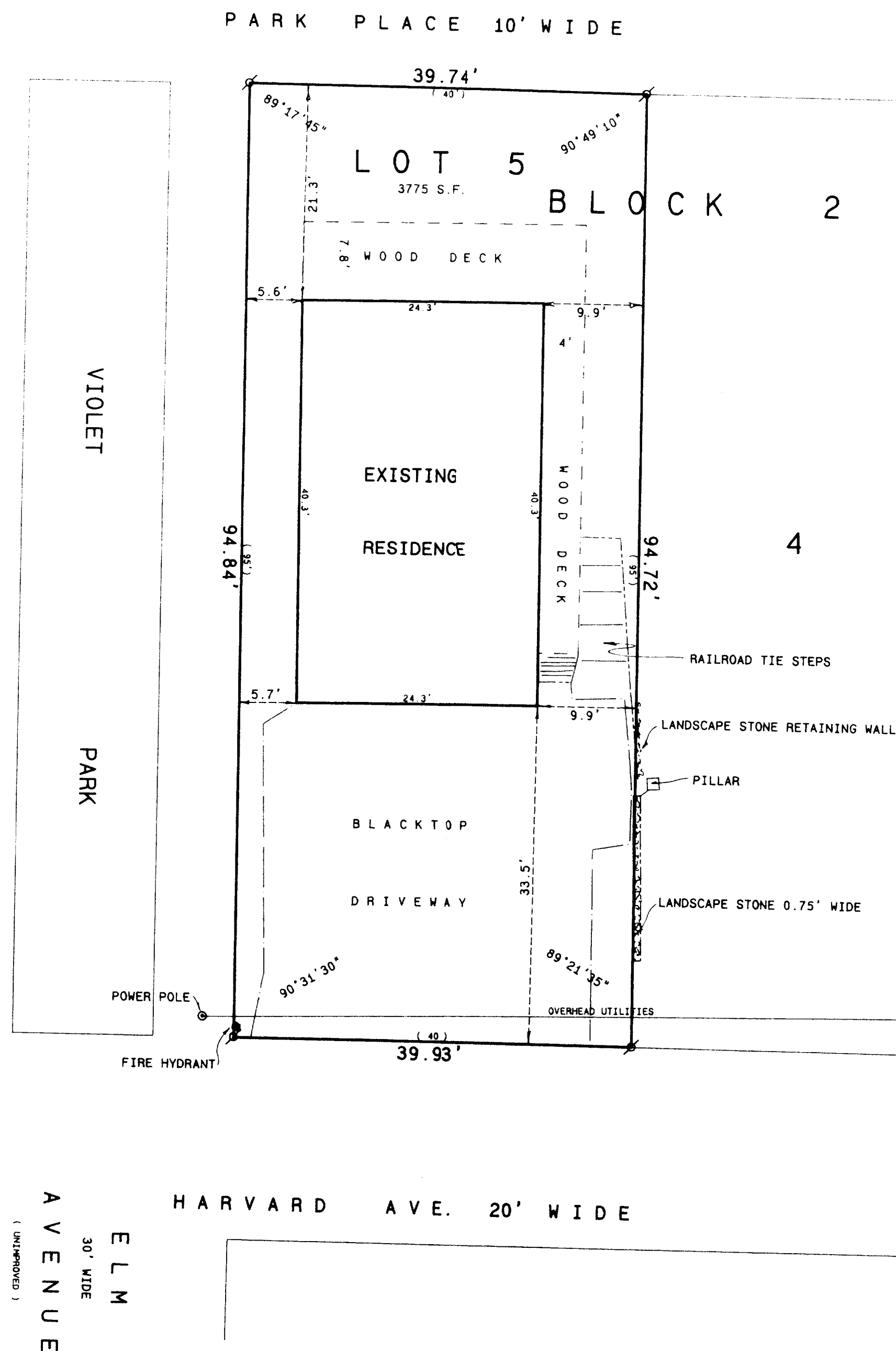

Legend

- FOUND IRON PIPE
- FOUND IRON ROD
- FOUND BRASS CAPPED MONUMENT
- FOUND CONCRETE MONUMENT
- CHISEL CUT IN CONCRETE
- SET IRON ROD, 24" LONG, WEIGHING 1.5 LBS., LINEAL FT., 3/4" DIA.
- SET IRON ROD, 30" LONG, WEIGHING 4.5 LBS., LINEAL FT., 1-11/16" DIA.
- RECORDED AS DIMENSION
- EXISTING FENCE



SCALE: 1" = 10 FEET

"I hereby certify that the above described property has been surveyed by me or under my direction and that the above map is a true representation thereof and shows the size and location of the property, its exterior boundaries, the location of all visible structures and dimensions of all principal buildings thereon, boundary fences, apparent easements, roadways and visible encroachments, if any."

"This survey is made for the use of the present owners of the property, and also those who purchase, mortgage, or guarantee the title thereto within one year from date hereof."

Kenneth B. Abernathy, Jr.

KENNETH B. ABERNATHY, JR.
WISCONSIN REGISTERED LAND SURVEYOR,
S-1594

Date: MAY 15, 2000 Job No. 00508

SBS-9

005-1844