

ABERNATHY and ASSOCIATES

Kenneth B. Abernathy Jr.

Wisconsin Registered Land Surveyor S-1594

Rt. 3, Box 273
Elkhorn, Wisconsin 53121
Phone: (414) 723 4260 (office)
(414) 723 7209 (FAX)

PLAT OF SURVEY

Ordered by: Christopher Hummel
Hummel Construction
553 Forest Glen Drive
Fontana, Wisconsin 53125

Legal Description
The Westerly 48.00 feet of Lot 10 and the Easterly 30.00 feet of Lot 11 of Glenwood Terrace Subdivision, as recorded in Volume 10, Page 11 of Plats, Dated July 2, 1928, being located in the North 1/2 of the Northeast 1/4 of the Northeast 1/4 of Section 23, Town 1 North, Range 16 East, Village of Fontana, County of Walworth, State of Wisconsin, more particularly described as follows;

Commencing at a Found Concrete Monument at the Northeast Corner of said Section 23, thence S 87°28'00" W along the North Line of said Section 33.00 feet to a Found Concrete Monument on the West Right-of-way Line of Indian Hills Road; thence S 2°21'56" E (recorded as S 2°29' E 464.20 feet) along said right-of-way line 464.12 feet to an Iron Pipe on the South Right-of-way Line of Forest Drive; thence S 87°28'07" W along said South Right-of-way Line 683.22 feet (recorded as 683.90 feet) to an Iron Pipe at a point 23.96 feet (recorded as 24.00 feet) Westerly from the Northeast Corner of Lot 10 and the point of beginning; thence continue S 87°28'07" W along said right-of-way line 77.92 feet (recorded as 78.00 feet) to an Iron Pipe; thence S 2°38'04" E 192.61 feet to an Iron Pipe on the South Line of said subdivision; thence N 87°30'46" E (recorded as N 87°21' E 78.00 feet) along said south line 77.92 feet to an Iron Pipe; thence N 2°38'03" W 192.67 feet to the point of beginning. Said parcel contains 0.345 Acres of land more or less.

NOTE
WOOD STAKES HAVE BEEN PLACED AT THE PROPOSED DWELLING CORNERS. BUILDER IS TO VERIFY DIMENSIONS WHICH HAVE BEEN ROUNDED TO THE NEAREST TENTH OF A FOOT TO INSURE PROPER PLAN INTERPRETATION AND CONTACT THIS OFFICE IMMEDIATELY IF ANY DISCREPANCY EXISTS.

Forest Glen Drive
(Forest Drive)

40' Wide

Lot 12 Lot 11 Lot 10 Lot 9

0.345 Acres ±

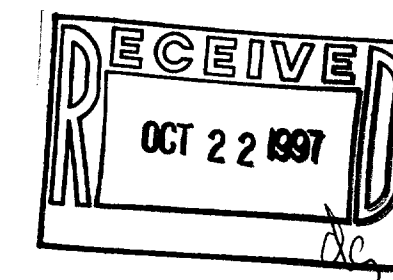

Legend

- FOUND IRON PIPE
- FOUND IRON ROD
- FOUND BRASS CAPPED MONUMENT
- FOUND CONCRETE MONUMENT
- CHISEL CUT IN CONCRETE
- SET IRON ROD, 24" LONG, WEIGHING 1.5 LBS./LINEAL FT., 3/4" DIA.
- SET IRON ROD, 30" LONG, WEIGHING 4.5 LBS./LINEAL FT., 1-11/16" DIA.
- RECORDED AS DIMENSION
- EXISTING FENCE

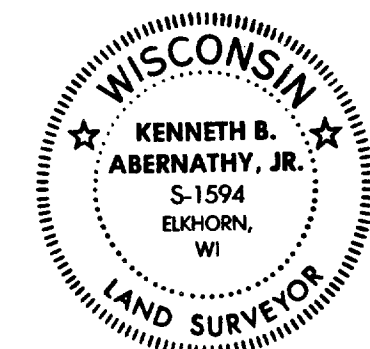

SCALE: 1"=20 FEET

"I hereby certify that the above described property has been surveyed by me or under my direction and that the above map is a true representation thereof and shows the size and location of the property, its exterior boundaries, the location of all visible structures and dimensions of all principal buildings thereon, boundary fences, apparent easements, roadways and visible encroachments, if any."
This survey is made for the use of the present owners of the property, and also those who purchase, mortgage, or guarantee the title thereto within one year from date hereof.

Kenneth B. Abernathy, Jr.

KENNETH B. ABERNATHY, JR.
WISCONSIN REGISTERED LAND SURVEYOR,
S-1594

Date: September 16, 1997 Job No. 1994.3128P

SGT-3A

005-1624