

LOCATED IN THE SE 1/4 OF THE SE 1/4 OF  
SECTION 14, TOWN 1 NORTH, RANGE 16 EAST,  
VILLAGE OF FONTANA-ON-GENEVA LAKE,  
WALWORTH COUNTY, WISCONSIN

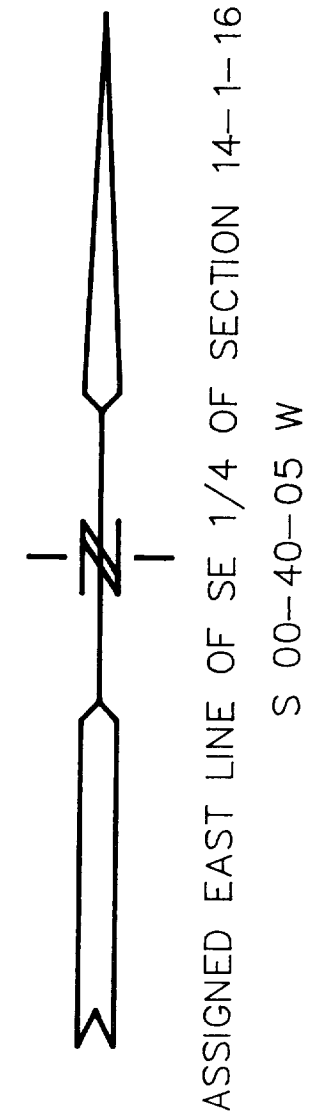

PLAT OF SURVEY

LOCATED IN THE SE 1/4 OF THE SE 1/4 OF  
SEC. 14, T1N., R16E., VILLAGE OF FONTANA-ON-  
GENEVA LAKE, WALWORTH COUNTY, WISCONSIN

—WORK ORDERED BY—  
REEVES CUSTOM BUILDERS, INC.  
982 INDIAN HILLS ROAD  
FONTANA, WI. 53125

**FARRIS, HANSEN & ASSOCIATES, INC.**  
Engineering, Architecture, Surveying  
7 Ridgway Court P.O. Box 437  
ELKHORN, WISCONSIN 53121  
Office: (414) 723-2098  
Fax: (414) 723-5886

## REVISIONS

PROJECT NO.	4530.01
DATE:	07/25/96
SHEET NO.	1 OF 1

### LEGEND

- = FOUND IRON REBAR STAKE 3/4"
- = FOUND IRON PIPE STAKE 1" DIA.
- ▣ = FOUND CONCRETE COUNTY MONUMENT WITH BRASS CAP.
- = SET IRON REBAR STAKE 3/4" X 24" X 1.13 LBS./FT.

(XXX) = RECORDED AS

NOTE: COPIES OF THIS MAP TO WHICH THE FOLLOWING CERTIFICATE  
WILL APPLY ARE BLUE LINE PRINTS SHOWING SURVEYOR'S ORIGINAL  
SEAL AND SIGNATURE IN BLACK INK. COPIES BY ANY OTHER MEANS  
MAY HAVE ALTERATIONS WHICH DO NOT REPRESENT THE SURVEYOR'S  
WORK PRODUCT.

I HEREBY CERTIFY THAT THE ABOVE DESCRIBED PROPERTY HAS BEEN SURVEYED UNDER MY DIRECTION AND THAT THE ABOVE MAP IS A TRUE REPRESENTATION THEREOF AND SHOWS THE SIZE AND LOCATION OF THE PROPERTY AND ITS EXTERIOR BOUNDARIES. THIS SURVEY IS MADE FOR THE USE OF THE PRESENT OWNERS OF THE PROPERTY, AND ALSO THOSE WHO PURCHASE, MORTGAGE, OR GUARANTEE THE TITLE THERETO WITHIN ONE YEAR FROM THE DATE HEREOF.

DATED: 7-25-96

*Peter S. Gordon*  
PETER S. GORDON R.L.S. 2101

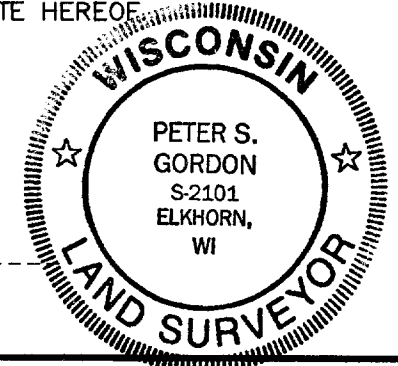

A-2713-1  
5-1530