

ABERNATHY and ASSOCIATES

Kenneth B. Abernathy Jr.

Wisconsin Registered Land Surveyor S-1594

Rt. 3, Box 273  
Elkhorn, Wisconsin 53121  
Phone (414) 723-4260 (office)  
(414) 723-7209 (FAX)

PLAT OF SURVEY

Mesita Road

20' Wide

Lot 13 of Block 6 of Indian Hills 1st Addition Subdivision, located in part of the Southeast 1/4 of Section 14, Town 1 North, Range 16 East, Village of Fontana, County of Walworth, State of Wisconsin.

Ordered by: John O'Neill  
O'Neill Builders, Inc.  
Post Office Box 351  
Fontana, Wisconsin

53125-0351

NOTE

WOOD STAKES HAVE BEEN PLACED AT BUILDING CORNERS. BUILDER IS TO VERIFY DIMENSIONS WHICH HAVE BEEN ROUNDED TO THE NEAREST TENTH OF A FOOT TO INSURE PROPER PLAN INTERPRETATION AND CONTACT THIS OFFICE IMMEDIATELY IF ANY DISCREPANCY EXISTS.

Lot  
12

Block

0.15 Acres ±

Proposed  
Dwelling

Lot  
13

East Line of Indian Hills 1st Addition Subdivision

BEARING BASIS THIS PLAT

S 2°43'00" E

(127.00')

126.98'

Legend

- FOUND IRON PIPE
- FOUND IRON ROD
- FOUND BRASS CAPPED MONUMENT
- FOUND CONCRETE MONUMENT
- CHISEL CUT IN CONCRETE
- SET IRON ROD, 24" LONG, WEIGHING 1.5 LBS., LINEAL FT., 3/4" DIA.
- SET IRON ROD, 30" LONG, WEIGHING 4.5 LBS., LINEAL FT., 1-11/16" DIA.
- (xx) RECORDED AS DIMENSION
- EXISTING FENCE

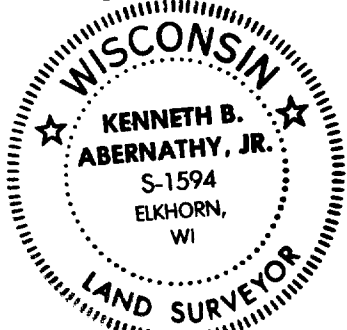
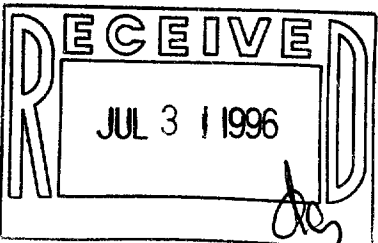

SCALE: 1" = 10 FEET

"I hereby certify that the above described property has been surveyed by me or under my direction and that the above map is a true representation thereof and shows the size and location of the property, its exterior boundaries, the location of all visible structures and dimensions of all principal buildings thereon, boundary fences, apparent easements, railways and visible encroachments, if any."

"This survey is made for the use of the present owners of the property, and also those who purchase, mortgage, or guarantee the title thereto within one year from date hereof."

Kenneth B. Abernathy, Jr.

KENNETH B. ABERNATHY, JR.  
WISCONSIN REGISTERED LAND SURVEYOR,  
S-1594

Date: July 19, 1996 Job No. 1996.704

SIHF-68A  
005-1512

South Line of Indian Hills 1st Addition Subdivision