

ABERNATHY and ASSOCIATES

Kenneth B. Abernathy Jr.

Wisconsin Registered Land Surveyor S-1594

Rt. 3, Box 273
Elkhorn, Wisconsin 53121
Phone: (414) 723-4260 (office)
(414) 723-4813 (residence)

PLAT OF SURVEY

Forest Drive

40' Wide

Parcel "V"
0.344 Acres +

Proposed
Dwelling

Owners: Glenwood Terrace Limited Partnership

Ordered by: John O'Neill
O'Neill Builders, Inc.
Post Office Box 351
Fontana, Wisconsin

53125-0351

Parcel "V"
The Westerly 36.00 feet of Lot 12 and the Easterly 42.00 feet of Lot 13 of Glenwood Terrace Subdivision, as recorded in Volume 10, Page 11 of Plats, Dated July 2, 1928, being located in the North 1/2 of the Northeast 1/4 of the Northeast 1/4 of Section 23, Town 1 North, Range 16 East, Village of Fontana, County of Walworth, State of Wisconsin, more particularly described as follows:

Commencing at a Found Concrete Monument at the Northeast Corner of said Section 23, thence S 87°28'00" W along the North Line of said Section 33.00 feet to a Found Concrete Monument on the West Right-of-way Line of Indian Hills Road; thence S 2°21'56" E (recorded as S 2°29' E 464.20 feet) along said right-of-way line 464.12 feet to an Iron Pipe on the South Right-of-way Line of Forest Drive; thence S 87°28'07" W along said South Right-of-way Line 839.06 feet (recorded as 839.90 feet) to an Iron Pipe at a point 35.94 feet (recorded as 36.00 feet) Westerly from the Northeast Corner of Lot 12 and the point of beginning; thence continue S 87°28'07" W along said right-of-way line 77.92 feet (recorded as 78.00 feet) to an Iron Pipe; thence S 2°38'06" E 192.49 feet to an Iron Pipe on the South Line of said subdivision; thence N 87°30'46" E (recorded as N 87°21' E 78.00 feet) along said south line 77.92 feet to an Iron Pipe; thence N 2°38'05" W 192.55 feet to the point of beginning. Said parcel contains 0.344 Acres of land more or less and is subject to easements recorded or unrecorded.

Legend

- FOUND IRON PIPE
- FOUND IRON ROD
- FOUND BRASS CAPPED MONUMENT
- FOUND CONCRETE MONUMENT
- CHISEL CUT IN CONCRETE
- SET IRON ROD, 24" LONG, WEIGHING 1.5 LBS./LINEAL FT., 3/4" DIA.
- SET IRON ROD, 30" LONG, WEIGHING 4.5 LBS./LINEAL FT., 1-11/16" DIA.
- (xx) RECORDED AS DIMENSION
- EXISTING FENCE

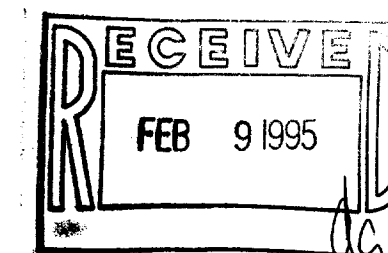

SCALE: 1"=20 FEET

"I hereby certify that I have surveyed the above described property and that the above map is a true representation thereof and shows the size and location of the property, its exterior boundaries, the location of all visible structures and dimensions of all principal buildings thereon, boundary fences, apparent easements, roadways and visible encroachments, if any."

"This survey is made for the use of the present owners of the property, and also those who purchase, mortgage, guarantee the title thereto within one year from date hereof."

Kenneth B. Abernathy, Jr.
KENNETH B. ABERNATHY, JR.
WISCONSIN REGISTERED LAND SURVEYOR,
S-1594

Date: December 2, 1994 Job No. 1994.7288P

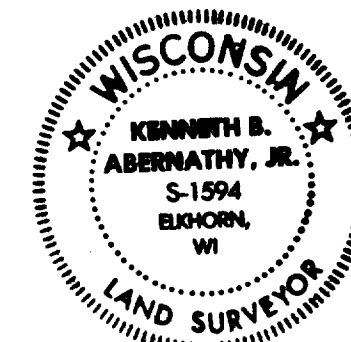

SGT-4D

005-1433