

22

N 43°-14' E 116.32

16.3

24.0

25.6

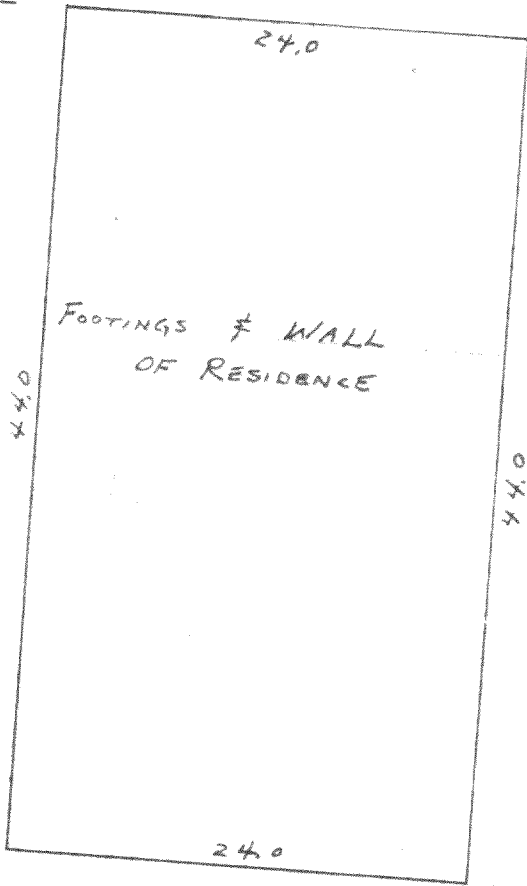

44.0

44.0

24.0

28.0

NORTH 47.77

50'

WOODLAND DRIVE

N

- - CONCRETE MONUMENT
- - IRON PIPE

LOT 21

S 44°-00' E 113.80

N 23°-00' E 88.93

FOREST DR

STATE OF WISCONSIN) SS
COUNTY OF WALWORTH)

I, LLOYD L. JENSEN, DO HEREBY CERTIFY THAT I HAVE SURVEYED THE PROPERTY DESCRIBED HEREON ACCORDING TO THE OFFICIAL RECORDS, AND THAT THE PLAT HEREON IS A CORRECT REPRESENTATION OF THE LOT LINES AND PRINCIPAL LINES OF BUILDINGS THEREON.

ELKHORN, WISCONSIN NOVEMBER, 1954

Lloyd L. Jensen
SURVEYOR

PLAT OF SURVEY
OF

LOT 21 OF ADDITION D
TO COUNTRY CLUB ESTATES
LOCATED IN THE
VILLAGE OF FONTANA-ON-GENEVA LAKE
WALWORTH COUNTY, WISCONSIN

Lloyd L. Jensen
SURVEYOR

SCALE 1" = 10'

DATE Nov. 1954