

PLAT OF SURVEY

Lot 26 of Urbandale, a subdivision located in the Southeast 1/4 & Southwest 1/4 of the Northwest 1/4, and the Southwest 1/4 of the Northeast 1/4, all in Section 1, Town 2 North, Range 16 East, City of Elkhorn, Walworth County, Wisconsin

Unplatted
Lands

Lot
19

Lot
27

Lot
26
34778 Sq. Ft.

Lot
20

Legend

- FOUND IRON PIPE
- FOUND IRON ROD
- FOUND BRASS CAPPED MONUMENT
- FOUND CONCRETE MONUMENT
- CHISEL CUT IN CONCRETE
- SET IRON ROD, 24" LONG, WEIGHING 1.5 LBS./LINEAL FT., 3/4" DIA.
- SET IRON ROD, 30" LONG, WEIGHING 4.5 LBS./LINEAL FT., 1-11/16" DIA.
- (xx) RECORDED AS DIMENSION
- EXISTING FENCE

Davis
Court

Lot
25

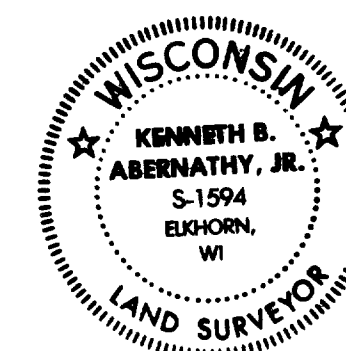
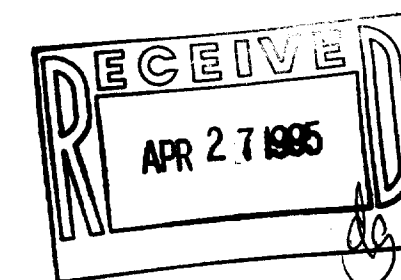

SCALE: 1" = 20 FEET

NOTE
Benchmark = Top nut of Fire Hydrant at the Northwest Corner of the intersection of Devendorf Street and Davis Street, Assumed Elevation 1001.64' as shown on subdivision street and sewer construction plans.

Ordered by: Thelen Total Construction, Inc.
Post Office Box 17
Elkhorn, Wisconsin
53121-0017

"I hereby certify that the above described property has been surveyed by me or under my direction and that the above map is a true representation thereof and shows the size and location of the property, its exterior boundaries, the location of all visible structures and dimensions of all principal buildings thereon, boundary fences, apparent easements, roadways and visible encroachments, if any."
"This survey is made for the use of the present owners of the property, and also those who purchase, mortgage, or guarantee the title thereof, within one year from date hereof."

Kenneth B. Abernathy, Jr.
KENNETH B. ABERNATHY, JR.
WISCONSIN REGISTERED LAND SURVEYOR,
S-1594
Date: April 5, 1995 Job No. 1995.401