

ABERNATHY and ASSOCIATES

Kenneth B. Abernathy Jr.

Wisconsin Registered Land Surveyor S-1594

Rt. 3, Box 273

Elkhorn, Wisconsin 53121

Phone: (414) 723-4260 (office)

(414) 723-4813 (residence)

## PLAT OF SURVEY

A PARCEL OF LAND LOCATED IN THE NORTHWEST  
1/4 OF SECTION 6, TOWN 2 NORTH, RANGE 17  
EAST, CITY OF ELKHORN, WALNORTH COUNTY,  
WISCONSIN.

OWNERS: AUGUST N. ANSTEDT AND MARY ANN  
ANSTEDT

C/O ELKHORN MACHINE CO.  
GETZEN AND CENTRALIA  
ELKHORN, WI. 53121

### LEGAL DESCRIPTION:

AS PROVIDED IN VOL. 380 P. 616 AS DOCUMENT NO. 135574

GETZEN STREET  
66 FEET WIDE

SOUTHWEST CORNER OF HARMONY ACRES SUBDIVISION  
(REC. ASS 1'27" N 588.39')

CENTRALIA STREET  
66 FEET WIDE

(REC. AS S 69°02'E 215.00')  
S 69°05'07" E 214.95'

OVERHEAD AND UNDERGROUND UTILITIES ALONG ROAD LINE.

EXISTING BUILDING

1.17 ACRES

SET IRON PIPE

N 89°16'24" W 201.84'  
(REC. AS N 89°13' W 201.80')

SET IRON PIPE

SCALE 1" = 40 FEET

### Legend

- FOUND IRON PIPE
- FOUND IRON ROD
- FOUND BRASS CAPPED MONUMENT
- FOUND CONCRETE MONUMENT
- ✦ CHISEL CUT IN CONCRETE
- SET IRON ROD, 24" LONG, WEIGHING  
1.5 LBS./LINEAL FT., 3/8" DIA.
- SET IRON ROD, 30" LONG, WEIGHING  
4.5 LBS./LINEAL FT., 1-11/16" DIA.
- (xx) RECORDED AS DIMENSION
- X—X— EXISTING FENCE

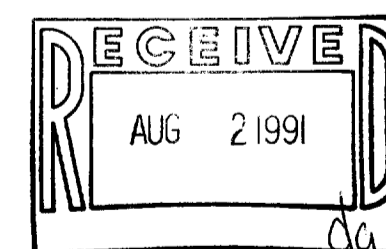

SCALE: 1" = 40 FEET

"I hereby certify that I have surveyed the above described property and that the above map is a true representation thereof and shows the size and location of the property, its exterior boundaries, the location of all visible structures and dimensions of all principal buildings thereon, boundary fences, apparent easements, roadways and visible encroachments, if any."

"This survey is made for the use of the present owners of the property, and also those who purchase, mortgage, or guarantee the title thereto within one year from date hereof."

*Kenneth B. Abernathy Jr.*  
KENNETH B. ABERNATHY, JR.  
WISCONSIN REGISTERED LAND SURVEYOR,  
S-1594

Date: 7/23/91 Job No. 91711

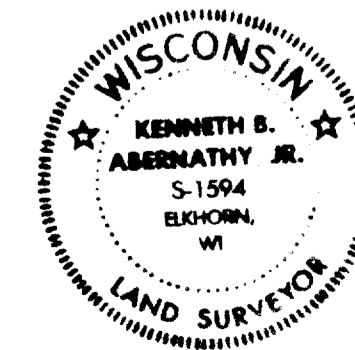

004-673

WSE 00009F