

**SURVEYING & SUBDIVIDING  
DELAN, WISCONSIN 53115**

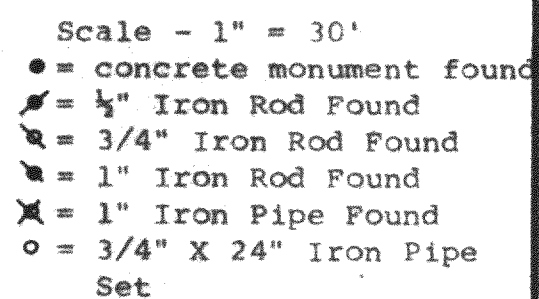

Bearings referenced to the east  
line of Wisconsin Street with the  
assumed bearing of North  
Survey ordered by:  
Modern Realty  
102 North Wisconsin Street  
Elkhorn, WI 53121

STATE OF WISCONSIN)  
COUNTY OF WALWORTH) SS

I, George T. Dunham, Surveyor, certify that I have surveyed the property described as follows:

Lots 26 and 27 in Block 3 of Preston's Addition to the City of Elkhorn, Walworth County, Wisconsin and also the West ½ of Vacated Washington Street which adjoins said Lot 27.

and that the plat shown hereon is a correct representation thereof and shows the size and location of the property, its exterior boundaries, the location of all visible structures and dimensions of all principal buildings thereon, boundary fences, apparent easements, roadways and visible encroachments, if any, and that I have surveyed the property hereon described, according to the official records, to the best of my knowledge and belief.

June 4, 1990

  
George T. Dunham, Surveyor

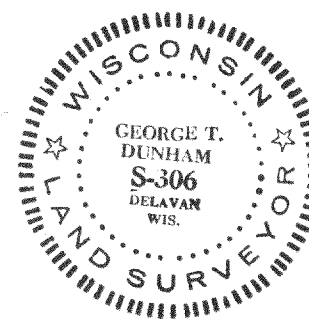
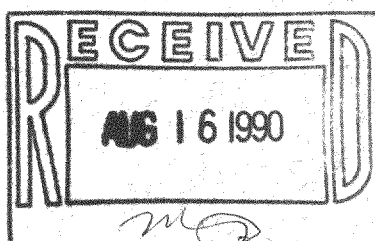

Survey # 004-633

TAX KEY # VP 000016A  
VP 000017