

Plat of Survey

of

Lot 2 of Certified Survey Map No. 3949,

recorded in Vol. 24 of Certified Survey Maps of Walworth County on Page 152 and located in the Southeast 1/4 of the Northeast 1/4 of Section 24, Town 3 North, Range 16 East, City of Elkhorn, Walworth County, Wisconsin.

Surveyed for: **DKD Enterprises, LLC**
305 West Oak Lane
Elkhorn, Wisconsin. 53121



Bearings referenced to the West line of Fairway Lane, recorded as N2°14'24"W on Certified Survey Map No. 3949.

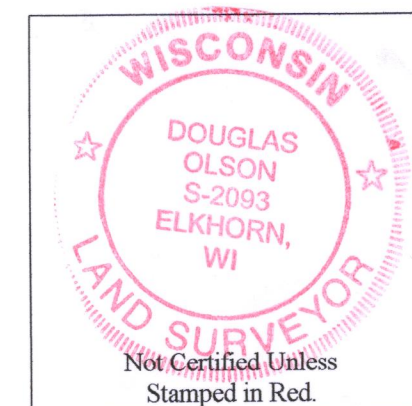

Notes:

- 1) This Plat of Survey is not certified unless signed and sealed in red ink.
- 2) This survey is subject to Wisconsin lien laws. This Plat of Survey is the notice of intent to file lien. Lien waiver required.
- 3) The Survey Date shown on this Plat of Survey is the completion date of the field work.

Copyright ©2018 by Olson Land Surveying, LLC.

All rights reserved. No part of this survey plat may be reproduced or transmitted in any form by any means - graphic, electronic, or mechanical, including photocopying, tracing, or information storage and retrieval systems - without permission in writing from Douglas G. Olson, Olson Land Surveying, LLC.

I hereby certify that I have surveyed the above described property in compliance with Chapter A-E 7 of the Wisconsin Administrative Code and that the map hereon is correct to the best of my professional knowledge and belief and shows the size and location of the property, its exterior boundaries, the location and dimensions of all visible structures thereon, boundary fences, apparent easements and roadways and visible encroachments, if any.

This survey is made for the exclusive use of the present owners of the property, and also those who purchase, mortgage or guarantee title thereto, within one year from the date hereof.

Douglas G. Olson
Wisconsin Professional Land Surveyor - 2093

Survey Date: June 28, 2018.
Revisions:

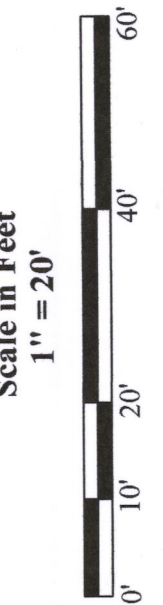

45 South Wisconsin Street | P.O. Box 322
Elkhorn, Wisconsin. 53121
Telephone: (262) 723-3434
Facsimile: (262) 723-8044
Email: doug@olsonsurveying.com
Website: www.olsonsurveying.com

OLSON
LAND SURVEYING, LLC
Rural | Residential | Commercial

Legend of Symbols & Abbreviations

N	North
S	South
E	East
W	West
in	Inches
ft	Feet
deg	Degrees
'	Minutes
"	Seconds
in	Inches
ft	Feet

Found Iron Pipe 2" dia.
Found Iron Rod 3/4" dia.
Recorded Information
Light Pole
Utility Box or Pedestal
Survey Point
Catch Basin
Asphalt Surface
Concrete Surface

Sheet 1 of 1 Sheets

Job Reference Number
2018.077

2018.077