

Plat of Survey

of

Lot 43 of Urbandale,

a subdivision located in the Southeast 1/4 of the Northwest 1/4 of Section 1,
Town 2 North, Range 16 East, City of Elkhorn, Walworth County, Wisconsin.

Surveyed for: **Keefe Real Estate, Inc.**
204 East Commerce Court
Elkhorn, Wisconsin. 53121



Bearings referenced to the West line of Lots 44 through 48 of Urbandale,
recorded as N1°25'31"W, which produces a bearing of N0°36'56"W on the
West line of the Northwest 1/4 of Section 1-2-16. A rotation of -0°01'33"
from the Wisconsin State Plane Coordinate System, South Zone, (NAD-27).

Coordinates are referenced to the Wisconsin State
Plane Coordinate System, South Zone, (NAD-27).

Tax Parcel
YUSW 00042

recorded as(N88°34'21"E 159.00')
N88°35'52"E 159.03'

10' Wide Utility Easement
As shown on the plat of Urbandale.

Basketball

Lot 43
Tax Parcel
YU 00043
0.433 Acre
18,855 Sq.Ft.

Lot 1
C.S.M. 2118

Lot 44

House
No. 501

5' Wide Utility Easement
As shown on C.S.M. 2118.

S1°28'06"E 109.94'
recorded as(S1°25'31"E 110.00')

Lot 2
C.S.M. 2118

Lot 42

S70°32'43"W 101.82'
recorded as(S70°35'13"W 101.59')

Arc=77.44'
(77.40')

Chord=N56°26'34"W 72.17'
(N56°22'10"W 72.14')

Concrete Curb & Gutter
Curb Cut

Chord=N17°49'06"E 72.75'
(N17°33'30"E 72.74')

Jerome Court
(66' Wide)

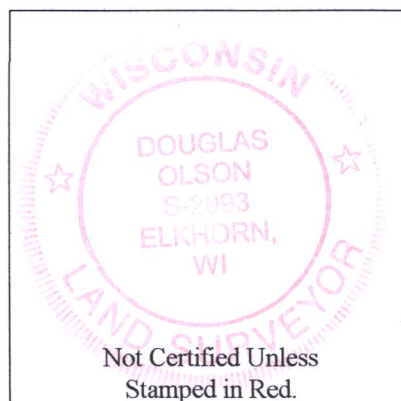

Notes:

- 1) This Plat of Survey is not certified unless signed and sealed in red ink.
- 2) This survey is subject to Wisconsin lien laws. This Plat of Survey is the notice of intent to file lien. Lien waiver required.
- 3) The Survey Date shown on this Plat of Survey is the completion date of the field work.

Copyright ©2018 by Olson Land Surveying, LLC.

All rights reserved. No part of this survey plat may be reproduced or transmitted in any form by any means - graphic, electronic, or mechanical, including photocopying, tracing, or information storage and retrieval systems - without permission in writing from Douglas G. Olson, Olson Land Surveying, LLC.

I hereby certify that I have surveyed the above described property in compliance with Chapter A-E 7 of the Wisconsin Administrative Code and that the map hereon is correct to the best of my professional knowledge and belief and shows the size and location of the property, its exterior boundaries, the location and dimensions of all visible structures thereon, boundary fences, apparent easements and roadways and visible encroachments, if any.

This survey is made for the exclusive use of the present owners of the property, and also those who purchase, mortgage or guarantee title thereto, within one year from the date hereof.

Douglas G. Olson
Wisconsin Professional Land Surveyor - 2093 YU-43 004-2653

Survey Date: April 23, 2018.

Revisions:

Scale in Feet
1" = 20'



45 South Wisconsin Street | P.O. Box 322
Elkhorn, Wisconsin. 53121
Telephone: (262) 723-3434
Facsimile: (262) 723-8044
Email: doug@olsonsurveying.com
Website: www.olsonsurveying.com

OLSON
LAND SURVEYING, LLC
Rural | Residential | Commercial

Legend of Symbols & Abbreviations
N North
S South
E East
W West
In Bearings
In Degrees
In Minutes
In Seconds
In Distances
In Feet
In Inches
Found County Section Corner
Found Iron Pipe 1-3/16" dia.
Found Iron Rod 3/4" dia.
Recorded Information
Utility Pedestal
Manhole
Light Pole
As Shown Surface
Concrete Surface

Sheet 1 of 1 Sheets

Drawing Name

Job Reference Number

2018.041

2018.041