

Plat of Survey

of

A parcel of land described in Title Commitment No. WA-9935 prepared by Chicago Title Insurance Company, dated July 21, 2017 as shown below:

All that certain part of Lot No. 1 in Block 26, in the Plat of Elkhorn, and being sometimes known as the Original Plat of the City of Elkhorn, Walworth County, Wisconsin, described as follows, to-wit:

Commencing at a point in the East line of said Lot No. 1, 111 feet and 10 inches south of the Northeast corner of said Lot No. 1, running thence West parallel with the North and South lines of said Lot 55 feet, thence South 22 feet and 4 inches more or less to the South of said Lot, thence East along the South line of said Lot 55 feet to the East line of said Lot No. 1, thence North along the East line of said Lot 22 feet and 4 inches to the place of beginning.

Tax Key No. YOP 00222

Address: 12 and 12 1/2 South Wisconsin Street

Surveyed for: **The Rauland Agency, Inc.**

118 Kenosha Street
Walworth, Wisconsin. 53184

S88°22'36"W 432.48'

66.00'

Northwest Corner of Block 25, disc in sidewalk is 0.12' N37°56'08"W former location of crosscut at corner.

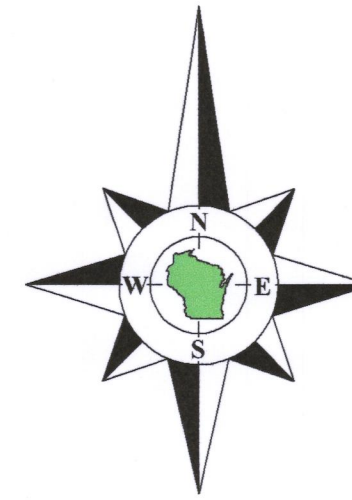

Bearings referenced to the South line of the Southeast 1/4 of Section 36-3-16, recorded as N88°05'20"E in the Wisconsin State Plane Coordinate System, South Zone, (NAD-27).

Lot 1

Tax Parcel
YOP 00219

Tax Parcel
YOP 00221

Tax Parcel
YOP 00222

Building
No. 12 & 12-1/2

0.028 Acre
1,228 Sq.Ft.

Tax Parcel
YOP 00231

Lot 5

Wisconsin Street
(66' Wide)

N1°49'32"W 498.69'

82.28'

1.00'

S1°49'32"E 111.83'

S1°49'32"E 22.33'

223.09'

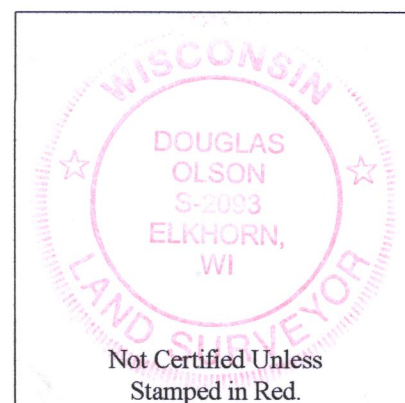

Notes:

- 1) This Plat of Survey is not certified unless signed and sealed in red ink.
- 2) This survey is subject to Wisconsin lien laws. This Plat of Survey is the notice of intent to file lien. Lien waiver required.
- 3) The Survey Date shown on this Plat of Survey is the completion date of the field work.

Copyright ©2017 by Olson Land Surveying, LLC.

All rights reserved. No part of this survey plat may be reproduced or transmitted in any form by any means - graphic, electronic, or mechanical, including photocopying, tracing, or information storage and retrieval systems - without permission in writing from Douglas G. Olson, Olson Land Surveying, LLC.

I hereby certify that I have surveyed the above described property in compliance with Chapter A-E 7 of the Wisconsin Administrative Code and that the map hereon is correct to the best of my professional knowledge and belief and shows the size and location of the property, its exterior boundaries, the location and dimensions of all visible structures thereon, boundary fences, apparent easements and roadways and visible encroachments, if any.

This survey is made for the exclusive use of the present owners of the property, and also those who purchase, mortgage or guarantee title thereto, within one year from the date hereof.

Douglas G. Olson
Wisconsin Professional Land Surveyor - 2093



Survey Date: October 12, 2017.
Revisions: No. 1 - Misc.

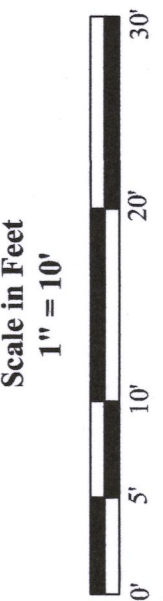

45 South Wisconsin Street | P.O. Box 322
Elkhorn, Wisconsin 53121
Telephone: (262) 723-3434
Facsimile: (262) 723-8044
Email: doug@olsonsurveying.com
Website: www.olsonsurveying.com

OLSON
LAND SURVEYING, LLC
Rural | Residential | Commercial

Legend of Symbols & Abbreviations

N	North
S	South
E	East
W	West
In	Inches
Feet	Feet
Minutes	Minutes
Seconds	Seconds
Distances	Distances
in Feet	in Feet
in Inches	in Inches
Found Iron Pipe	Found Iron Pipe
Found Cut Cross	Found Cut Cross
Set Iron Pipe, 1" dia.	Set Iron Pipe, 1" dia.
Recorded Information	Recorded Information
Utility Pole or Pedestal	Utility Pole or Pedestal
Bollard	Bollard
Manhole Surface	Manhole Surface
Asphalt Surface	Asphalt Surface
Concrete Surface	Concrete Surface
Gravel Surface	Gravel Surface

Sheet 1 of 1 Sheets

Job Reference Number

2017.089

2017.089