

Plat of Survey

of

Lot 9 of Alder Subdivision,

located in the Southwest 1/4 of the Northwest 1/4 of Section 1, Town 2 North, Range 16 East, City of Elkhorn, Walworth County, Wisconsin.

Surveyed for: Keefe Real Estate, Inc.

204 Commerce Court
Elkhorn, Wisconsin. 53121

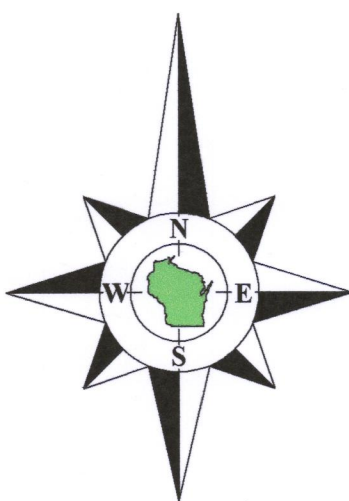

Bearings referenced to the South line of Centralia Street, recorded as N88°12'53"E on the plat of Alder Subdivision.

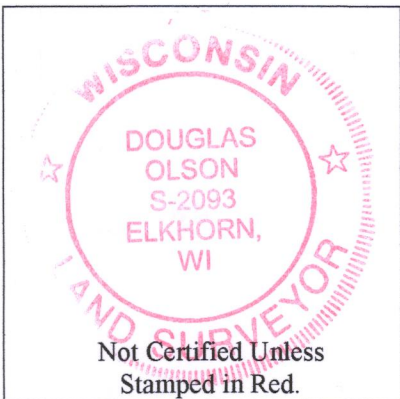
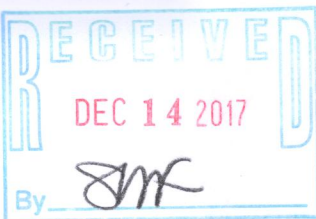

Notes:

- 1) This Plat of Survey is not certified unless signed and sealed in red ink.
- 2) This survey is subject to Wisconsin lien laws. This Plat of Survey is the notice of intent to file lien. Lien waiver required.
- 3) The Survey Date shown on this Plat of Survey is the completion date of the field work.

I hereby certify that I have surveyed the above described property in compliance with Chapter A-E 7 of the Wisconsin Administrative Code and that the map hereon is correct to the best of my professional knowledge and belief and shows the size and location of the property, its exterior boundaries, the location and dimensions of all visible structures thereon, boundary fences, apparent easements and roadways and visible encroachments, if any.

This survey is made for the exclusive use of the present owners of the property, and also those who purchase, mortgage or guarantee title thereto, within one year from the date hereof.

Douglas G. Olson
Wisconsin Professional Land Surveyor - 2093

Copyright© 2017 by Olson Land Surveying, LLC.

All rights reserved. No part of this survey plat may be reproduced or transmitted in any form by any means - graphic, electronic, or mechanical, including photocopying, tracing, or information storage and retrieval systems - without permission in writing from Douglas G. Olson, Olson Land Surveying, LLC.

Tax Parcel
YUSW 00043

45 South Wisconsin Street | P.O. Box 322
Elkhorn, Wisconsin. 53121
Telephone: (262) 723-3434
Facsimile: (262) 723-8044
Email: doug@olsonsurveying.com
Website: www.olsonsurveying.com

Scale in Feet
1" = 20'



Survey Date: October 4, 2017.
Revisions:

Sheet 1 of 1 Sheets

Drawing Name:

Job Reference Number
2017.123

Legend of Symbols & Abbreviations

- Found Iron Rod, 1-3/16" dia.
 - Found Iron Rod, 3/4" dia.
 - ⊗ Set Iron Pipe, 1" dia.
 - () Recorded Information
 - ⊗ Light Pole
 - ⊗ Utility Pedestal
 - ⊗ Catch Basin
 - ⊗ Water Valve
 - ⊗ Asphalt Surface
 - Coniferous Tree
 - Manhole
 - Fire Hydrant
 - Concrete Surface
- N North
S South
E East
W West
In Bearings
° Degrees
' Minutes
" Seconds
In Distances
Feet
Inches



2017.123

YALD -9

004-2633