

Plat of Survey

of

Lot 7 in Block 2 of Fairlane Subdivision Add'n No. 1,

a subdivision located in the Southwest 1/4 of the Northwest 1/4 of Section 31, Town 3 North, Range 17 East, City of Elkhorn, Walworth County, Wisconsin.

EXCEPTING THEREFROM

Lands described in a Quit Claim Deed recorded May 31, 2017 as Document No. 947379 as shown below:
Part of Lot 7 in Block 2 of Fairlane Subdivision Addition No. 1, a subdivision located in the Southwest 1/4 of the Northwest 1/4 of Section 31, Town 3 North, Range 17 East, City of Elkhorn, Walworth County, Wisconsin, described as follows: Begin at an iron pipe marking the Southeast corner of said Lot 7; thence South 89°55'57" West, along the South line of said Lot 7, 68.00 feet to an iron pipe; thence North 0°01'52" West 5.10 feet to an iron pipe; thence North 89°55'57" East 68.00 feet to an iron pipe on the East line of said Lot 7; thence South 0°01'52" East, along said East line, 5.10 feet to the Point of Beginning.

Lot 2

Block 4

recorded as(East 149.29')
N89°57'32"E 149.23'

Pipe is 0.62'
E. & 0.30' S.
of corner.

S89°57'32"W 278.77'

recorded as(S89°59'19"W 129.49')Farris 1995
recorded as(East 128.50')Plat
S89°57'32"W 129.54'

Found 2nd pipe
bent, is 3.69'
E. & 0.29' N.

Concrete Curb & Gutter

First Avenue

(66' Wide)

Concrete Curb & Gutter

Curb Cut

Overhead Wires

recorded as(East 192.50')
N89°54'52"E 192.87'

recorded as(East 149.29')
N89°57'32"E 149.26'

Sidewalk

Driveway

Lot 7
Tax Parcel
YFLA 00001
0.346 Acre
15,089 Sq.Ft.

Duplex

No. 303

No. 307

Patio

S0°01'52"E 98.26'

recorded as(North 284.67')
N0°01'52"W 284.59'

Concrete Curb & Gutter

Sandy Lane

(66' Wide)

Concrete Curb & Gutter



Bearings referenced to the West line
of Fairlane Subdivision Add'n No. 1,
recorded as North on the plat.

Fairlane Subdivision
Block 2

Lot 1

recorded as(North 103.40')
North 103.43'

Lot 2

recorded as(North 663.40')
North 663.42'

Lot 3

Wood Fence

S89°54'48"W 149.36'
recorded as(East 149.29')

Rod is 0.34'
S. of corner.

Lot 8

Lot 9

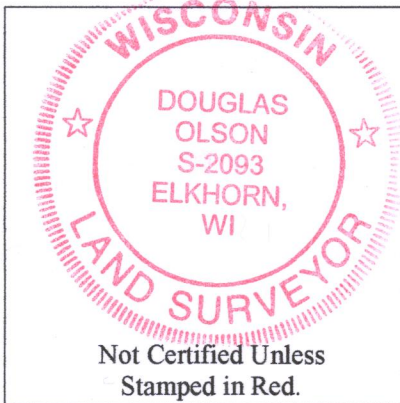

Notes:

- 1) This Plat of Survey is not certified unless signed and sealed in red ink.
- 2) This survey is subject to Wisconsin lien laws. This Plat of Survey is the notice of intent to file lien. Lien waiver required.
- 3) The Survey Date shown on this Plat of Survey is the completion date of the field work.

Copyright© 2017 by Olson Land Surveying, LLC.

All rights reserved. No part of this survey plat may be reproduced or transmitted in any form by any means - graphic, electronic, or mechanical, including photocopying, tracing, or information storage and retrieval systems - without permission in writing from Douglas G. Olson, Olson Land Surveying, LLC.

I hereby certify that I have surveyed the above described property in compliance with Chapter A-E 7 of the Wisconsin Administrative Code and that the map hereon is correct to the best of my knowledge and belief.

Douglas G. Olson
Wisconsin Professional Land Surveyor - 2093

YFLA-1

004-2624



Sheet 1 of 1 Sheets

Drawing Name:

Job Reference Number
2016.136

Legend of Symbols & Abbreviations

Found Iron Pipe X Set Cut Cross
Found Iron Rod
Found 100d Spike
Set Iron Pipe, 1" dia.
() Recorded Information
Utility Pole
Utility Pedestal
Water Valve
Asphalt Surface
N North
S South
E East
W West
In Bearings
Degrees
Minutes
Seconds
In Distances
Feet
Inches
Catch Basin
Manhole
Hydrant
Brick Pavers
Concrete Surface



45 South Wisconsin Street | P.O. Box 322
Elkhorn, Wisconsin. 53121
Telephone: (262) 723-3434
Facsimile: (262) 723-8044
Email: doug@olsonsurveying.com
Website: www.olsonsurveying.com

Scale in Feet
1" = 20'



Survey Date: April 22, 2017.

Revisions: No. 1 - Proposed Lot
Line Adjustment
No. 2 - Recorded Lot
Line Adjustment

2016.136