

FARRIS, HANSEN & ASSOCIATES, INC.

ENGINEERING - ARCHITECTURE - SURVEYING
7 RIDGWAY COURT - P.O. BOX 437 - ELKHORN, WISCONSIN 53121
PHONE: (262) 723-2098 FAX: (262) 723-5886

PLAT OF SURVEY

LOT 118 OF THE PINES A SUBDIVISION LOCATED IN THE
NW, NE, SW, & SE 1/4'S OF THE SE 1/4 OF
SECTION 5, TOWN 2 NORTH, RANGE 17 EAST IN THE
CITY OF ELKHORN, WALWORTH COUNTY, WISCONSIN

- WORK ORDERED BY -
THE TRACY GROUP
525 KENOSHA STREET, SUITE D
WALWORTH, WI 53184

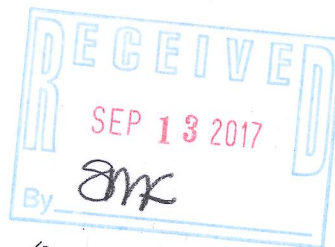

NOTE:
SEE AS-BUILT PLANS FOR THE
PINES FOR SANITARY SEWER AND
WATER CONNECTIONS (CITY
RECORDS).

10' WIDE UTILITY EASEMENT
CENTERED ON LOT LINE

LOT 118

9,452 S.F.

LOT 117
EXISTING RESIDENCE
(FF=1019.98')

BENCH MARK
UPPER FLANGE BOLT
ELEV.=1018.81'

PROPOSED
RESIDENCE
TF=1019.28'
FF=1020.48
BF=1011.28'

PROPOSED SILT FENCE
(TYPICAL)

PROPOSED TEMPORARY TOPSOIL
STOCKPILE AREA

LOT 119
(VACANT)

LONGNEEDLE LANE

MAP SCALE IN FEET - ORIGINAL 1"=20'

NOTE: COPIES OF THIS MAP TO WHICH THE FOLLOWING CERTIFICATE WILL APPLY SHOW THE SURVEYOR'S ORIGINAL
SEAL AND SIGNATURE IN RED INK. COPIES BY ANY OTHER MEANS MAY HAVE ALTERATIONS WHICH DO NOT
REPRESENT THE SURVEYOR'S WORK PRODUCT.

I HEREBY CERTIFY THAT THE ABOVE DESCRIBED PROPERTY HAS BEEN SURVEYED UNDER MY DIRECTION AND THAT THE
ABOVE MAP IS A TRUE REPRESENTATION THEREOF AND SHOWS THE SIZE AND LOCATION OF THE PROPERTY AND ITS
EXTERIOR BOUNDARIES. THIS SURVEY IS MADE FOR THE USE OF THE PRESENT OWNERS OF THE PROPERTY, AND
ALSO THOSE WHO PURCHASE, MORTGAGE, OR GUARANTEE THE TITLE THERETO WITHIN ONE YEAR FROM THE DATE
HEREOF.

DATED: 09/07/2017

PETER S. GORDON P.L.S. 2101

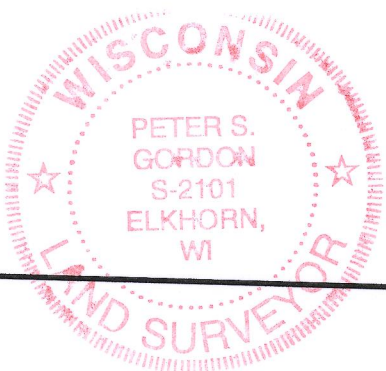

LEGEND

- = FOUND IRON PIPE STAKE
- = SET IRON REBAR STAKE
- (XXX) = RECORDED AS
- FF = FIRST FLOOR ELEVATION
- TF = TOP OF FOUNDATION
- GE = GARAGE ENTRY ELEVATION
- TC = TOP OF CONCRETE

PROJECT: 9252.118
DATE: 09/07/2017
SHEET 1 OF 1

SEP 07 2017 YPI -118

004-2020