

FARRIS, HANSEN & ASSOCIATES, INC.

ENGINEERING — ARCHITECTURE — SURVEYING
7 RIDGWAY COURT — P.O. BOX 437 — ELKHORN, WISCONSIN 53121
PHONE: (262) 723-2098 FAX: (262) 723-5886

PLAT OF SURVEY

LOT 112 OF ELKHORN WEST ADDITION NO. 2

LOCATED IN PART OF THE NE 1/4 OF THE SE 1/4 OF SECTION 35
TOWN 3 NORTH, RANGE 16 EAST, CITY OF ELKHORN, WALWORTH COUNTY, WISCONSIN

— WORK ORDERED BY —
DAN CARMODY
5803 GLEN HAVEN DRIVE
GREENDALE, WI. 53129

SUBDIVISION PLAT
BEARING BASIS

AS BUILT
FOUNDATION

Y.G.=1040.2'
T.F.=1040.9'

LOT 111

LOT 106

LOT 105

LOT 112

10,615 S.F.

PROPOSED RESIDENCE
T.F. = 1042.8'
Y.G. = 1042.2'

12' WIDE UTILITY EASEMENT
CENTERED ON LOT LINE

WATER CREST COURT
66' WIDE R.O.W.

8" WATERMAIN
8" SANITARY SEWER

BENCH MARK
CHISELED V
BOC EL. = 1039.34'

LOT 113

AS BUILT RESIDENCE
Y.G. = 1043.0'
T.F. = 1043.5'

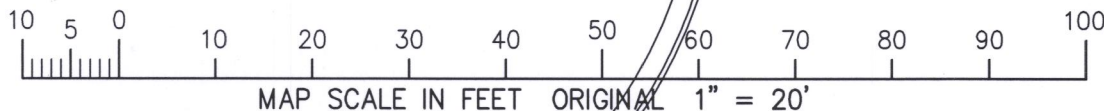
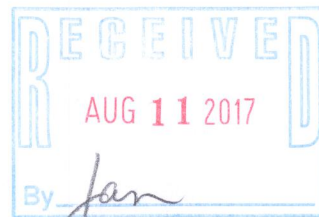

NOTE: COPIES OF THIS MAP TO WHICH THE FOLLOWING CERTIFICATE WILL APPLY SHOW THE SURVEYOR'S ORIGINAL SEAL AND SIGNATURE IN RED INK. COPIES BY ANY OTHER MEANS MAY HAVE ALTERATIONS WHICH DO NOT REPRESENT THE SURVEYOR'S WORK PRODUCT.

I HEREBY CERTIFY THAT THE ABOVE DESCRIBED PROPERTY HAS BEEN SURVEYED UNDER MY DIRECTION AND THAT THE ABOVE MAP IS A TRUE REPRESENTATION THEREOF AND SHOWS THE SIZE AND LOCATION OF THE PROPERTY AND ITS EXTERIOR BOUNDARIES. THIS SURVEY IS MADE FOR THE USE OF THE PRESENT OWNERS OF THE PROPERTY, AND ALSO THOSE WHO PURCHASE, MORTGAGE, OR GUARANTEE THE TITLE THERETO WITHIN ONE YEAR FROM THE DATE HEREOF.

DATED: SEPTEMBER 12, 2005

REVISED 08-02-2017
TO SHOW PROPOSED RESIDENCE

PETER S. GORDON R.L.S. 2101

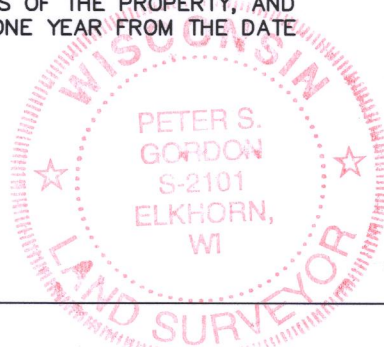

LEGEND

- = SET IRON REBAR STAKE
- = FOUND IRON PIPE STAKE
- (XXX) = RECORDED AS
- T.F. = TOP OF FOUNDATION GRADE
- Y.G. = YARD GRADE

PROJECT: 6103.02.112
DATE: 09/12/2005
SHEET 1 OF 1

YEW2-112

004-2614