

PLAT OF SURVEY

LOT 61 OF THE PINES OF ELKHORN
CITY OF ELKHORN, WALWORTH COUNTY, WI

— WORK ORDERED BY —
THE TRACY GROUP
525 KENOSHA STREET, SUITE D
WALWORTH, WI 53184

FARRIS, HANSEN & ASSOCIATES, INC.
ENGINEERING – ARCHITECTURE – SURVEYING
7 RIDGWAY COURT P.O. BOX 437
ELKHORN, WISCONSIN 53121
OFFICE: (262) 723-2098 FAX: (262) 723-5886

REVISIONS

PROJECT NO.
9252.61

DATE:
2/14/2017

SHEET NO.
1 OF 1

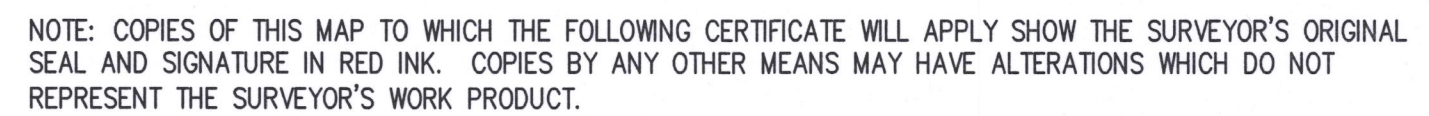



I HEREBY CERTIFY THAT THE ABOVE DESCRIBED PROPERTY HAS BEEN SURVEYED UNDER MY DIRECTION AND THAT THE ABOVE MAP IS A TRUE REPRESENTATION THEREOF AND SHOWS THE SIZE AND LOCATION OF THE PROPERTY AND ITS EXTERIOR BOUNDARIES. THIS SURVEY IS MADE FOR THE USE OF THE PRESENT OWNERS OF THE PROPERTY, AND ALSO THOSE WHO PURCHASE, MORTGAGE, OR GUARANTEE THE TITLE THERETO WITHIN ONE YEAR FROM THE DATE HEREOF.

DATED: 02/14/17

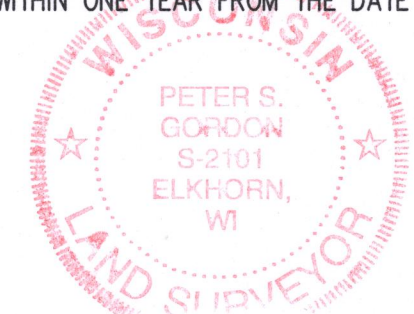
Peter S. Gordon
PETER S. GORDON P.L.S. 2101



LEGEND

	= FOUND IRON PIPE STAKE
	= SET IRON REBAR STAKE
(XXX)	= RECORDED AS
FF	= FIRST FLOOR ELEVATION
TF	= TOP OF FOUNDATION
GE	= GARAGE ENTRY ELEVATION
TC	= TOP OF CONCRETE

NOTE:
SEE AS-BUILT PLANS FOR THE
PINES FOR SANITARY SEWER AND
WATER CONNECTIONS (CITY
RECORDS).

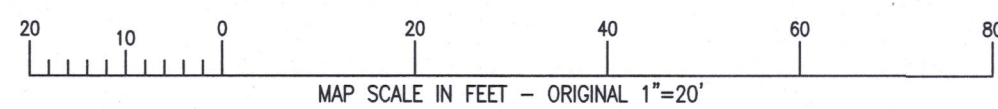

X:\Projects\9252\INVD LOTS\Lot_61\ACAD\9252_Lot61.dwg

YPI-61

004-2592