

Plat of Survey

of

Lot 16 of Harvest Pointe South,

a subdivision located in the Southwest 1/4 of Section 30, Town 3 North, Range 17 East, City of Elkhorn, Walworth County, Wisconsin.

Surveyed for: **Nommensen Law Offices**

15 South Lincoln Street * Unit 2
Elkhorn, Wisconsin. 53121



Bearings reference to the plat
of Harvest Pointe South.

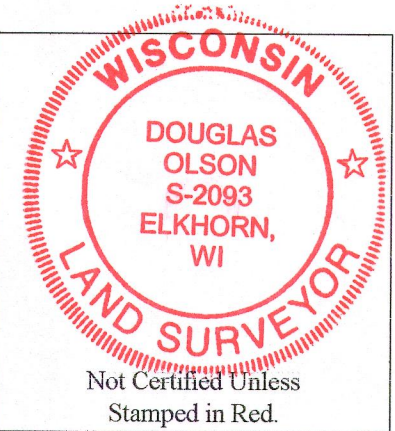

Notes:

- 1) This survey plat is not certified unless signed and sealed in red ink.
- 2) This survey is subject to Wisconsin lien laws. This Plat of Survey is the notice of intent to file lien. Lien waiver required.

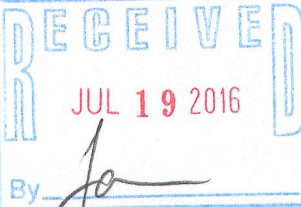

Copyright 2016 by Olson Land Surveying, LLC.

All rights reserved. No part of this survey plat may be reproduced or transmitted in any form by any means - graphic, electronic, or mechanical, including photocopying, tracing, or information storage and retrieval systems - without permission in writing from Douglas G. Olson, Olson Land Surveying, LLC.

I hereby certify that I have surveyed the above described property and the map hereon is correct to the best of my professional knowledge and belief and shows the size and location of the property, its exterior boundaries, the location and dimensions of all visible structures thereon, boundary fences, apparent easements and roadways and visible encroachments, if any.

This survey is made for the exclusive use of the present owners of the property, and also those who purchase, mortgage or guarantee title thereto, within one year from the date hereof.

Douglas G. Olson
Wisconsin Professional Land Surveyor - 2093

Survey Date: February 29, 2016.
Revisions:

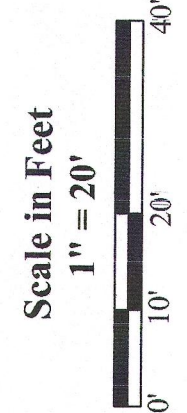

Olson Land Surveying, LLC



45 South Wisconsin Street * P.O. Box 322 * Elkhorn, Wisconsin. 53121
Telephone: (262) 723-3434 * Facsimile: (262) 723-8044
Email: doug@olsonsurveying.com

Legend

- Found Iron Pipe, 2" dia.
- Found Iron Pipe, 1" dia.
- Recorded Information
- Utility Box or Pedestal
- Manhole
- Fire Hydrant
- Asphalt Surface
- Concrete
- Brick Pavers

Sheet 1 of 1 Sheets

Job Reference Number

2016.016

2016.016

YHP8-16 004-2518