

Property Exhibit

of a portion of

A parcel of land described in a Warranty Deed recorded May 18, 2015 as Document No. 904710 as shown below:

Part of the Northwest Quarter of Section 6, Town 2 North, Range 17 East, more particularly described as follows: Commencing on the Southwest corner of Harmony Acres Subdivision in the City of Elkhorn, Walworth County, Wisconsin; thence South 01°27' West along the East line of Getzen Street, 588.39 feet to the South line of Centralia Street; thence South 69°02' East along said South line of said Centralia Street, 215.00 feet to the place of beginning of land hereinafter described, to-wit: Thence continue South 69°02' East along said South line of said Centralia Street, 250.00 feet; thence South 00°47' West 672.67 feet to the North line of the C.M. St. P. & P. Railroad; thence North 69°12' West along said North line of said Railroad, 249.74 feet; thence North 00°47' East 673.45 feet to the place of beginning.

Prepared for: Elkhorn Investors  
W8861 Creek Road  
Darien, Wisconsin. 53114

Storm Catch Basin  
Rim Elev.=98.44  
Inv. Elev.=92.4

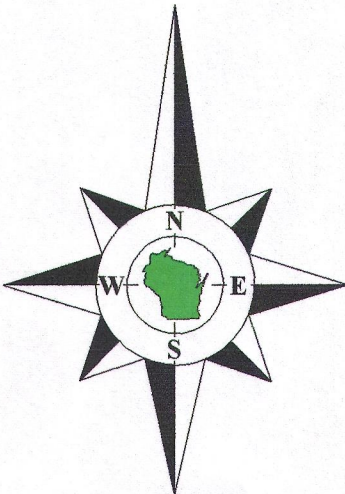

Bearings reference to previous surveys of record.

Tax Parcel  
YV SE 00009J

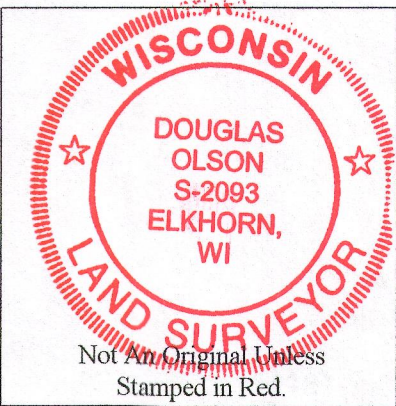

Notes:

- 1) This Property Exhibit is not an original unless signed and sealed in red ink.
- 2) This exhibit is subject to Wisconsin lien laws. This Property Exhibit is the notice of intent to file lien. Lien waiver required.

Copyright 2015 by Olson Land Surveying, LLC.

All rights reserved. No part of this survey plat may be reproduced or transmitted in any form by any means - graphic, electronic, or mechanical, including photocopying, tracing, or information storage and retrieval systems - without permission in writing from Douglas G. Olson, Olson Land Surveying, LLC.

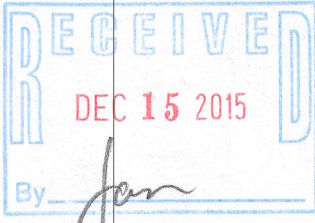

Tax Parcel  
YV SE 00009F

Tax Parcel  
YV SE 00009H

Tax Parcel  
YV SE 00009E

Tax Parcel  
YV SE 00009I  
Approx. 3.6 Acres

Building  
No. 427

Benchmark  
Nail set in pavement  
elevation assumed 100.00

Former Chicago, Milwaukee, St. Paul & Pacific Railroad  
(99' Wide)

2015.069

Sheet 1 of 1 Sheets

Drawing Name:

Job Reference Number  
2015.069

Legend

- Found County Section Corner
- Found Iron Pipe
- Set Iron Pipe, 1" dia.
- Recorded Information
- Utility Pole
- Utility Pedestal
- Fire Hydrant
- Manhole
- Catch Basin
- Asphalt Surface
- Concrete Surface
- Water Valve
- Deciduous Tree
- Flag Set by Eco-Resource Consulting, LLC



Olson Land Surveying, LLC

45 South Wisconsin Street \* P.O. Box 322 \* Elkhorn, Wisconsin. 53121  
Telephone: (262) 723-3434 \* Facsimile: (262) 723-8044  
Email: doug@olsonsurveying.com

Scale in Feet

1" = 30'

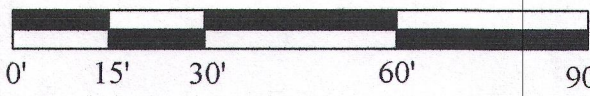

Survey date: August 4, 2015.

Revisions: No. 1 - Wetland Delineation

YV SE-9I 004-2492