

Northwest Corner of
the Northwest 1/4
of Section 6-2-17.
N. 247.619.81
E. 2392.342.22
EL. 1016.16

Point recorded as being the intersection of the
Easterly line of Lincoln Street and the Southerly
right of way line of the Chicago, Milwaukee,
St. Paul and Pacific Railroad Company.

Plat of Survey

of
Tax Parcel YV SE 00016A,
located in the Northwest 1/4 of Section 6, Town 2 North, Range
17 East, City of Elkhorn, Walworth County, Wisconsin.

Surveyed for: **JLARE, LLC.**
511 South Lincoln Street
Elkhorn, Wisconsin. 53121

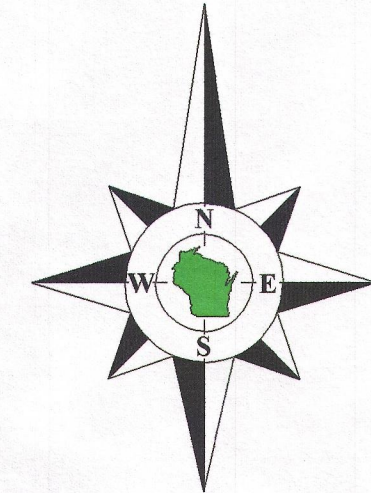

Bearings reference to the Wisconsin State
Plane Coordinate System, South Zone.

Legal Description

A parcel of land described in a Warranty Deed recorded February 14, 2003 as Document No. 544082 as shown below.
A parcel of land located in the Southwest One-quarter (1/4) of the Northwest One-quarter (1/4) of Section Six (6), commencing at the intersection of the E'ly line of Lincoln Street (formerly East Street and the S'ly right-of-way line of the Chicago, Milwaukee and St. Paul Railway, thence South along the E'ly line of Lincoln Street 316.45 feet to a point, being the Southwest corner of land conveyed by deed recorded April 25, 1960 in Volume 551, Page 523 to Paul F. King, thence West 33 feet to a point on the West line of said Section Six (6) and the place of beginning, thence East 522 feet to a point, thence South 180 feet to a point, thence West 522 feet to a point on the West line of Section Six (6); North 180 feet to the place of beginning, City of Elkhorn, County of Walworth, State of Wisconsin.

Tax Parcel
YV SE 00015A

Tax Parcel
YV SE 00016A

2.149 Acres
93,601 Sq.Ft.
2.012 Acres
87,661 Sq.Ft.
Exclusive of R.O.W.

Tax Parcel
YV SE 00016

State Trunk Highway 67 / Lincoln Street
(66' Wide)

NO°58'05"W 180.00'

SP°59'05"E 2688.48'
West line of the Northwest 1/4 of Section 6-2-17.
500.63'

NO°53'17"W 316.54'

178.50'

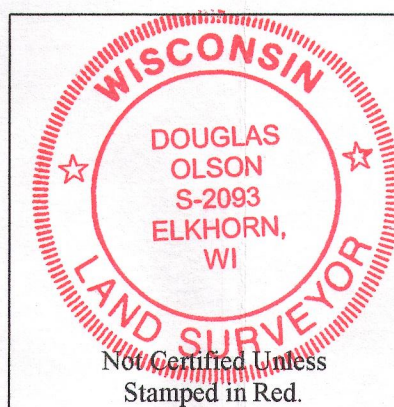

Notes:

- 1) This survey plat is not certified unless signed and sealed in red ink.
- 2) This survey is subject to Wisconsin lien laws. This Plat of Survey is the notice of intent to file lien. Lien waiver required.

Southwest Corner
of the Northwest 1/4
of Section 6-2-17.
N. 244.951.82
E. 2392.357.30
EL. 975.34

Copyright 2013 by Jensen & Olson Land Surveying, LLC.

All rights reserved. No part of this survey plat may be reproduced or transmitted in any form by any means - graphic, electronic, or mechanical, including photocopying, tracing, or information storage and retrieval systems - without permission in writing from Douglas G. Olson, Jensen & Olson Land Surveying, LLC.

I, Douglas G. Olson, Wisconsin Registered Land Surveyor, do hereby certify that this survey was performed by me, or under my direction in full compliance with the owner's/agent's instructions and Chapter A-E 7 of the Wisconsin Administrative Code "Minimum Standards for Property Surveys"; and that this map is an accurate representation thereof to the best of my knowledge and belief.

Douglas G. Olson
Wisconsin Registered Land Surveyor - 2093

Survey date: July 28, 2013.
Revisions:

Scale in Feet
1" = 20'

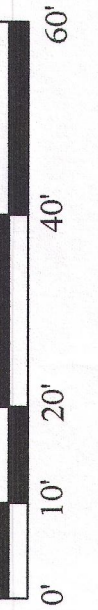

Jensen & Olson Land Surveying, LLC
45 South Wisconsin Street * P.O. Box 322 * Elkhorn, Wisconsin. 53121
Telephone: (262) 723-3434 * Facsimile: (262) 723-8044
Email: jensen.olson@elknet.net



Legend
Found County Section Corner
Found Iron Pipe
Recorded Information
Utility Box or Ped.
Manhole
Storm Drain
Water Valve
Spot Elevation
Concrete Surface
Asphalt Surface

Sheet 1 of 1 Sheets

Job Reference Number

2013.082

2013.082