

# FARRIS, HANSEN & ASSOCIATES, INC.

ENGINEERING — ARCHITECTURE — SURVEYING  
7 RIDGWAY COURT — P.O. BOX 437 — ELKHORN, WISCONSIN 53121  
PHONE: (262) 723-2098 FAX: (262) 723-5886

## PLAT OF SURVEY

PART OF THE NE 1/4 SEC. 36  
TOWN 3 NORTH, RANGE 16 EAST  
CITY OF ELKHORN  
WALWORTH COUNTY, WISCONSIN

— WORK ORDERED BY —  
CALEB JENSEN  
611 N. BROAD STREET  
ELKHORN, WI. 53121

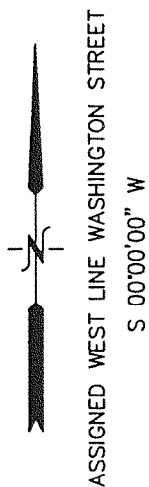

Starting at a point where the East and West 1/4 Section line of Section 36, Town 3 North, Range 16 East intersects the center line of Wisconsin Street in the City of Elkhorn, go North 132 feet to a point; thence East 198 feet to the place of beginning; thence East 132 feet to the center of Washington Street; thence North 66 feet to a point; thence West 132 feet to a point; thence South to the place of beginning, all in the City of Elkhorn, Walworth County, Wisconsin.

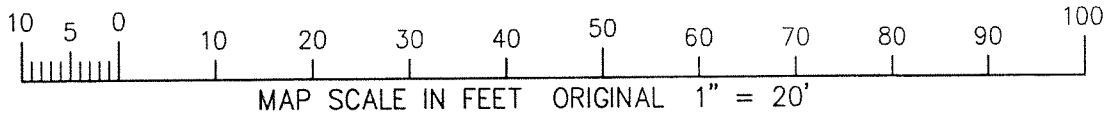
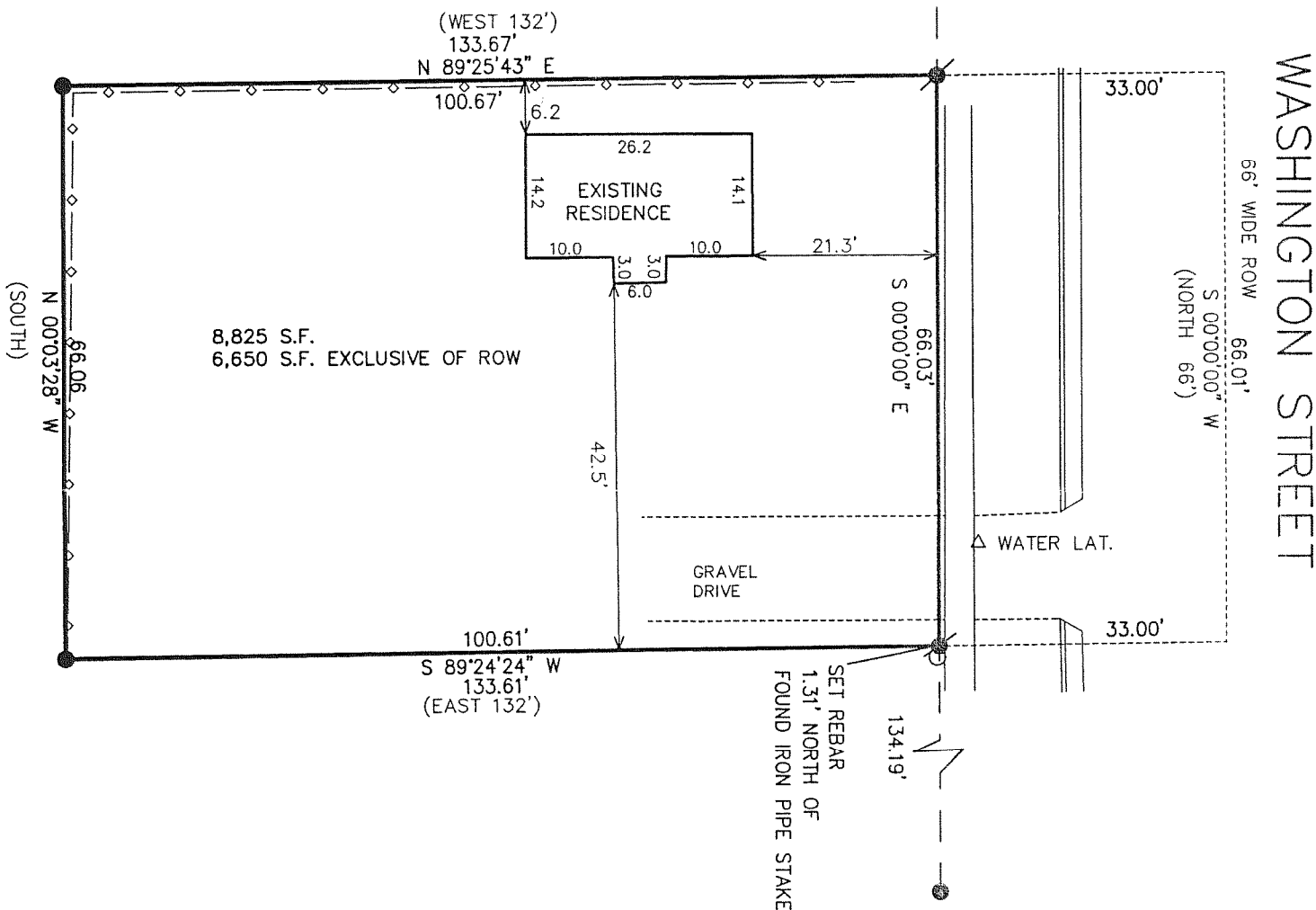

### LEGEND

- = FOUND IRON PIPE STAKE
- = FOUND IRON REBAR STAKE
- / = SET IRON REBAR STAKE

(XXX) = RECORDED AS

NOTE: COPIES OF THIS MAP TO WHICH THE FOLLOWING CERTIFICATE WILL APPLY SHOW SURVEYOR'S ORIGINAL SEAL AND SIGNATURE IN RED INK. COPIES BY ANY OTHER MEANS MAY HAVE ALTERATIONS WHICH DO NOT REPRESENT THE SURVEYOR'S WORK PRODUCT.

I HEREBY CERTIFY THAT THE ABOVE DESCRIBED PROPERTY HAS BEEN SURVEYED UNDER MY DIRECTION AND THAT THE ABOVE MAP IS A TRUE REPRESENTATION THEREOF AND SHOWS THE SIZE AND LOCATION OF THE PROPERTY AND ITS EXTERIOR BOUNDARIES. THIS SURVEY IS MADE FOR THE USE OF THE PRESENT OWNERS OF THE PROPERTY, AND ALSO THOSE WHO PURCHASE, MORTGAGE, OR GUARANTEE THE TITLE THERETO WITHIN ONE YEAR FROM THE DATE HEREOF.

DATED: JUNE 4, 2008

*Peter S. Gordon*  
PETER S. GORDON R.L.S. 2101

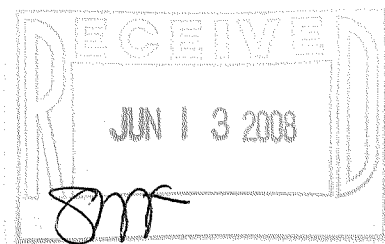

PROJECT: 7650  
DATE: 06-04-2008  
SHEET 1 OF 1