

Plat of Survey

of

A parcel of land described in a Warranty Deed recorded November 19, 2007 as Document No. 723928 as shown below:

Lands in the Northeast 1/4 of Section 6, Township 2 North, Range 17 East, City of Elkhorn, Walworth County, Wisconsin, described as follows: Beginning at a point in the East bounds of East Street in the village (Now City) of Elkhorn, at the Northwest corner of lot formerly belonging to John Hare, which was formerly a part of Lot E. Elderkin, and being the point where the North line of Rockwell Street produced would intersect the East line of East Street, thence North along the East line of East Street for four rods, thence East 3.33 chains to a post, thence South four rods to a post in the North line of said Edlerkin's land, thence West 3.33 chains to the place of beginning and being the land conveyed to Henry E. Babcock by deed of Julia Sherman dated May 26, 1897 and recorded in the Register of Deeds Office and and for Walworth County Wisconsin in Volume 93 of Deeds, Page 468.

Surveyed for: **Christopher Brown**
201 Bethoveen Drive
Westminster, Maryland. 21157

Lot 2
C.S.M. 1162

Tax Parcel
YEK 00009

Tax Parcel
YEK 00010
0.314 Acres
13,695 Sq.Ft.

Tax Parcel
YEK 00019

Tax Parcel
YEK 00011

Tax Parcel
YEK 00012

House
No. 123

Garage

Garage

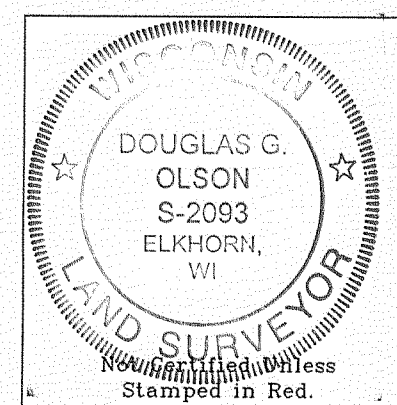

- Notes: 1) This survey plat is not certified unless signed and sealed in red ink.
2) This survey is subject to Wisconsin lien laws. This Plat of Survey is the notice of intent to file lien. Lien waiver required.

Copyright © 2008 by Jensen & Olson Land Surveying, LLC.

All rights reserved. No part of this survey plat may be reproduced or transmitted in any form by any means - graphic, electronic, or mechanical, including photocopying, tracing, or information storage and retrieval systems - without permission in writing from Douglas G. Olson, Jensen & Olson Land Surveying, LLC.

I, Douglas G. Olson, Wisconsin Registered Land Surveyor, do hereby certify that this survey was performed by me or under my direction in full compliance with the owner's/agent's instructions and Chapter A-E 7 of the Wisconsin Administrative Code "Minimum Standards for Property Surveys", and that this map is an accurate representation thereof to the best of my knowledge and belief.

Douglas G. Olson
Wisconsin Registered Land Surveyor - 2093

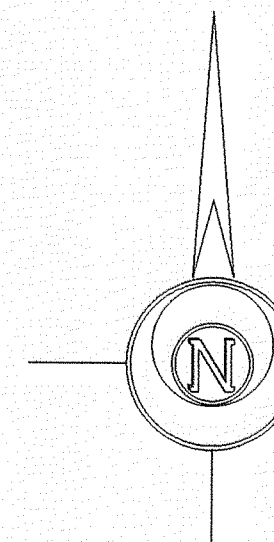

Bearings reference to the Wisconsin State Plane Coordinate System, South Zone.

Survey Date: April 1, 2008.
Revisions:

Scale in Feet
1" = 20'
0' 10' 20' 40'

Jensen & Olson Land Surveying, LLC
45 South Wisconsin Street
P.O. Box 322
Elkhorn, Wisconsin. 53121
Telephone (262) 723-3434
Facsimile (262) 723-8044

Legend
Found County Section Corner
Found Iron Pipe
Found Iron Rod
Set Lat
Recorded Information
Utility Pole
Asphalt Surface
Concrete

Sheet 1 of 1 Sheets
Job Reference Number
2008.027
2008.027

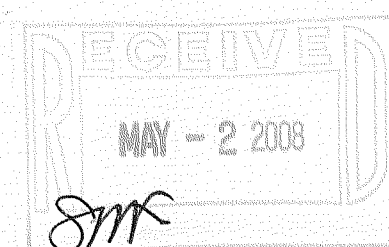

South Lincoln Street
(East Street)

Width Varies

Rockwell Street

Northwest Corner
Section 6-2-17.
N. 247.619.81
E. 2,392.342.22

West line of the Northwest 1/4 of Section 6-2-17.

(N0°58'05"W 2668.46') State Plane
S0°58'05"E 2668.46'

Concrete Curb & Gutter

Concrete Curb & Gutter

Sidewalk

Curb Cut

Curb Cut

Curb Cut

Curb Cut

Curb Cut

Curb Cut

Curb Cut

Curb Cut

Curb Cut

Curb Cut

Curb Cut

Curb Cut

Curb Cut

Curb Cut

Curb Cut

Curb Cut

Curb Cut

West 1/4 Corner
Section 6-2-17.
N. 244.951.82
E. 2,392.387.30

YEK-10

004-2204