

January 24, 2007

PLAT OF SURVEY

Survey No. 060589R
Simon Group
Spec. House

LOCATION: _____ Sugarpine Way, Elkhorn, Wisconsin

LEGAL DESCRIPTION:

Lot 144 in **THE PINES**, Located in the Northwest, Northeast, Southwest & Southeast 1/4's of the Southwest 1/4 & the Southwest & Northwest 1/4's of the Southeast 1/4 of Section 5, Town 2 North, Range 17 East, City of Elkhorn, Walworth County, Wisconsin.

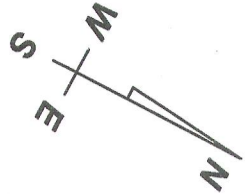

SCALE: 1" = 30'

Setback Requirements:
Front Yard = 20.00'
Side Yard = 10.00'
Rear Yard = 25.00'

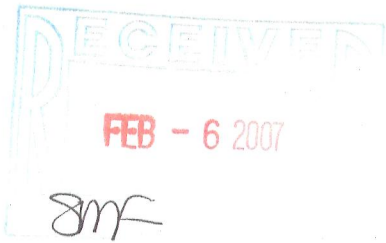

DRAWING BY: AW
FIELD WORK BY: JP

LANDCRAFT SURVEY AND ENGINEERING, INC.
REGISTERED LAND SURVEYORS AND CIVIL ENGINEERS
2077 South 116th Street, West Allis, WI 53227
PH. (414) 604-0674 FAX (414) 604-0677
INFO@LANDCRAFTSE.COM

Mortgage Inspection
Monumentation has been waived in
accordance with A-5 5.01 (b) of the
Wisconsin Administrative Code.

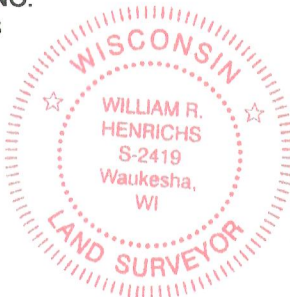

I HEREBY CERTIFY THAT I HAVE SURVEYED THE ABOVE DESCRIBED PROPERTY AND THAT THE ABOVE MAP IS A TRUE REPRESENTATION THEREOF AND SHOWS THE SIZE AND LOCATION OF THE PROPERTY, ITS EXTERIOR BOUNDARIES, THE LOCATION OF ALL VISIBLE STRUCTURES AND DIMENSIONS OF ALL PRINCIPAL BUILDINGS THEREON, BOUNDARY FENCES, APPARENT EASEMENTS AND ROADWAYS AND VISIBLE ENCROACHMENT, IF ANY.

THIS SURVEY IS MADE FOR THE EXCLUSIVE USE OF THE PRESENT OWNERS OF THE PROPERTY, AND ALSO THOSE WHO PURCHASE, MORTGAGE, OR GUARANTEE THE TITLE THERETO WITHIN ONE (1) YEAR FROM THE DATE HEREOF.

SIGNED

William R. Henrichs, Registered Land Surveyor S-2419

YPI-144

207-2108