

PLAT OF SURVEY



FOR: DAN CARMODY

DATE: 8/09/2003
DATE: 8/15/2003
ADDED ELEV.

DESCRIPTION:

LOT 85 OF ELKHORN WEST SUBDIVISION ADDITION NO. 1, LOCATED IN PART OF THE NE 1/4 AND SE 1/4 FO THE SE 1/4 OF SECTION 35, TOWN 3 NORTH, RANGE 16 EAST AND PART OF THE NE 1/4 OF THE NE 1/4 OF SECTION 2, TOWN 2 NORTH, RNAGE 16 EAST, CITY OF ELKHORN, WALWORTH COUNTY, WISCONSIN.

PROPOSED FINISHED
YARD GRADE=1045.50

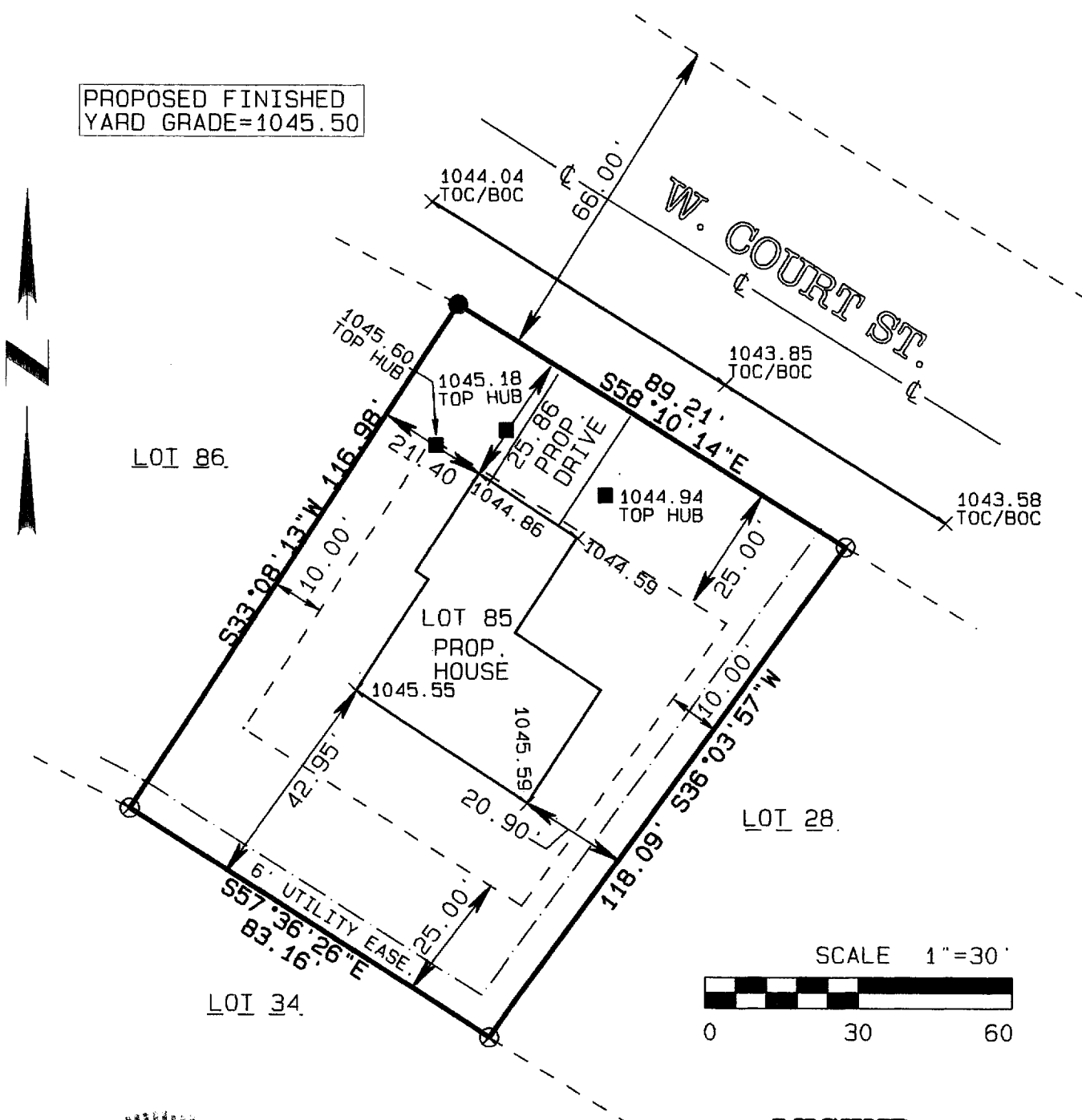

LEGEND

Symbol	Description
●	FOUND 1" IRON PIPE
⊗	FOUND 2" IRON PIPE
■	10' OFFSET HOUSE
×	SPOT ELEVATION
—C—	CENTER LINE ROAD

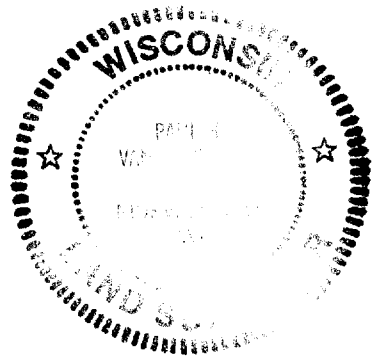

I PAUL H. VAN HENKELUM R.L.S. # 1931 HEREBY CERTIFY THAT THIS SURVEY WAS MADE IN ACCORDANCE WITH THE MINIMUM STANDARDS FOR PROPERTY SURVEYS (CHAPTER 4-E7) STATE OF WISCONSIN AND HAS BEEN PREPARED UNDER MY DIRECTION AND CONTROL AND IS CORRECT TO THE BEST OF MY KNOWLEDGE AND BELIEF.

Paul H. Van Henkelum 8/15/03
PAUL H. VAN HENKELUM R.L.S. #1931
RSV DATA6/BRADTDS03/J03109.PRO

NOV 18 2003

Yew

YEW1-85

004-1685