

Plat of Survey

of

Lands described in a Warranty Deed recorded in Vol. 665 on Page 1222 as Document No. 421093 as shown below:
The East 1/2 of Lots 11, 12 and 15 in Block 3 Preston Addition to the City of Elkhorn, Walworth County, Wisconsin excepting land conveyed to the City of Elkhorn in Warranty Deed recorded in Vol. 576 of Deeds on page 531 as Document No. 538077.

Surveyed for: **Tessa Maffei**
1268A Jenna Drive
South Elgin, Illinois. 60177

Note: Lots 11, 12 and 15 are shown as a retracement of a survey prepared by Thomas Jensen dated July 28, 1980.

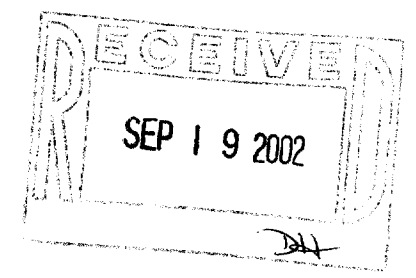
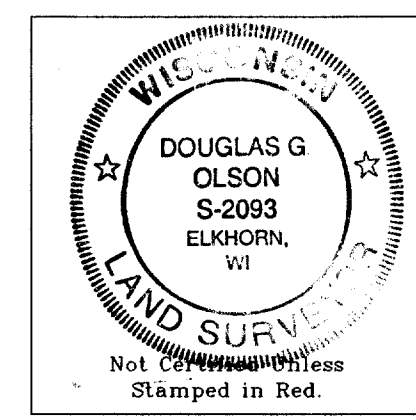
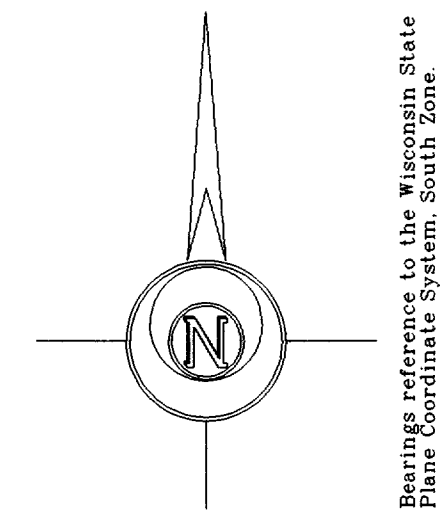

- Notes: 1) This survey plat is not certified unless signed and sealed in red ink.
2) This survey is subject to Wisconsin lien laws. This Plat of Survey is the notice of intent to file lien. Lien waiver required.

Copyright © 2002 by Jensen & Olson Land Surveying, LLC.

All rights reserved. No part of this survey plat may be reproduced or transmitted in any form by any means - graphic, electronic, or mechanical, including photocopying, tracing, or information storage and retrieval systems - without permission in writing from Douglas G. Olson, Jensen & Olson Land Surveying, LLC.

I hereby certify that I have surveyed the above described property and the map hereon is correct to the best of my professional knowledge and belief and shows the size and location of the property, its exterior boundaries, the location and dimensions of all visible structures thereon, boundary fences, apparent easements and roadways and visible encroachments, if any.
This survey is made for the exclusive use of the present owners of property, and also those who purchase, mortgage or guarantee title thereto, within one year from the date hereof.

Douglas G. Olson
Wisconsin Registered Land Surveyor - 2093

Survey Date: July 19, 2002.
Revisions:

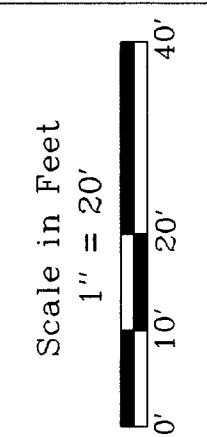

Jensen & Olson Land Surveying, LLC
45 South Wisconsin Street
Elkhorn, Wisconsin. 53121
Telephone (262) 723-3434
Facsimile (262) 723-8044

- Legend
- Found Iron Pipe
 - Found Iron Rod
 - Set Iron Rod, 3/4" dia.
 - Recorded Information
 - Water Valve
 - Concrete Surface
 - Gravel Surface

Sheet 1 of 1 Sheets
Job Reference Number
2002.130
2002.130

004-1520