

**PLAT OF SURVEY  
"PROPOSED GRADING PLAN"**

LOT 56, HARVEST POINTE, being a part of Lot 4 of Certified Survey Map No. 2083, and a part of the Northeast 1/4, Northwest 1/4, Southeast 1/4 and the Southwest 1/4 of the Southwest 1/4 of Section 30, Town 3 North, Range 17 East, City of Elkhorn, Walworth County, Wisconsin.

Surveyed for: Bielinski Brothers Builders/James and Patricia Terrell  
Suggested yard grade per grading plan: 1013.7

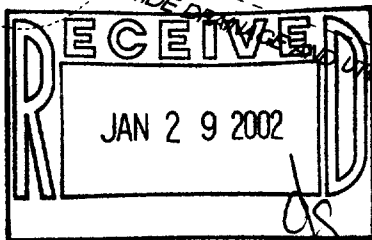
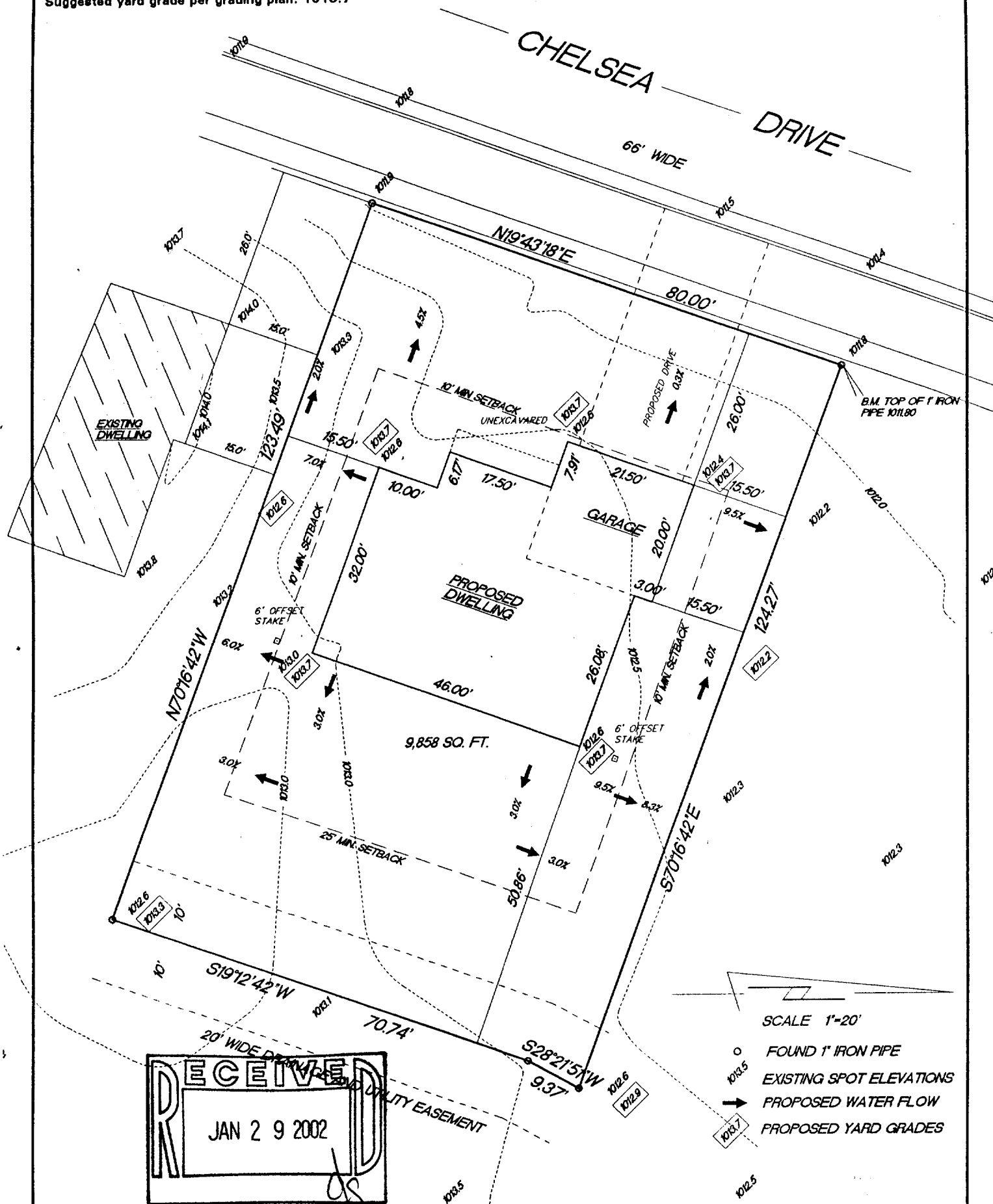

"I hereby certify that I have surveyed the above described property and that the above map is a true representation thereof and shows the size and location of the property, its exterior boundaries, the location of all visible structures and dimension of all principal buildings thereon, boundary fences, apparent easements, roadways and encroachments if any."

"This survey is made for the use of the present owners of the property, and also those who purchase, mortgage or guarantee the title thereto within one year from date hereof."

**KETTLE MORaine SURVEYING**  
W356 S9050 Godfrey Lane  
Eagle Wisconsin 53119  
P.O. Box 357  
(262) 594-3484  
Terrance E. Pisarek R.L.S.

THIS IS NOT AN ORIGINAL SURVEY UNLESS THE SEAL IS RED.

1/8/02

DATE

TEP/DW

FIELD WORK BY

TEP

DRAWN BY

02001

JOB NUMBER

YHP-56

4-1430