

ABERNATHY and ASSOCIATES

Kenneth B. Abernathy Jr.

Wisconsin Registered Land Surveyor S-1594

Rt. 3, Box 273
Elkhorn, Wisconsin 53121
Phone: (414) 723 4260 (office)
(414) 723 7209 (FAX)

PLAT OF SURVEY

Ordered by: Attorney Robert C. Leibsle
Godfrey, Neshek, Worth, & Leibsle SC
11 North Wisconsin Street
Elkhorn, Wisconsin 53121

OWNER: ARROW PRODUCTS, INC.
P.O. BOX 909
LAKE GENEVA, WI. 53147

LEGAL DESCRIPTION AS FOUND IN VOL. 629, PAGE 6315, DOC. # 282747 WALWORTH COUNTY RECORDS

A PARCEL OF LAND LOCATED IN PART OF THE NORTHEAST 1/4 AND THE SOUTHEAST 1/4 OF THE NORTHWEST 1/4 OF SECTION 7, TOWN 2 NORTH, RANGE 17 EAST, WALWORTH COUNTY, WISCONSIN DESCRIBED AS FOLLOWS: COMMENCING AT A CONCRETE MONUMENT FOUND MARKING THE NORTHWEST CORNER OF SAID SECTION 7; THENCE S 1°14'32" E 1188.51 FEET ALONG THE WEST LINE OF SAID NORTHWEST 1/4; THENCE N 88°45'29" E 80.00 FEET TO THE EASTERLY RIGHT OF WAY OF STATE TRUNK HIGHWAY "67" AND THE CENTERLINE OF COMMERCE COURT; THENCE S 1°14'32" E 692.69 FEET ALONG SAID S.T.H. "67", TO THE NORTHERLY RIGHT-OF-WAY OF O'CONNOR DRIVE; THENCE ALONG SAID O'CONNOR DRIVE, N 87°06'33" E 553.12 FEET; THENCE CONTINUE 491.73 FEET ALONG THE ARC OF A CURVE TO THE RIGHT HAVING A RADIUS OF 1535.45 FEET AND A CHORD WHICH BEARS S 83°42'58" E, 489.63 FEET; THENCE CONTINUE S 74°32'31" E 217.62 FEET; THENCE N 0°06'43" W 554.00 FEET TO THE POINT OF BEGINNING; THENCE N 0°06'43" W 269.03 FEET; THENCE N 89°53'17" E 515.69 FEET TO THE WESTERLY RIGHT-OF-WAY OF A PUBLIC ROAD (O'CONNOR DRIVE-KOOPMAN LANE); THENCE ALONG SAID ROAD S 8°40'58" E 107.03 FEET; THENCE CONTINUE 164.09 FEET ALONG THE ARC OF A CURVE TO THE RIGHT HAVING A RADIUS 1682.00 FEET AND A CHORD WHICH BEARS S 5°53'17" E, 164.02 FEET; THENCE S 89°53'17" W 548.15 FEET TO THE POINT OF BEGINNING.

NW CORNER SEC. 7-2-17

C.S.M. 3110

NOTE:

THE NORTHWEST PROPERTY CORNER IS COVERED WITH DIRT PILES FROM CONSTRUCTION ON C.S.M. 3110 ON 5-24-99.

DIRT PILES ARE GONE AS OF MAY, 12, 2001 AND IRON ROD SET AT PROPERTY CORNER.

N 89°53'17" E 515.69'

UTILITY PEDESTAL

KOOPMAN LANE
66' WIDE

TAX KEY NO. YV SE 000246
143,745 SQ. FT. (3.30 ACRES)
(V A C A N T L A N D)

UTILITY PEDESTALS

A.K.A. O'CONNOR DR.

TAX KEY NO. YV SE 00024

POINT OF BEGINNING

FIRE HYDRANT

S 89°53'17" W 548.15'

TAX KEY NO. YV SE 00024F

Legend

- FOUND IRON PIPE
- FOUND IRON ROD
- FOUND BRASS CAPPED MONUMENT
- FOUND CONCRETE MONUMENT
- CHISEL CUT IN CONCRETE
- SET IRON ROD, 24" LONG, WEIGHING 15 LBS. LINEAL FT. 3/4" DIA.
- SET IRON ROD, 30" LONG, WEIGHING 45 LBS. LINEAL FT. 1 1/4" DIA.
- (---) RECORDED AS DIMENSION EXISTING FENCE

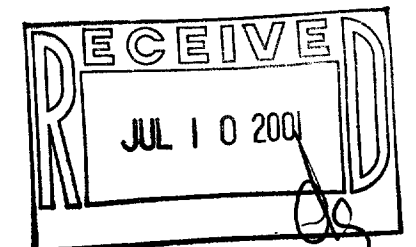

SCALE: 1" = 50 FEET

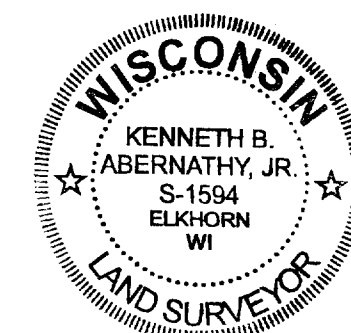

REVISED AND RECERTIFIED
ON MAY, 12, 2001.

Kenneth B. Abernathy, Jr.
KENNETH B. ABERNATHY, JR.
WISCONSIN REGISTERED LAND SURVEYOR,
S-1594
Date: MAY 25, 1999 Job No. 99.516

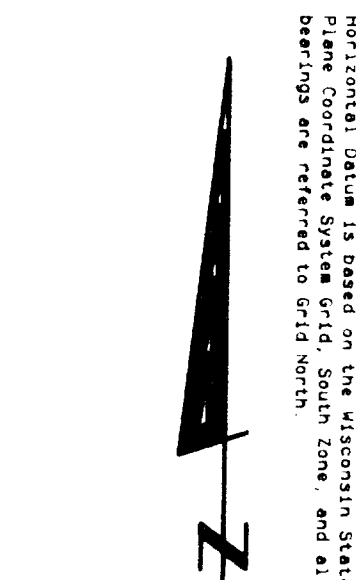

SCALE: 1 INCH = 50 FEET

Horizontal datum is based on the Wisconsin State Plane Coordinate System, South Zone, and all bearings are referred to grid north.

YVSE-246

004-1391