

Plat of Survey

of

Lot 13 of Alder Subdivision,
located in the Northwest 1/4 of Section 1, Twp 2 North, Range
16 East, City of Elkhorn, Walworth County, Wisconsin.

Surveyed for: **Ted McMillan**
11 South Church Street
Elkhorn, Wisconsin 53121

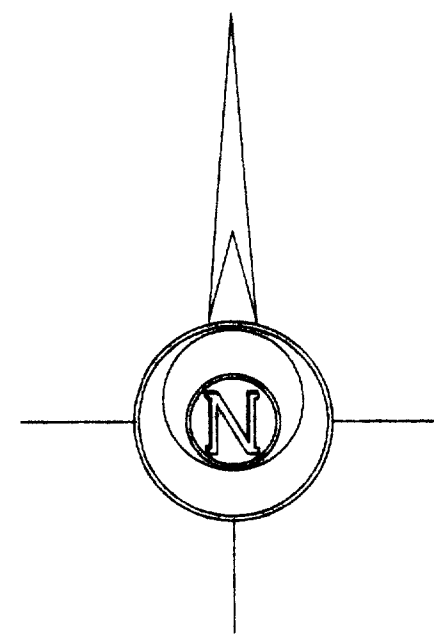

Bearings referenced to the
plat of Alder Subdivision.

Lot 14

N 89°30'35" E 170.00'

N 20°03'46" E 110.00'
10' Wide Utility Easement

Lot 13
0.453 Acres
19,728 Sq.Ft.

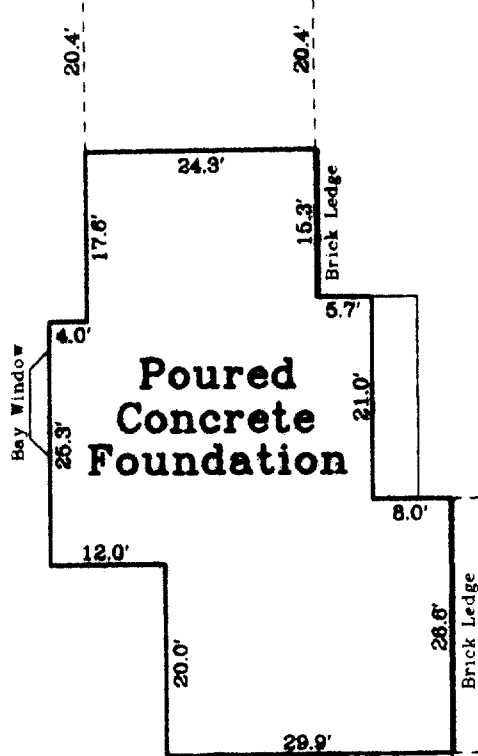

**Poured
Concrete
Foundation**

Garage

N 89°56'31" W 209.05'

S 00°43'14" E 105.00'

Park Street (66' Wide)

Lot 12

**House
No. 224**

35.6'

35.1'

216.07'

Centralia Street

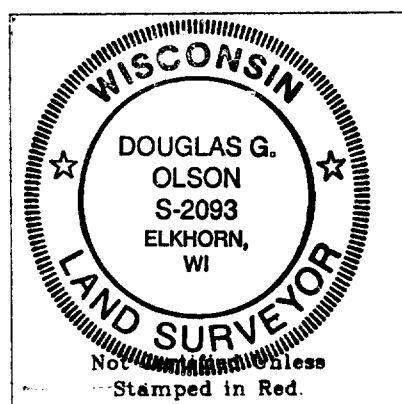
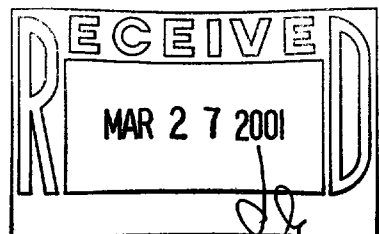

Notes: 1) This survey plat is not
certified unless signed
and sealed in red ink.

2) This survey is subject to Wisconsin lien laws.
This Plat of Survey is the notice of intent
to file lien. Lien waiver required.

Copyright © 2000 by Jensen & Olson Land Surveying, LLC.

All rights reserved. No part of this survey plat may be reproduced
or transmitted in any form by any means - graphic, electronic, or
mechanical, including photocopying, tracing, or information storage
and retrieval systems - without permission in writing from Douglas
G. Olson, Jensen & Olson Land Surveying, LLC.

I, Douglas G. Olson, Wisconsin Registered Land Surveyor,
do hereby certify that this survey was performed by me or under my
direction in full compliance with the owner's/agent's instructions
and Chapter A-E 7 of the Wisconsin Administrative Code "Minimum
Standards for Property Surveys", and that this map is an accurate
representation thereof to the best of my knowledge and belief.

Douglas G. Olson
Wisconsin Registered Land Surveyor - 2093

YALD-13 004-1337

Sheet 1 of 1 Sheets

Job Reference Number

2000.127

Legend

- Found Iron Rod, 1 3/16" dia.
- Found Iron Rod, 3/4" dia.
- Recorded Information
- Utility Pedestal
- Manhole
- Asphalt Surface
- Catch Basin
- Concrete Surface

Jensen & Olson Land Surveying, LLC

45 South Wisconsin Street P.O. Box 322
Elkhorn, Wisconsin 53121
Telephone (262) 723-3434
Facsimile (262) 723-8044

Scale in Feet
1" = 20'



Survey Date: Sept. 14, 2000.
Revisions:

Plat of Survey

of

Lot 13 of Alder Subdivision,
located in the Northwest 1/4 of Section 1, Town 2 North, Range
16 East, City of Elkhorn, Walworth County, Wisconsin.

Surveyed for: **Ted McMillan**
11 South Church Street
Elkhorn, Wisconsin. 53121

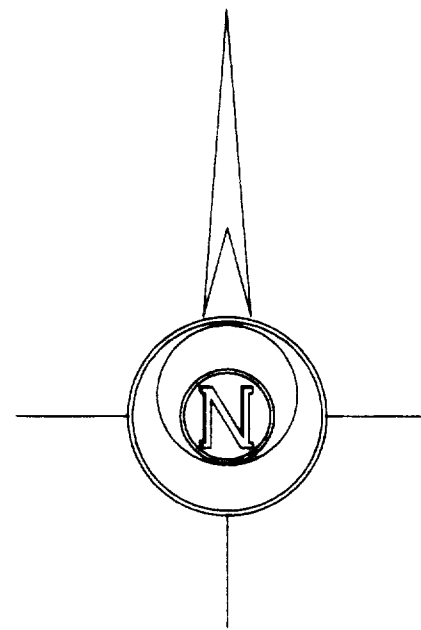

Bearings referenced to the
Plat of Alder Subdivision.

Lot 14

N 89°30'35" E 170.00'

Lot 13
0.453 Acres
19,728 Sq.Ft.

N 20°03'46" E 110.00'

10' Wide Utility Easement

N 89°56'31" W 209.05'

S 00°43'14" E 105.00'

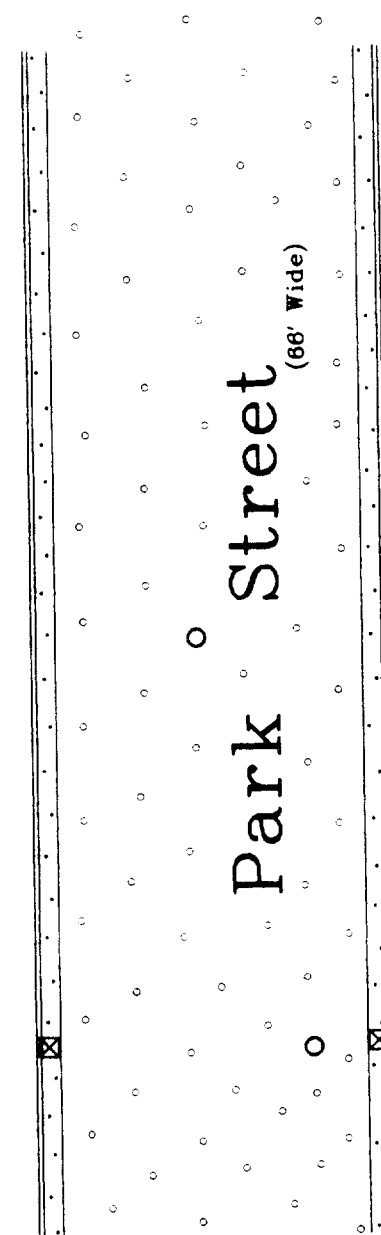

Garage

Lot 12

House
No. 224

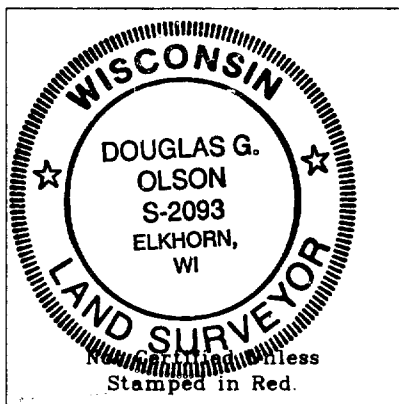
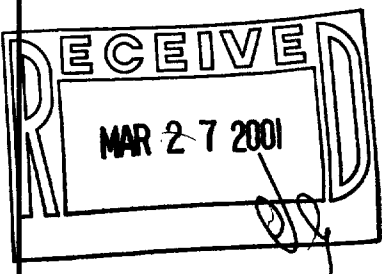

Notes: 1) This survey plat is not
certified unless signed
and sealed in red ink.

2) This survey is subject to Wisconsin lien laws.
This Plat of Survey is the notice of intent
to file lien. Lien waiver required.

Copyright © 2000 by Jensen & Olson Land Surveying, LLC.

All rights reserved. No part of this survey plat may be reproduced
or transmitted in any form by any means - graphic, electronic, or
mechanical, including photocopying, tracing, or information storage
and retrieval systems - without permission in writing from Douglas
G. Olson, Jensen & Olson Land Surveying, LLC.

I, Douglas G. Olson, Wisconsin Registered Land Surveyor,
do hereby certify that this survey was performed by me or under my
direction in full compliance with the owner's/agent's instructions
and Chapter A-E 7 of the Wisconsin Administrative Code "Minimum
Standards for Property Surveys"; and that this map is an accurate
representation thereof to the best of my knowledge and belief.

Douglas G. Olson
Wisconsin Registered Land Surveyor - 2093

Centralia Street

2000.110

Sheet 1 of 1 Sheets

Job Reference Number

2000.110

Legend

- Found Iron Rod, 1 3/16" dia.
- Found Iron Rod, 3/4" dia.
- Recorded Information
- Utility Pedestal
- Manhole
- Asphalt Surface
- Catch Basin
- Concrete Surface



Jensen & Olson Land Surveying, LLC

45 South Wisconsin Street P.O. Box 322
Elkhorn, Wisconsin. 53121
Telephone (262) 723-3434
Facsimile (262) 723-8044

Scale in Feet
1" = 20'

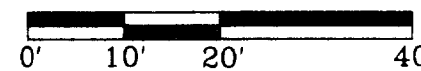

Survey Date: August 11, 2000.

Revisions: