

MAY 16 2000

FOUND IRON BAR STAKE IN CONCRETE 99.37' SOUTHERLY OF THE SOUTH LINE OF BLOCK 20 AND 0.57' WESTERLY OF THE WEST LINE OF BLOCK 20

FOUND CHISLED "X" IN FLANGE OF CURB

WISCONSIN STREET

COURT STREET

BLOCK 20

WASHINGTON STREET

WALWORTH STREET

MAP SCALE IN FEET ORIGINAL 1" = 30'

MAP SCALE IN FEET ORIGINAL 1" = 10'

WISCONSIN STREET  
66' WIDE R.O.W.

ASSIGNED THE WEST LINE OF BLOCK 20  
N 00°00'00" E

PAVEMENT  
CONCRETE

CONCRETE SIDEWALK

PAVEMENT  
CONCRETE

# PLAT OF SURVEY

THE NORTH 55.72' OF THE SOUTH 56.22' OF  
LOT 7 OF BLOCK 20 OF THE ORIGINAL PLAT  
CITY OF ELKHORN, WALWORTH COUNTY, WISCONSIN

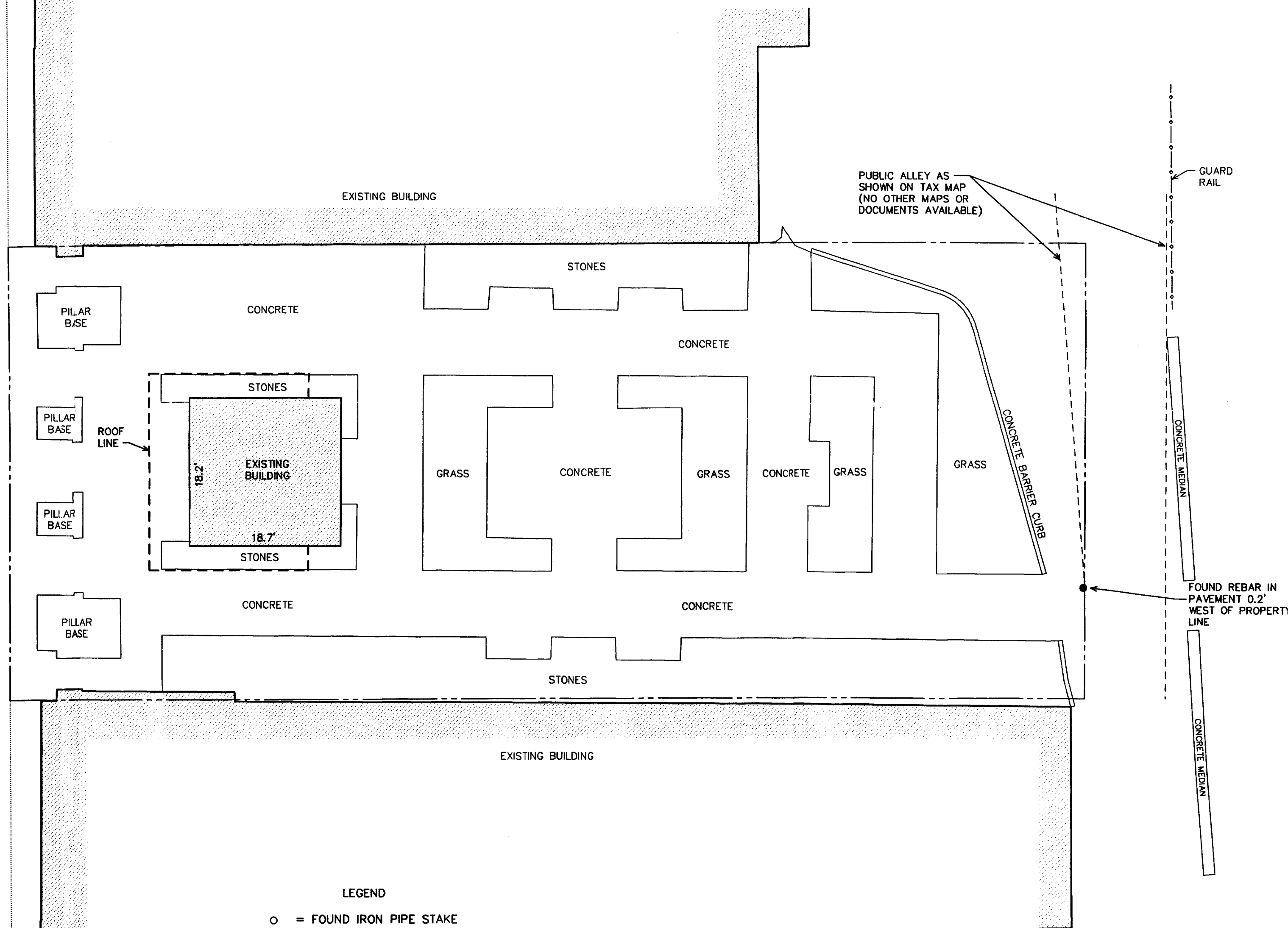

- LEGEND
- = FOUND IRON PIPE STAKE
  - = FOUND IRON REBAR STAKE
  - ⊙ = FOUND PIN IN CONCRETE
  - ⊕ = FOUND CHISLED "X" IN CONCRETE
  - ⊗ = SET CHISLED "X" IN CONCRETE
  - △ = SET "PK" NAIL IN PAVEMENT
  - {XXX} = RECORDED AS

NOTE: COPIES OF THIS MAP TO WHICH THE FOLLOWING CERTIFICATE WILL APPLY SHOW THE SURVEYOR'S ORIGINAL SEAL AND SIGNATURE IN RED INK. COPIES BY ANY OTHER MEANS MAY HAVE ALTERATIONS WHICH DO NOT REPRESENT THE SURVEYOR'S WORK PRODUCT.

I HEREBY CERTIFY THAT THE ABOVE DESCRIBED PROPERTY HAS BEEN SURVEYED UNDER MY DIRECTION AND THAT THE ABOVE MAP IS A TRUE REPRESENTATION THEREOF AND SHOWS THE SIZE AND LOCATION OF THE PROPERTY AND ITS EXTERIOR BOUNDARIES. THIS SURVEY IS MADE FOR THE USE OF THE PRESENT OWNERS OF THE PROPERTY, AND ALSO THOSE WHO PURCHASE, MORTGAGE, OR GUARANTEE THE TITLE THERETO WITHIN ONE YEAR FROM THE DATE HEREOF.

DATED: 5-16-2000

PETER S. GORDON  
PETER S. GORDON R.L.S. 2101

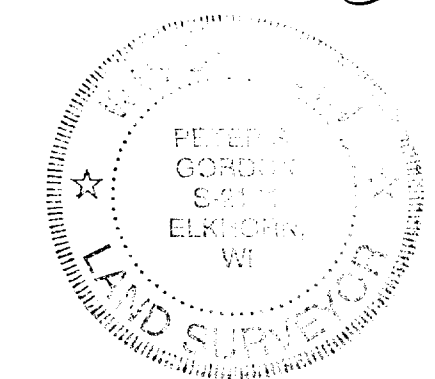
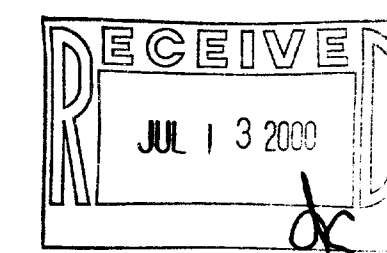

WORK ORDERED BY -  
DENISE HEGLAND  
BLANK ONE  
P.O. BOX 560  
ELKHORN, WI. 53121

FARRIS, HANSEN & ASSOCIATES, INC.  
ENGINEERING - ARCHITECTURE - SURVEYING  
7 RIDGEWAY COURT P.O. BOX 437  
ELKHORN, WISCONSIN 53121  
OFFICE: (262) 723-2088 FAX: (262) 723-5886

REVISIONS

PROJECT NO.  
5578

DATE  
05/16/2000

SHEET NO.  
1 OF 1

004-1308