

Broad Street  
(100' Wide)

# Plat of Survey

of

## Part of Lots 9 and 12 of Block 38 of Davis' Addition to the Village of Elkhorn,

located in the Northeast 1/4 of Section 36, Town 3 North, Range 16 East, City of Elkhorn, Walworth County, Wisconsin.

Described in a Warranty Deed recorded in Vol. 857 on Page 8057 as Document No. 394143 as shown below:

Beginning in the East line of Block 38 of Davis' Addition to the Village of Elkhorn, according to the plat of said addition recorded in the Register of Deeds Office in and for Walworth County, at a point 60 feet North, as measured along said block (said SE corner of said block being 6 feet South, measured along said East line, from an iron stake in the East line of said block); thence North in the East line of said block 60 feet; thence West parallel with the South line of said block 133.45 feet; thence South 60 feet to the Northwest corner of lands conveyed by H.M. Thompson and Stella D. Thompson, his wife, of Milwaukee, Wisconsin and John Dunphy and Philomena Dunphy, his wife, of Elkhorn, Wisconsin, to Charles Jahr and Almae Jahr, his wife, by Warranty Deed dated April 19, 1923; thence East parallel with the South line of said block, being in the North line of lands conveyed to Charles Jahr and Almae Jahr 133.38 feet to the place of beginning.

Surveyed for:

**Paul Holton c/o  
Mechanical Advantage Plumbing, Inc.**

501 Nathan Lane • Suite 1  
Elkhorn, Wisconsin 53121

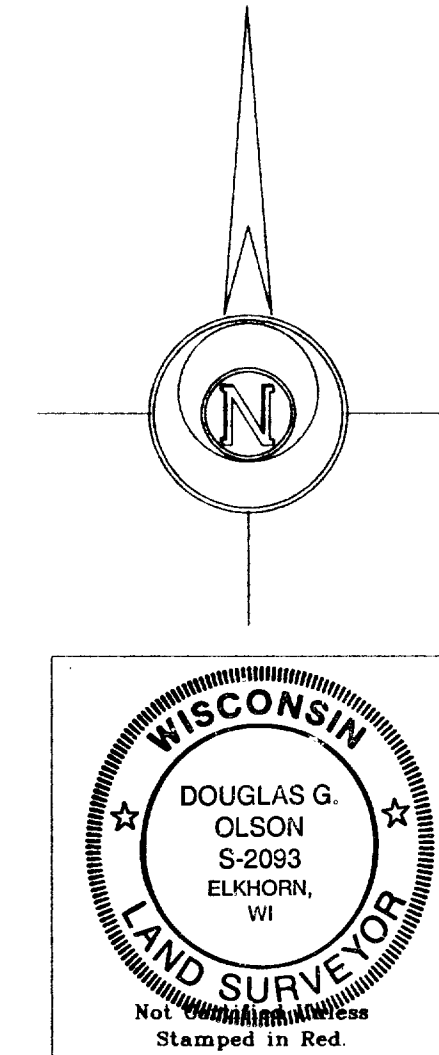

Bearings referenced to the West line of  
Broad Street, assumed as North.

- Notes: 1) This survey plat is not certified unless signed and sealed in red ink.
- 2) This survey is subject to Wisconsin lien laws. This Plat of Survey is the notice of intent to file lien. Lien waiver required.

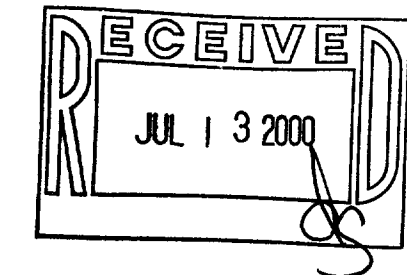

Copyright © 1999 by Jensen & Olson Land Surveying, LLC.

All rights reserved. No part of this survey plat may be reproduced or transmitted in any form by any means - graphic, electronic, or mechanical, including photocopying, tracing, or information storage and retrieval systems - without permission in writing from Douglas G. Olson, Jensen & Olson Land Surveying, LLC.

I, Douglas G. Olson, Wisconsin Registered Land Surveyor, do hereby certify that this survey was performed by me or under my direction in full compliance with owners' / agents' instructions and Chapter A-E 7 of the Wisconsin Administrative Code Minimum Standards for Property Surveys, and that this map is an accurate representation thereof to the best of my knowledge and belief.

Date: 12-24-99

Douglas G. Olson  
Wisconsin Registered Land Surveyor - 2093

Survey Date: Dec. 24, 1999.  
Revisions:

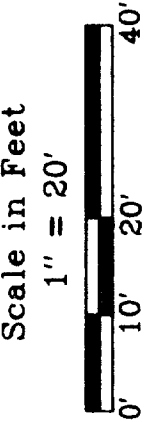

**Jensen & Olson Land Surveying, LLC**

45 South Wisconsin Street  
P.O. Box 322  
Elkhorn, Wisconsin 53121  
Telephone (262) 723-3434  
Facsimile (262) 723-8044

**Legend**

- Found Iron Pipe
- Found Iron Rod
- Set Iron Rod, 3/4" diameter
- Recorded Information
- Utility Pole
- Concrete Surface
- Asphalt Surface
- Fence

Sheet 1 of 1 Sheets

Job Reference Number  
**1999.154**

**1999.154**

004-1260

YD-22