

ABERNATHY and ASSOCIATES

Kenneth B. Abernathy Jr.

Wisconsin Registered Land Surveyor S-1594

Rt. 3, Box 273
Elkhorn, Wisconsin 53121
Phone: (414) 723 4260 (office)
(414) 723 7209 (FAX)

PLAT OF SURVEY

WEST 1/4 CORNER
SEC. 19-3-17

A PARCEL OF LAND LOCATED IN THE
SOUTHWEST 1/4 OF SECTION 19, TOWN
3 NORTH, RANGE 17 EAST, CITY OF
ELKHORN, WALWORTH COUNTY,
WISCONSIN.

OWNER: SWATEK ENTERPRISES, INC.
1050 CAREY ST.
LAKE GENEVA, WI. 53147

REFERENCE LEGAL DESCRIPTION

VOL. 362 P. 341 DOC. NO. 125522

(Byrne to Swatek Ent., Inc. dated Feb. 26, 1986)

A piece of parcel of real estate situated in the West 1/2 of the Southwest 1/4 of Section 19, Township 3 North, Range 17 East, and described as beginning at a point on the west line line of said Section 19 that is 1,042.06 feet North of the Southwest corner thereof; thence East parallel with the South line of Section 295.16 feet to a stake; thence North parallel with the West line of said Section 19, 295.16 feet to a stake; thence West parallel with the South line of said Section, 295.16 feet to a point in the West line of said section, being the center of the highway; thence South in said centerline 295.16 feet to the place of beginning. Stakes are set at point 9.1 feet East of the West line of said real estate so conveyed at the edge of the pavement on both the North and South lines thereof. Excepting therefrom that part of the above described premises awarded to the State Highway Commission for highway purposes as contained in Volume 625 of Deeds on page 420 as Document No. 574975.

SOUTHWEST CORNER
SEC. 19-3-17

C.S.M. 1726

GREEN AREA

EXISTING GRAVEL PARKING LOT

YUNE - 37

1.74 acres total

EXISTING BLACKTOP DRIVEWAY

CANOPY

PLANTER

GAS PUMPS

CONC.

EXISTING STORE

CONCRETE WALKWAY

EXISTING BLACKTOP DRIVEWAY

DIESEL PUMPS

CONCRETE

GREEN AREA

CONCRETE BASE

PUBLIC TELEPHONE

POWER POLE

EXISTING SIGN

DETAIL OF SIGN AREA

SCALE 1" = 20 FEET

PROPERTY LINE

HIGHWAY
REFERENCE LINE

PUBLIC TELEPHONE

CONC. BASE

45.00'

59.88'

EDGE OF BLACKTOP

POWER POLE

C.S.M. 1726

Legend

- FOUND IRON PIPE
- FOUND IRON ROD
- FOUND BRASS CAPPED MONUMENT
- FOUND CONCRETE MONUMENT
- CHISEL CUT IN CONCRETE
- SET IRON ROD, 24" LONG, WEIGHING 1.5 LBS., LINEAL FT., 3/4" DIA.
- SET IRON ROD, 30" LONG, WEIGHING 4.5 LBS., LINEAL FT., 1 1/4" DIA.
- RECORDED AS DIMENSION
- EXISTING FENCE

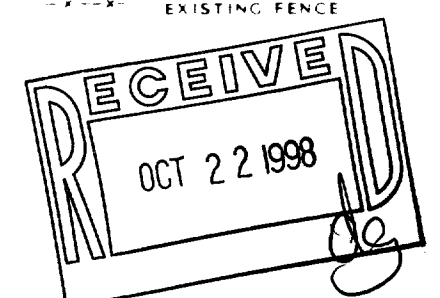

SCALE: 1" = 30 FEET

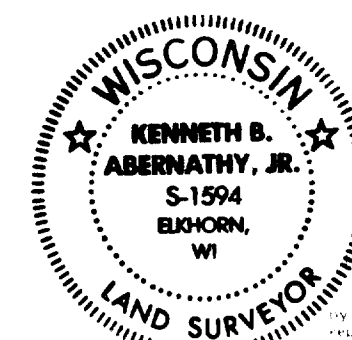

SCALE 1" = 30 FEET

HIGHWAY REFERENCE LINE OF PROJECT T 04-1(22) & VOL.
625 OF DEEDS, P. 420, DOC. # 574975

WIS. STATE HIGHWAY PLANS DATED
11-24-1964

Kenneth B. Abernathy, Jr.
WISCONSIN REGISTERED LAND SURVEYOR,
S-1594

Date: July 20, 1998 Job No. 98.704

004-1120
YUNE-37