

ABERNATHY and ASSOCIATES

Kenneth B. Abernathy Jr.

Wisconsin Registered Land Surveyor S-1594

W4056 Bray Road
Elkhorn, Wisconsin 53121
Phone: (414) 723-4260 (office)
(414) 723-7209 (fax)

PLAT OF SURVEY

OWNER: CONSUMERS COOPERATIVE OF WALWORTH COUNTY
230 S. WISCONSIN ST.
ELKHORN, WI. 53121
ATTN: RICH GASMANN, MANAGER

legal description

A part of Lot 2 of Block 23 of Rockwell's Addition to the Village (now city) of Elkhorn, Walworth County, Wisconsin, described as follows: Begin the Northwest corner of said Block 23; thence N 89°55'00" E along the north line of said Block 66.71 feet to a found iron pipe; thence S 0°11'31" W 83.25 feet to a set iron rod; thence S 89°52'37" W along the south line of Lot 2, 66.20 feet to a set iron rod; thence N 0°09'32" W along the west line of said Block 23, 83.30 feet to the point of beginning. Said parcel contains 55.4 square feet of land more or less.

PREPARED FROM THIS SURVEY

SCALE 1" = 20 FEET

BEARINGS ARE BASED ON A PREVIOUS SURVEY OF RECORD PREPARED BY PETER S. GORDON, DATED 2/13/96 AND ASSUMES THE EAST LINE OF BLOCK 24 TO BEAR N 0°09'32"W.

legal description

East Half (E1/2) of Lot One (1), Block Twenty-four (24) of the Original Plat of the Village, now city, of Elkhorn, except the South Thirty-Eight (38) feet thereof.

Vol. 159 P. 505 Doc. # 319126

BLOCK 24

ORIGINAL PLAT

LINCOLN AVE. 66' WIDE

STREET 100' WIDE

NORTHWEST CORNER BLOCK 23 ROCKWELL'S ADD.

SCALE

LOT 3

BLOCK 23
ROCKWELL'S ADDITION

LOT 1

LOT 4

Legend

- FOUND IRON PIPE
- FOUND IRON ROD
- FOUND BRASS-CAPPED MONUMENT
- FOUND CONCRETE MONUMENT
- CHISEL CUT IN CONCRETE
- SET IRON ROD, 24" LONG, WEIGHING 1.5 LBS./LINEAL FT., 3/4" DIA.
- SET IRON ROD, 30" LONG, WEIGHING 4.5 LBS./LINEAL FT., 1-11/16" DIA.
- RECORDED AS DIMENSION
- EXISTING FENCE

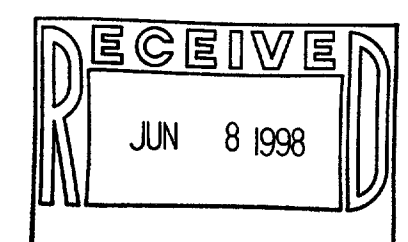

SCALE: 1" = 20 FEET

I hereby certify that the above described property has been surveyed by me or under my direction and that the above map is a true representation thereof and shows the size and location of the property, its exterior boundaries, the location of all visible structures and dimensions of all principal buildings thereon, boundary fences, apparent easements, roadways and visible encroachments, if any.

This survey is made for the use of the present owners of the property and also those who purchase, mortgage, or guarantee the same thereto within one year from date hereof.

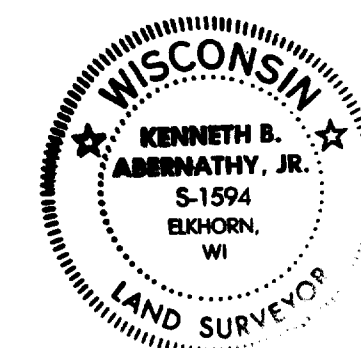

KENNETH B. ABERNATHY, JR.
WISCONSIN REGISTERED LAND SURVEYOR,
S-1594
Date: APRIL 15 1998 Job No. 98.314

YRW-24
YRW-179
004-1111