

PROPOSED LOT EAST TROY INDUSTRIAL PARK

PREPARED FOR: MOONEY LE SAGE GROUP

LEGAL DESCRIPTION:

THAT PART OF LOT 2 CERTIFIED SURVEY MAP #2807 BEING A REDIVISION OF LOT 4, LOT 5, AND OUTLOT 1 OF EAST TROY INDUSTRIAL PARK AND LANDS, LOCATED IN THE SE 1/4 OF THE NW 1/4, SW 1/4 OF THE NE 1/4, AND THE NE 1/4 OF THE SW 1/4 OF SECTION 29, TOWN 4 NORTH, RANGE 18 EAST, VILLAGE OF EAST TROY, WALWORTH COUNTY, WISCONSIN WHICH IS BOUNDED AND DESCRIBED AS FOLLOWS: COMMENCING AT THE SOUTHWEST CORNER OF LOT 2; THENCE NORTH 20°37'00" EAST, 338.48 FEET TO A POINT; THENCE SOUTH 56°24'00" EAST, 585.77 FEET TO A POINT; THENCE SOUTH 58°22'00" EAST, 135.64 FEET TO A POINT; THENCE SOUTH 45°31'00" WEST, 379.33 FEET TO A POINT; THENCE NORTHWESTERLY 81.43 FEET ALONG THE ARC OF CURVE (SAID ARC BEING THE NORTHERLY RIGHT OF WAY LINE OF BUELL DRIVE) WHOSE CENTER LIES TO THE SOUTHWEST, WHOSE RADIUS IS 75.00 FEET AND WHOSE CHORD BEARS NORTH 75°35'18" WEST, 77.49 FEET TO A POINT; THENCE NORTH 42°47'50" WEST, ALONG THE NORTHERLY LINE OF BUELL DRIVE, 242.64 FEET TO A POINT; THENCE NORTHWESTERLY 260.04 FEET ALONG THE ARC OF A CURVE, WHOSE CENTER LIES TO THE SOUTHWEST, WHOSE RADIUS IS 597.15 FEET; AND WHOSE CHORD BEARS NORTH 55°16'21" WEST, 257.99 FEET TO THE POINT OF BEGINNING. THE ABOVE DESCRIBED PARCEL CONTAINS 5.1 ACRES OF LAND.

$\Delta = 24^{\circ}57'02''$
R = 597.15'
T = 132.11'
L = 260.04'
N55°16'21"W
257.99'

$\Delta = 62^{\circ}12'36''$
R = 75.00'
T = 45.25'
L = 81.43'
N75°35'18"W
77.49'

SCALE N 1" = 40'

GRAPHIC SCALE
40 20 0 40

ELEVATIONS ARE REFERENCED TO USGS MEAN SEA LEVEL DATUM

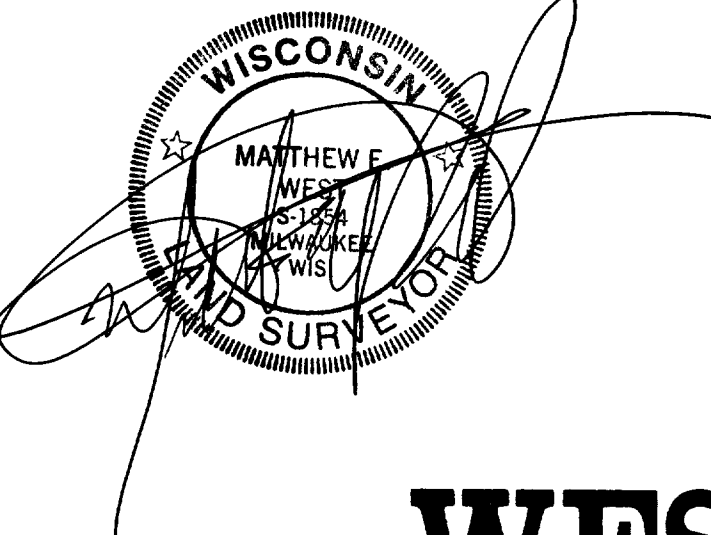

WEST
& Associates Inc.

119 SOUTH SECOND STREET
WATERFORD, WI. 53185
TEL. 414-534-5698
FAX. 414-534-6278

• SURVEYORS
• PLANNERS
• ENGINEERS

PROJECT: #97124

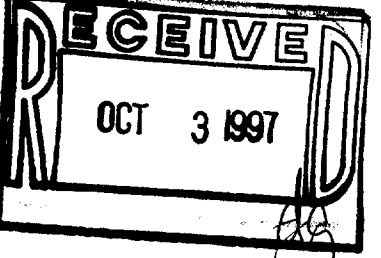

RA-2807-2
003-522