

ABERNATHY and ASSOCIATES

Kenneth B. Abernathy Jr.

Wisconsin Registered Land Surveyor S-1594

Rt. 3, Box 273  
Elkhorn, Wisconsin 53121  
Phone: (414) 723-4260 (office)  
(414) 723-7209 (FAX)

PLAT OF SURVEY

LOT 63 OF THE FOURTH ADDITION TO  
GLENN VIEW ESTATES SUBDIVISION,  
LOCATED IN SECTION 20, TOWN 4  
NORTH, RANGE 18 EAST, VILLAGE OF  
EAST TROY, WALWORTH COUNTY,  
WISCONSIN.

ORDERED BY: BROOKSTONE HOMES  
SUITE 206  
4450 MILTON AVE.  
JANESVILLE, WI. 53546

NOTE:

WOOD STAKES HAVE BEEN PLACED AT BUILDING CORNERS. BUILDER  
IS TO VERIFY DIMENSIONS WHICH HAVE BEEN ROUNDED TO THE  
NEAREST TENTH OF A FOOT TO INSURE PROPER PLAN  
INTERPRETATION AND CONTACT THIS OFFICE IMMEDIATELY IF ANY  
DISCREPANCY EXISTS.

PRAIRIE CT.

N 89°57'44"E 9.61'

C1

CURVE	ARC	DELTA	RADIUS	CHORD LENGTH	CHORD BEARING
C1	71.19	67°59'05"	60.00	67.09	S 67°23'59" E

10.1' 14.7' 12.7' 19.3' 20' 20' 4' 23.3' 48' 9.9'

PROPOSED RESIDENCE

LOT 62

LOT 64

LOT 63

33301 S.F.

DRAINAGE AND UTILITY  
EASEMENT

THIRD ADDITION TO  
GLENN VIEW ESTATES

PLATTED NORTH

SCALE 1" = 30 FEET

Legend

- FOUND IRON PIPE
- FOUND IRON ROD
- FOUND BRASS CAPPED MONUMENT
- FOUND CONCRETE MONUMENT
- CHISEL CUT IN CONCRETE
- SET IRON ROD, 24" LONG, WEIGHING  
1.5 LBS., LINEAL FT., 3/8" DIA.
- SET IRON ROD, 30" LONG, WEIGHING  
4.5 LBS., LINEAL FT., 1-11/16" DIA.
- (XX) RECORDED AS DIMENSION
- EXISTING FENCE

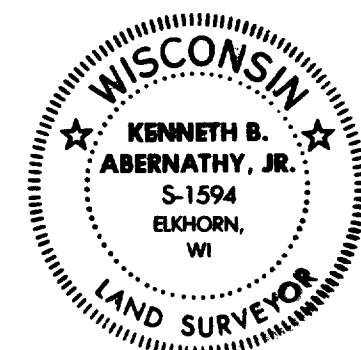

SCALE: 1" = 30 FEET

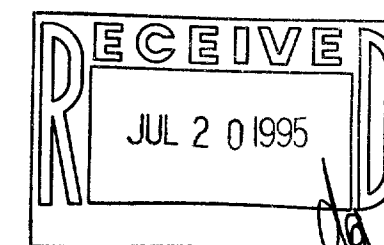

"I hereby certify that the above described property has been surveyed  
by me or under my direction and that the above map is a true  
representation thereof and shows the size and location of the property, its  
exterior boundaries, the location of all visible structures and dimensions of  
all principal buildings thereon, boundary fences, apparent easements,  
roadways and visible encroachments, if any."

"This survey is made for the use of the present owners of the property  
and also those who purchase, mortgage, or guarantee the title thereto within  
one year from date hereof."

Kenneth B. Abernathy, Jr.  
KENNETH B. ABERNATHY, JR.  
WISCONSIN REGISTERED LAND SURVEYOR,  
S-1594

Date: 6-21-95 Job No. 95-610