

Plat of Survey

Known as Emery Street, in the Village of East Troy, Wisconsin
Lot 19 in TROYJEN'S SUBDIVISION, being a Subdivision of a part of the S W 1/4 of Section 19,
T 4 N, R 18 E, in the Village of East Troy, Walworth County, Wisconsin

MARCH 15, 1978

SURVEY NO. 142123-M

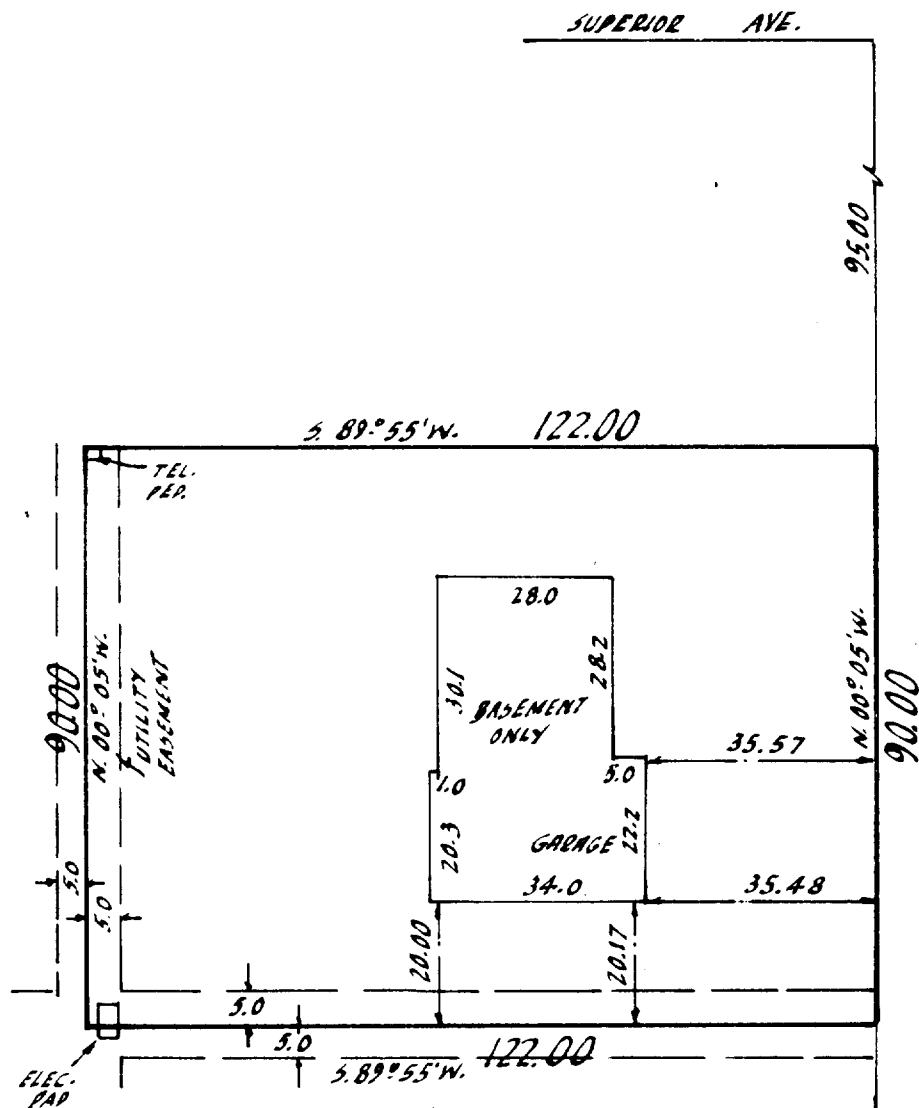

66A.

57.

1347

SCALE: 1"=30'

I Certify that I have surveyed the above described property (Property), and the above map is a true representation thereof and shows the size and location of the Property, its exterior boundaries, the location and dimensions of all visible structures thereon, boundary fences, apparent easements and roadways and visible encroachments, if any.

This survey is made for the exclusive use of the present owners of the Property, and also those who purchase, mortgage, or guarantee the title thereto, within one (1) year from date hereof.

Kenneth E Burke
SURVEYOR



3-174