

**PLAT OF SURVEY  
-OF-**

LOTS 12, 13, AND 14 OF BLOCK A OF  
LENCK'S PARK ADDITION, LOCATED IN  
THE NORTHEAST 1/4 OF SECTION 30,  
AND THE SOUTHEAST 1/4 OF SECTION  
19, TOWN 4 NORTH, RANGE 18 EAST,  
VILLAGE OF EAST TROY, WALWORTH  
COUNTY, WISCONSIN.

SURVEY FOR: HACKBARTH BUILDERS  
SURVEY ADDRESSES: 2111 LENCK  
AVENUE, 3076 & 3082 MAIN STREET

SCALE:  
1" = 30'

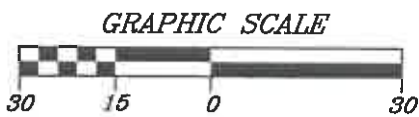

**LEGEND**

- LAMP POST
- UTILITY POLE
- RECORDED AS
- FOUND IRON ROD
- FOUND IRON PIPE
- SET P.K. NAIL
- SET CHISEL CUT

REFER TO A CURRENT TITLE REPORT FOR EASEMENTS AND  
RESTRICTIONS WHICH MAY AFFECT THE USE OF THIS SITE.

BEARINGS HEREON RELATE TO THE NORTH LINE OF MAIN  
STREET; ASSUMED BEARING SOUTH 81°00'00" WEST.

"I hereby certify that I have surveyed the above described  
property and that the above map is a correct representation thereof  
and shows the size and location of the property, its exterior  
boundaries, the location of all visible structures and dimensions  
of all principal buildings thereon, boundary fences, apparent  
easements, roadways and encroachments, if any."

"This survey is made for the use of the present owners of the  
property, and those who purchase, mortgage, or guarantee the  
title thereto within one year from date hereof."

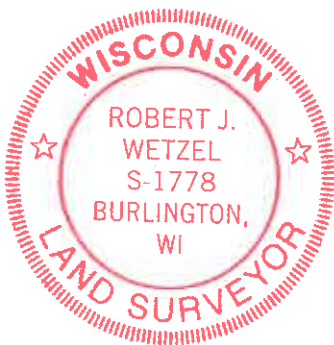

THIS IS NOT AN ORIGINAL PRINT  
UNLESS THIS SEAL IS RED.



**B.W. SURVEYING, INC.**

LAND SURVEYS  
MAPPING AND PLANNING  
412 N. PINE STREET  
BURLINGTON, WI 53105  
(262)-767-0225

*Robert J. Wetzel*  
ROBERT J. WETZEL S-1778

JUNE 22, 2022  
DATE

10681  
JOB NUMBER

PLAT OF SURVEY  
-OF-

PART OF THE WEST 1/2 OF THE SOUTHWEST 1/4 OF SECTION 12, TOWN 2 NORTH, RANGE 18 EAST OF THE FOURTH PRINCIPAL MERIDIAN, TOWNSHIP OF LYONS, COUNTY OF WALWORTH, STATE OF WISCONSIN AND MORE PARTICULARLY DESCRIBED AS FOLLOWS: BEGIN AT THE SOUTHWEST CORNER OF SAID SECTION 12; RUN THENCE NORTH ON THE WEST LINE OF THE SOUTHWEST 1/4 OF SECTION 12, 504.95 FEET TO A POINT AND THE PLACE OF BEGINNING OF PARCEL OF LAND HEREINAFTER DESCRIBED; THENCE CONTINUE NORTH ON THE WEST LINE OF THE SOUTHWEST 1/4 OF SECTION 12, 132.00 FEET; THENCE EAST 165.00 FEET; THENCE SOUTH PARALLEL WITH THE WEST LINE OF THE SOUTHWEST 1/4 OF SECTION 12, 132.00 FEET; THENCE WEST 165.00 FEET TO THE PLACE OF BEGINNING. SAID LAND BEING IN THE TOWN OF LYONS, COUNTY OF WALWORTH, STATE OF WISCONSIN.

SURVEY FOR: BEAR REALTY  
SURVEY ADDRESS: 1755 KNOB ROAD

NOTE: BEARINGS HEREON RELATE TO THE WEST LINE OF THE SOUTHWEST 1/4 SECTION 12-2-18. ASSUMED BEARING NORTH.

NOTE: T-POSTS ALONG PARTS OF NORTH AND SOUTH LINES NOT SHOWN.

LEGEND

- FOUND CONCRETE MONUMENT WITH BRASS CAP
- FOUND IRON PIPE

"I hereby certify that I have surveyed the above described property and that the above map is a correct representation thereof and shows the size and location of the property, its exterior boundaries, the location of all visible structures and dimensions of all principal buildings thereon, boundary fences, apparent easements, roadways and encroachments, if any."

"This survey is made for the use of the present owners of the property, and those who purchase, mortgage, or guarantee the title thereto within one year from date hereof."

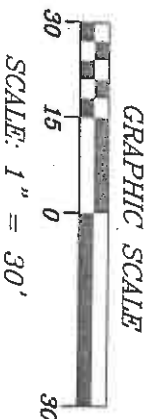

B.W. SURVEYING, INC.

LAND SURVEYS  
MAPPING AND PLANNING  
412 N. PINE STREET  
BURLINGTON, WI 53105  
(262)-767-0225

SOUTHWEST CORNER  
SECTION 12-2-18



THIS IS NOT AN ORIGINAL PRINT  
UNLESS THIS SEAL IS RED.

ROBERT J. WETZEL S-1778

NOVEMBER 11, 2021

DATE

JOB NUMBER

