

Plat of Survey

of

Lot 1 of Certified Survey Map No. 4023,

recorded January 17, 2007 in Vol. 25 of Certified Survey Maps of Walworth County on Page 52 as Document Number 698580 and located in the Southeast 1/4 of the Northwest 1/4 of Section 17, Town 2 North, Range 16 East, City of Delavan, Walworth County, Wisconsin.

Surveyed for: **Lyle Smale**
927 Ann Street
Delavan, Wisconsin. 53115

Survey Date: June 10, 2024.
Revisions:



45 South Wisconsin Street | P.O. Box 322
Elkhorn, Wisconsin. 53121
Telephone: (262) 723-3434
Facsimile: (262) 723-8044
Email: doug@olsonsurveying.com
Website: www.olsonsurveying.com

OLSON
LAND SURVEYING, LLC
Rural | Residential | Commercial

Legend of Symbols & Abbreviations
Found Concrete Monument
Found Iron Pipe
Found Iron Rod
Found Sash Weight
Recorded Information
Utility Pole
Asphalt Surface
Gravel Surface
Concrete Surface
Brick Pavers
North
South
East
West
In Bearings
In Degrees
In Feet
In Distances
In Acres

Sheet 1 of 1 Sheets
Drawing Name:
Job Reference Number
2024.045
2024.045

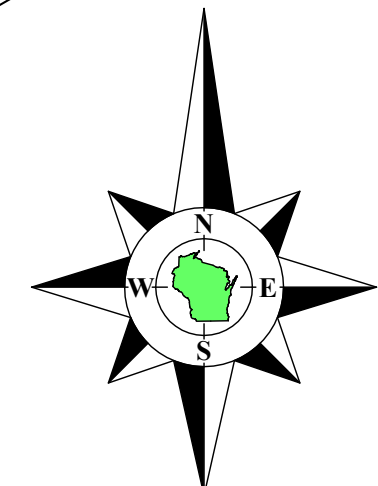

Bearings referenced to the Southwesterly line of Lot 1 of Certified Survey Map No. 4023, recorded as N34°42'40"W. Said Certified Survey Map recorded as being referenced to the Wisconsin State Plane Coordinate System, South Zone, (NAD-27).

Copyright ©2024 by Olson Land Surveying, LLC.

All rights reserved. No part of this survey plat may be reproduced or transmitted in any form by any means - graphic, electronic, or mechanical, including photocopying, tracing, or information storage and retrieval systems - without permission in writing from Douglas G. Olson, Olson Land Surveying, LLC.

I hereby certify that I have surveyed the above described property in compliance with Chapter A-E 7 of the Wisconsin Administrative Code and that the map hereon is correct to the best of my professional knowledge and belief and shows the size and location of the property, its exterior boundaries, the location and dimensions of all visible structures thereon, boundary fences, apparent easements and roadways and visible encroachments, if any.

This survey is made for the exclusive use of the present owners of the property, and also those who purchase, mortgage or guarantee title thereto, within one year from the date hereof.

Douglas G. Olson
Wisconsin Professional Land Surveyor - 2093

Notes:

- This Plat of Survey is not certified unless signed and sealed in red ink.
- This survey is subject to Wisconsin lien laws. This Plat of Survey is the notice of intent to file lien. Lien waiver required.
- The Survey Date shown on this Plat of Survey is the completion date of the field work.

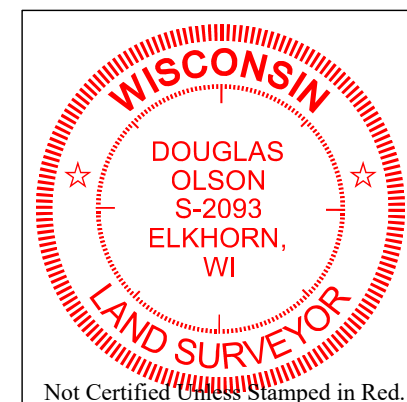

Not Certified Unless Stamped in Red.

